

Excellent Integrated System Limited

Stocking Distributor

Click to view price, real time Inventory, Delivery & Lifecycle Information:

[Amphenol RF](#)
[112653](#)

For any questions, you can email us directly:

sales@integrated-circuit.com

| REV. | DATE | DESCRIPTION |
|------|----------|-----------------------|
| NC | 03/28/00 | INITIAL RELEASE |
| A | 01/02/07 | UPDATE DRAWING FORMAT |

NOTE:

FLARE INTERNAL FLANGE TO $\varnothing 8.3[.326] \pm 0.07$

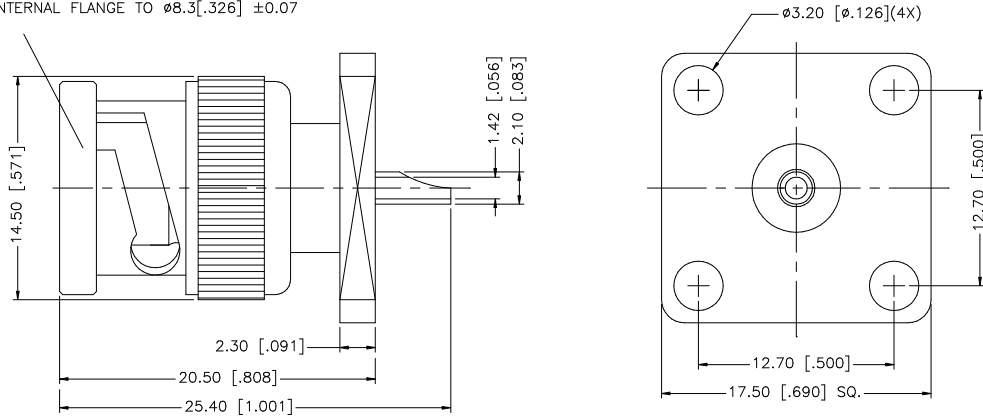

| | | | | UNLESS OTHERWISE SPECIFIED DIMENSIONS ARE IN MILLIMETERS; DIMENSIONS IN [] ARE IN INCHES AND FOR CUSTOMER REFERENCE ONLY. | APPROVALS | DATE | Amphenol Connex | | | | |
|---|-------------|----------|---------|--|----------------------|-------------------|------------------------|---|----------|--|--|
| 8 | | | | UNLESS OTHERWISE SPECIFIED TOLERANCES FOR MILLIMETERS ARE: 0.5 - 8mm ± 0.20mm 8 - 30mm ± 0.40mm 30 - 120mm ± 0.50mm UNLESS OTHERWISE SPECIFIED TOLERANCES FOR INCHES ARE: .020 - .315 = ± 0.007" .315 - 1.180 = ± 0.015" 1.180 - 4.724 = ± 0.020" | DRAWN | C.R.S. | 01/02/07 | PART DESCRIPTION BNC PANEL PLUG - 4 HOLE FLANGE | | | |
| 7 | | | | | CHECKED | | | | | | |
| 6 | | | | | ISSUED | | | PART NO. 112653 | | | |
| 5 | | | | | | SHEET | 1 OF 1 | DWG. NO. 112653.DWG | | | |
| 4 | | | | | CAD FILE | C:/112/112653.DWG | REV. A | SIZE A | SCALE NA | | |
| 3 | CONTACT PIN | BRASS | GOLD | 1 | | | | | | | |
| 2 | INSULATOR | TEFLON | NATURAL | 1 | | | | | | | |
| 1 | BODY | BRASS | NICKEL | 1 | | | | | | | |
| | DESCRIPTION | MATERIAL | FINISH | QTY | DO NOT SCALE DRAWING | | | | | | |