

Excellent Integrated System Limited

Stocking Distributor

Click to view price, real time Inventory, Delivery & Lifecycle Information:

[Molex Connector Corporation](#)
[0015910400](#)

For any questions, you can email us directly:

sales@integrated-circuit.com

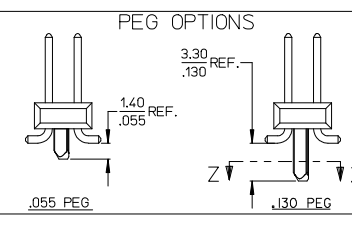
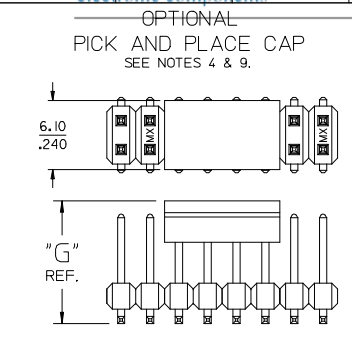

- NOTES:**
- MATERIALS: INSULATOR: GLASS FILLED LIQUID CRYSTAL POLYMER (LCP), UL94 V-0, COLOR: BLACK
TERMINAL: COPPER ALLOY
 - FINISH:
59 TIN - 0.00150/0.00059 MIN. BRIGHT TIN OVER NICKEL OVERALL.
150 TIN - 0.00381/0.00150 MIN. BRIGHT TIN OVER NICKEL OVERALL.
REFLOWED MATTE TIN - 0.00152/0.00060 MIN. REFLOWED MATTE TIN OVER NICKEL OVERALL.
15 GOLD - 0.00038/0.00015 MIN. GOLD IN SELECT AREA OVER 0.00191/0.00075 MIN. TIN IN SELECT AREA OVER NICKEL OVERALL.
30 GOLD - 0.00076/0.00030 MIN. GOLD IN SELECT AREA OVER 0.00191/0.00075 MIN. TIN IN SELECT AREA OVER NICKEL OVERALL.
50 GOLD - 0.00127/0.00050 MIN. GOLD IN SELECT AREA OVER 0.00254/0.00100 MIN. TIN IN SELECT AREA OVER NICKEL OVERALL.
 - PART TO CONFORM TO PS-71308.
 - PACKAGING (SEE CHARTS): BULK: PER PK-70873-0353
TUBES: PER PK-70873-0041.
71308-82** IN TUBES: PER PK-70873-042.
TUBES W/ VAC CAPS: PER PK-70873-0691
TAPE AND REEL W/ VAC CAPS: PER PK-70873-0805.
SEE SHEET 3 FOR TAPE & REEL PRODUCT WITH SHALLOW POCKET REQUIREMENTS.
 - TYP. DIMENSIONS FOR LANDS SURROUNDING HOLES FOR RETENTION PEGS.
 - PIN SOLERABILITY PER MOLEX SPEC. SMES-152.
 - SEE SHEETS 2-6 FOR CHARTED DIMS., PART/EDP NO'S, AND VOIDED CIRCUITS.
 - PIN PUSHOUT FORCE: 3 LBS. MINIMUM.
 - PICK-N-PLACE CAPS WILL BE PLACED SO THAT VACUUM PICK UP AREA WILL BE IN CENTER OF PART.
 - COPLANARITY FOR CIRCUIT SIZES UP TO 40 IS 0.15 MM/0.06 INCH. FOR CIRCUIT SIZES 42 AND LARGER, CONTACT MOLEX SALES DEPARTMENT.
 - THIS PART CONFORMS TO CLASS B REQUIREMENTS OF COSMETIC SPECIFICATION PS-45499-002.
 - MEASURE POINT FOR PLATING THICKNESS.

DIM. "M"	DIM. "G"
6.10 .240	10.67 .420
8.13 .320	12.70 .500

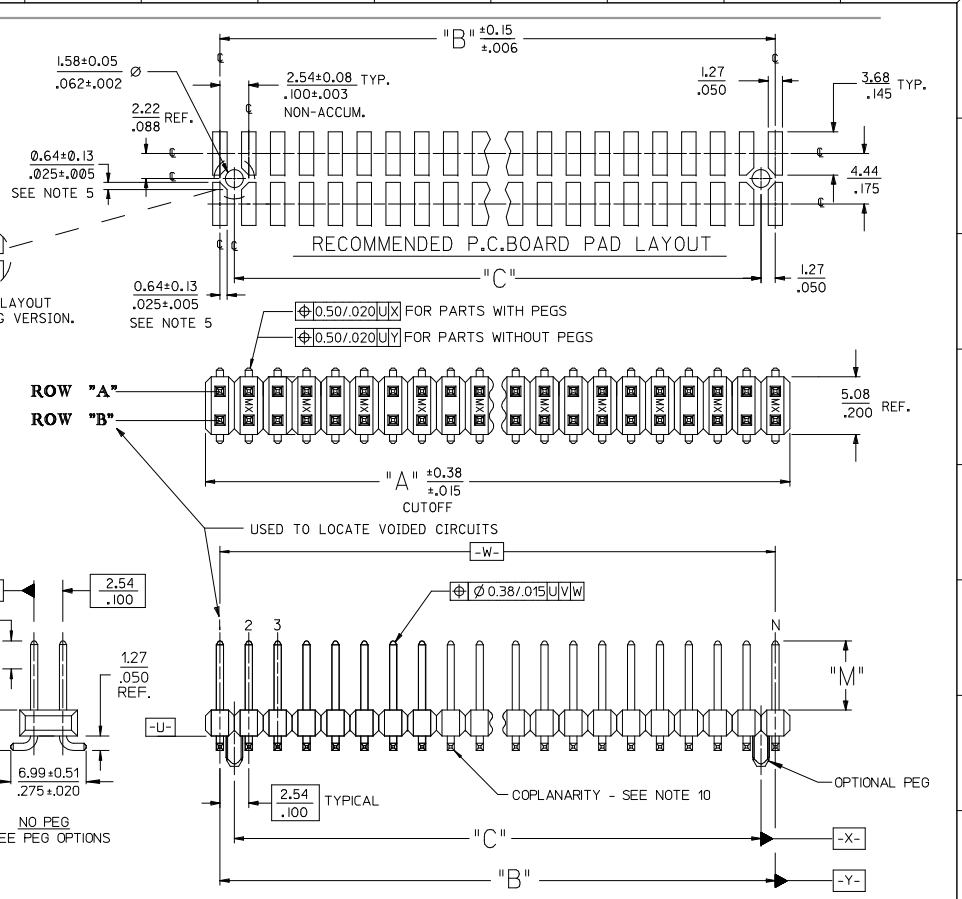
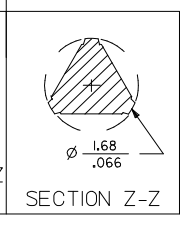
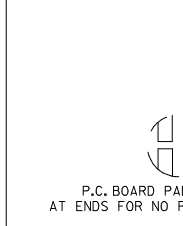

REV	DESCRIPTION
1	71308-8426 PLATING
2	EC NO: UCP2014-4901
3	DRW/KJPPER 2/15/08/12
4	CHK/KONGUTEN 2/15/08/12
5	APPROV/STH 2/15/09/10

QUALITY SYMBOLS	GENERAL TOLERANCES (UNLESS SPECIFIED)
▽=0	4 PLACES ± .005
▽=0.05	3 PLACES ± .005
▽=0.10	2 PLACES ± 0.13 ± .010
▽=0.25	1 PLACE ± 0.25 ± .010
▽=0.50	0 PLACE ± .010
	ANGULAR ± 1/2°

DIMENSION STYLE	SCALE	DESIGN UNITS	THIRD ANGLE PROJECTION
MM/IN	INCH	INCH	THIRD ANGLE PROJECTION

DRAWN BY	DATE	TITLE	DOCUMENT NO.	SHEET NO.
KMS	1999/10/15	SALES ASSY INSULATOR DUAL ROW SMT W/BREAK-OFF .025SQ PIN GULLWING .100	SD-71308-001	1 OF 6

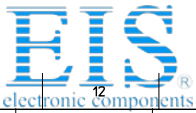

Distributor of Molex Connector Corporation: Excellent Integrated System Limited

Datasheet of 0015910400 - CONN HEADER 40POS GOLD SMD

Contact us: sales@integrated-circuit.com Website: www.integrated-circuit.com

Main table with columns for DIM. A, DIM. B, EDP NUMBER, and various connector specifications. Includes rows for DIM. M, PLATING, and DIM. H.

Technical drawing area containing: NO PEG VERSION (SEE ALSO SHEET 3), QUALITY SYMBOLS, GENERAL TOLERANCES (UNLESS SPECIFIED), DIMENSION STYLE MM/IN, SCALE, DESIGN UNITS INCH, THIRD ANGLE PROJECTION, SALES ASSY INSULATOR DUAL ROW SMT W/BREAK-OFF .025SQ PIN GULL WING .100, molex logo, MATERIAL NO., DOCUMENT NO., SHEET NO., DRAFT WHERE APPLICABLE MUST REMAIN WITHIN DIMENSIONS, SEE TABLE, SD-71308-001, 2 OF 6.



IN TAPE AND REEL WITH SHALLOW POCKET TAPE										BULK / IN TUBES			
PACKAGING SEE NOTE 4. SHT 1		4-8 CKT	TAPE-N-REEL W/ VAC CAPS		TAPE-N-REEL W/ VAC CAPS		TAPE-N-REEL W/ VAC CAPS		TAPE-N-REEL W/ VAC CAPS		BULK	BULK	
		10-100 CKT	TAPE-N-REEL W/ VAC CAPS		TAPE-N-REEL W/ VAC CAPS		TAPE-N-REEL W/ VAC CAPS		TAPE-N-REEL W/ VAC CAPS		TUBES	TUBES	
DIM. M±0.25 MM			6.10 (.240)		6.10 (.240)		6.10 (.240)		6.10 (.240)		8.13 (.320)	13.59 (.535)	
PLATING			30 GOLD		15 GOLD		15 GOLD		15 GOLD		150 TIN	150 TIN	
DIM. H			2.54 (.100)		2.54 (.100)		2.54 (.100)		2.54 (.100)		4.57 (.180)	4.57 (.180)	
CKTS	DIM. A		DIM. B		EDP NUMBER	EDP NUMBER	EDP NUMBER	EDP NUMBER	CKTS				
	MM	IN	MM	IN									
04	5.08	.200	2.54	.100					04				
06	7.62	.300	5.08	.200		015-91-6068			06				
08	10.16	.400	7.62	.300		015-91-6088			08				
10	12.70	.500	10.16	.400		015-91-6108		713088010	10				
12	15.24	.600	12.70	.500					12				
14	17.78	.700	15.24	.600	015-91-6148				14				
16	20.32	.800	17.78	.700				713088016	16				
18	22.86	.900	20.32	.800					18				
20	25.40	1.000	22.86	.900					20				
22	27.94	1.100	25.40	1.000					22				
24	30.48	1.200	27.94	1.100					24				
26	33.02	1.300	30.48	1.200					26				
28	35.56	1.400	33.02	1.300					28				
30	38.10	1.500	35.56	1.400					30				
32	40.64	1.600	38.10	1.500					32				
34	43.18	1.700	40.64	1.600					34				
36	45.72	1.800	43.18	1.700					36				
38	48.26	1.900	45.72	1.800					38				
40	50.80	2.000	48.26	1.900					40				
42	53.34	2.100	50.80	2.000					42				
44	55.88	2.200	53.34	2.100					44				
46	58.42	2.300	55.88	2.200					46				
48	60.96	2.400	58.42	2.300					48				
50	63.50	2.500	60.96	2.400					50				
52	66.04	2.600	63.50	2.500					52				
54	68.58	2.700	66.04	2.600					54				
56	71.12	2.800	68.58	2.700					56				
58	73.66	2.900	71.12	2.800					58				
60	76.20	3.000	73.66	2.900					60				
62	78.74	3.100	76.20	3.000					62				
64	81.28	3.200	78.74	3.100					64				
66	83.82	3.300	81.28	3.200					66				
68	86.36	3.400	83.82	3.300					68				
70	88.90	3.500	86.36	3.400					70				
72	91.44	3.600	88.90	3.500					72				
74	93.98	3.700	91.44	3.600					74				
76	96.52	3.800	93.98	3.700					76				
78	99.06	3.900	96.52	3.800					78				
80	101.60	4.000	99.06	3.900					80				
82	104.14	4.100	101.60	4.000					82				
84	106.68	4.200	104.14	4.100					84				
86	109.22	4.300	106.68	4.200					86				
88	111.76	4.400	109.22	4.300					88				
90	114.30	4.500	111.76	4.400					90				
92	116.84	4.600	114.30	4.500					92				
94	119.38	4.700	116.84	4.600					94				
96	121.92	4.800	119.38	4.700					96				
98	124.46	4.900	121.92	4.800					98				
100	127.00	5.000	124.46	4.900					100				

NO PEG VERSION
(ALSO SEE SHEET 2)

SEE SHEET 1 EC NO: UCP2014-4901 DRAWN BY: 2015/08/12 CHKD: 2015/08/12 APPROV: 2015/09/10	QUALITY SYMBOLS ∇=0 ∇=0 ∇=0	GENERAL TOLERANCES (UNLESS SPECIFIED)		DIMENSION STYLE		SCALE	DESIGN UNITS	THIRD ANGLE PROJECTION
		mm	INCH	MM/IN	DATE	SALES ASSY INSULATOR DUAL ROW SMT W/BREAK-OFF .025SQ PIN GULLWING .100 molex	INCH	
		4 PLACES ±---	±---	DRAWN BY	DATE			
		3 PLACES ±---	±.005	CHECKED BY	DATE			
2 PLACES ±0.13	±.010	APPROVED BY	DATE					
1 PLACE ±0.25	±---	KMS	1999/10/15	MATERIAL NO.	DOCUMENT NO.	SHEET NO.		
0 PLACE ±---	±---	ANGULAR ±1/2°		SEE TABLE	SD-71308-001	3 OF 6		
DRAFT WHERE APPLICABLE MUST REMAIN WITHIN DIMENSIONS				THIS DRAWING CONTAINS INFORMATION THAT IS PROPRIETARY TO MOLEX INCORPORATED AND SHOULD NOT BE USED WITHOUT WRITTEN PERMISSION				

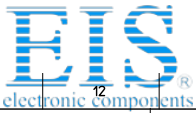

Distributor of Molex Connector Corporation: Excellent Integrated System Limited

Datasheet of 0015910400 - CONN HEADER 40POS GOLD SMD

Contact us: sales@integrated-circuit.com Website: www.integrated-circuit.com

Main table with columns for DIM. A, DIM. B, DIM. C, EDP NUMBER, and various connector specifications. Includes rows for packaging (4-8 CKT, BULK, TUBES) and dimensions (DIM. M, PLATING, DIM. H).

Technical drawing area containing: SEE SHEET 1, QUALITY SYMBOLS, GENERAL TOLERANCES (UNLESS SPECIFIED), DIMENSION STYLE (MM/IN), SCALE, DESIGN UNITS (INCH), THIRD ANGLE PROJECTION, SALES ASSY INSULATOR DUAL ROW SMT W/BREAK-OFF .025SQ PIN GULLWING .100, molex logo, MATERIAL NO., DOCUMENT NO., DRAFT WHERE APPLICABLE MUST REMAIN WITHIN DIMENSIONS, SEE TABLE, SD-71308-001, SHEET NO. 4 OF 6.

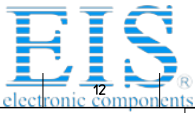

PEG-OPTION

Table with columns for NO PEG VERSION, LONG PEG VERSION (130'), and SHORT PEG VERSION (.055'). Includes sub-headers for PACKAGING, DIMENSIONS, and CKTS.

Technical drawing area containing: SEE SHEET 1, DIMENSION STYLE (MM/IN), SCALE, DESIGN UNITS (INCH), THIRD ANGLE PROJECTION, SALES ASSY INSULATOR DUAL ROW SMT W/BREAK-OFF .025SQ PIN GULLWING .100, molex logo, SD-71308-001, and SHEET NO. 6 OF 6.