

Excellent Integrated System Limited

Stocking Distributor

Click to view price, real time Inventory, Delivery & Lifecycle Information:

[Molex Connector Corporation](#)
[0019092042](#)

For any questions, you can email us directly:

sales@integrated-circuit.com

PLUG

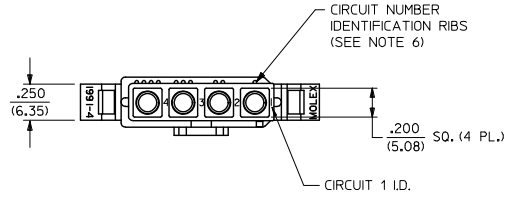

ALTERNATE SQUARE END CONFIGURATION
(FOUND ON STANDARD MOUNTING EAR
VERSION TOOLS BUILT PRIOR TO 1/87.)

DETAIL I

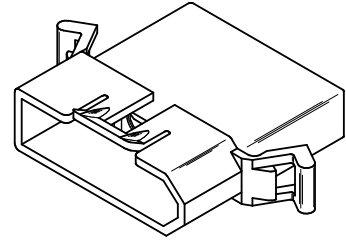
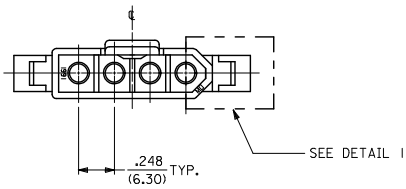
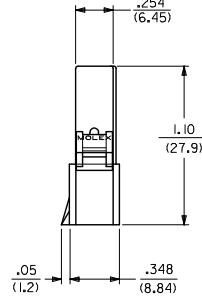
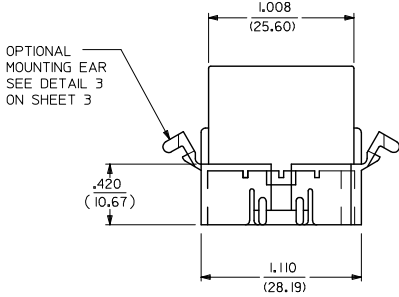

PLUG HOUSING

REMOVE 1991-4R EC NO: UCP2014-3949 DRAWN BY: DRWINKIPPER 2014/03/27 CHECKED BY: CHRISANDERSON 2014/03/27 APPROVED BY: APRILSMITH 2014/06/10 J1 REV	QUALITY SYMBOLS	GENERAL TOLERANCES (UNLESS SPECIFIED)	DIMENSION STYLE	SCALE	DESIGN UNITS	THIRD ANGLE PROJECTION
	∇=0 ∇=0 ∇=0	4 PLACES ± --- ± --- 3 PLACES ± --- ± .010 2 PLACES ± 0.25 ± .014 1 PLACE ± 0.35 ± --- 0 PLACE ± --- ± ---	IN/MM	2:1	INCH	.093/(2.36) HOUSINGS, PLUG AND RECEPTACLE, 4 CKT. .248/(6.30) CTRS.
	DESCRIPTION	ANGULAR ± 1°	SEE CHART	MATERIAL NO.	DOCUMENT NO.	molex SD-1991-4*
		DRAFT WHERE APPLICABLE MUST REMAIN WITHIN DIMENSIONS	SIZE C	THIS DRAWING CONTAINS INFORMATION THAT IS PROPRIETARY TO MOLEX INCORPORATED AND SHOULD NOT BE USED WITHOUT WRITTEN PERMISSION		

RECEPTACLE

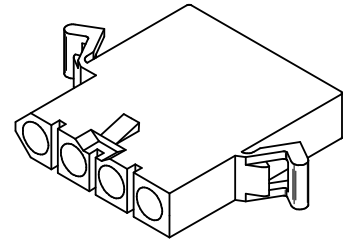
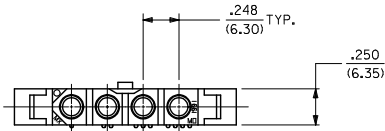
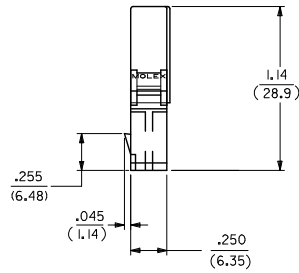
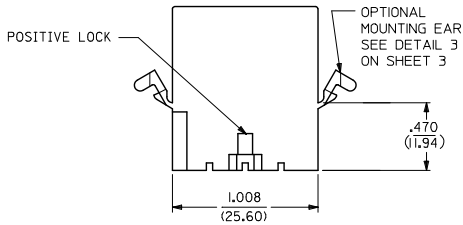
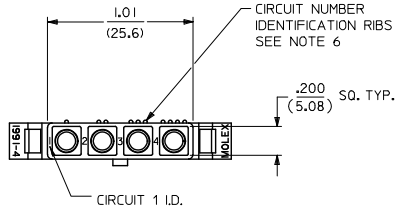

RECEPTACLE HOUSING

SEE SHEET 1 EC NO: UCP2014-3949 DRAWN BY: 2014/03/27 CHKD BY: 2014/03/27 APPROVED BY: 2014/06/10	QUALITY SYMBOLS ∇=0 ∇=0 ∇=0	GENERAL TOLERANCES (UNLESS SPECIFIED)		DIMENSION STYLE IN/MM		SCALE 2:1	DESIGN UNITS INCH	THIRD ANGLE PROJECTION
		4 PLACES ± --- ± --- 3 PLACES ± --- ± .010 2 PLACES ± 0.25 ± .014 1 PLACE ± 0.35 ± --- 0 PLACE ± --- ± ---	DRAWN BY: GEP CHECKED BY: RW APPROVED BY: F SMITH DATE: 1988/03/01 DATE: 1988/03/01 DATE: 2014/06/10	TITLE .093/(2.36) HOUSINGS, PLUG AND RECEPTACLE, 4 CKT, .248/(6.30) CTRS.			MATERIAL NO. SEE CHART	DOCUMENT NO. SD-1991-4*
DRAFT WHERE APPLICABLE MUST REMAIN WITHIN DIMENSIONS		THIS DRAWING CONTAINS INFORMATION THAT IS PROPRIETARY TO MOLEX INCORPORATED AND SHOULD NOT BE USED WITHOUT WRITTEN PERMISSION						

PLUG	
PART NO.	ENG. NO.
I9-09-2042	I991-4P1
I9-09-2043	I991-4P2

RECEPTACLE	
PART NO.	ENG. NO.
I9-09-1042	I991-4R1
I9-09-1043	I991-4R2

LEGEND:

1991-4****
 CIRCUIT SIZE
 P = PLUG
 R = RECEPTACLE
 1 = WITHOUT EARS
 2 = WITH PREBENT EARS, PER DETAIL 3

COLOR: BLANK=NATURAL COLOR

AM=AMBER BK=BLACK BU=BLUE
 BN=BROWN GY=GRAY GN=GREEN
 OR=ORANGE RD=RED YW=YELLOW

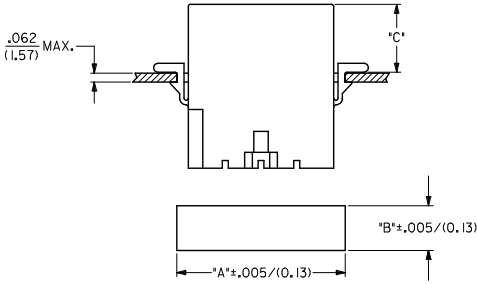

HOUSING	DIM. "A"	DIM. "B"	DIM. "C" STD. EAR	DIM. "C" PREBENT
PLUG	1.270/(32.26)	.365/(9.27)	.48/(12.2)	.52/(13.2)
RECEPTACLE	1.168/(29.67)	.311/(7.90)	.47/(11.9)	.51/(12.9)

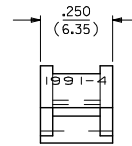

DETAIL 3

PREBENT MOUNTING EAR
 (SCALE 4:1)

NOTES:

1. MATERIAL: NYLON TYPE 6/6, 94V-2.
2. FINISH: N/A
3. PRODUCT SPECIFICATION: PS-02-09
4. PACKAGING SPECIFICATION: PK-1991-001
5. ACCEPTS MOLEX .093/(2.36) SERIES TERMINALS.
6. CIRCUIT IDENTIFICATION RIBS MAY OR MAY NOT BE PRESENT.
7. PARTS CONFORM TO CLASS B REQUIREMENTS OF COSMETIC SPECIFICATION PS-45499-002.

SEE SHEET 1 IEC NO: UCP2014-3949 2014/03/27 DRAWN BY: CHKOBANDERSON 2014/03/27 APPROVED BY: F SMITH 2014/06/10	QUALITY SYMBOLS 	GENERAL TOLERANCES (UNLESS SPECIFIED)		DIMENSION STYLE IN/MM		SCALE 2:1	DESIGN UNITS INCH	THIRD ANGLE PROJECTION	
		4 PLACES	±	---	±	---	DRAWN BY GEP	DATE 1988/03/01	TITLE .093/(2.36) HOUSINGS, PLUG AND RECEPTACLE, 4 CKT, .248/(6.30) CTRS. molex
		3 PLACES	±	---	±	.010	CHECKED BY RW	DATE 1988/03/01	
		2 PLACES	±	0.25	±	.014	APPROVED BY F SMITH	DATE 2014/06/10	
1 PLACE	±	0.35	±	---	MATERIAL NO. SEE CHART	DOCUMENT NO. SD-1991-4*	SHEET NO. 3 OF 3		
DRAFT WHERE APPLICABLE MUST REMAIN WITHIN DIMENSIONS		ANGULAR ± 1 °		THIS DRAWING CONTAINS INFORMATION THAT IS PROPRIETARY TO MOLEX INCORPORATED AND SHOULD NOT BE USED WITHOUT WRITTEN PERMISSION					