

Excellent Integrated System Limited

Stocking Distributor

Click to view price, real time Inventory, Delivery & Lifecycle Information:

[Molex Connector Corporation](#)
[0026603038](#)

For any questions, you can email us directly:

sales@integrated-circuit.com

CKT	DIM. A	DIM. B
2	7.77	3.96±0.05
	.306	.156±.002
3	11.73	7.92±0.08
	.462	.312±.003
4	15.70	11.89±0.08
	.618	.468±.003
5	19.66	15.85±0.10
	.774	.624±.004
6	23.62	19.81±0.10
	.930	.780±.004
7	27.58	23.77±0.10
	1.086	.936±.004
8	31.55	27.74±0.13
	1.242	1.092±.005
9	35.51	31.70±0.13
	1.398	1.248±.005
10	39.47	35.66±0.13
	1.554	1.404±.005
11	43.43	39.62±0.15
	1.710	1.560±.006
12	47.40	43.59±0.15
	1.866	1.716±.006
13	51.36	47.55±0.15
	2.022	1.872±.006
14	55.32	51.51±0.18
	2.178	2.028±.007
15	59.28	55.47±0.18
	2.334	2.184±.007
16	63.25	59.44±0.18
	2.490	2.340±.007
17	67.21	63.40±0.20
	2.646	2.496±.008
18	71.17	67.36±0.20
	2.802	2.652±.008

- NOTES:
 1. MATERIAL: HEADER-GLASS FILLED POLYESTER, 94V-0, MOLDED NATURAL (WHITE).
 2. FINISH:
 (154) OVERALL TIN: 0.00254/.000100 MIN OVER 0.00127/.000050 MIN NICKEL.
 (197) OVERALL REFLOWED MATTE TIN: 0.00152/.000060 MIN.
 OVER 0.00127/.000050 MIN NICKEL OVERALL.
 (208) SELECT GOLD: 0.00038/.000015 MIN, SELECT TIN: 0.00254/.000100 MIN.
 OVERALL NICKEL UNDERPLATE: 0.00127/.000050 MIN.
 (228) SELECT GOLD: 0.00076/.000030 MIN, SELECT TIN: 0.00254/.000100 MIN.
 OVERALL NICKEL UNDERPLATE: 0.00127/.000050 MIN.
 (241) SELECT GOLD: 0.00051/.000020 MIN.
 SELECT TIN: 0.00254/.000100 MIN.
 OVERALL NICKEL UNDERPLATE: 0.00127/.000050 MIN.
 3. PRODUCT SPECIFICATION AND PROCESS PARAMETERS: SEE PS-08-50.
 4. PACKAGING: SEE CHART
 5. SOLDERABILITY: PER SMES-152.
 6. PIN PUSH-OUT FORCE: PRIOR TO SOLDERING, A 3 LB. MINIMUM FORCE (IN EITHER DIRECTION)
 7. PARTS ARE STACKABLE END TO END ON 3.96/.156 CENTERS.
 8. THIS PART CONFORMS TO CLASS B REQUIREMENTS OF COSMETIC SPECIFICATION PS-45499-002.

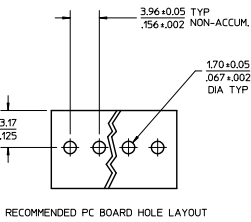
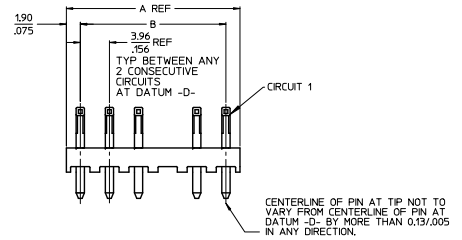
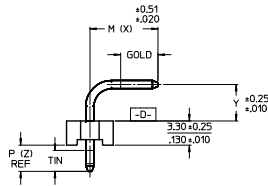
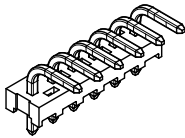
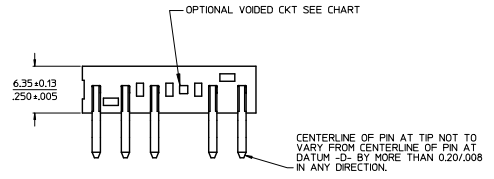

2-*	M1
1	M1
SHEET	REV

ADD 41772-0682	QUALITY SYMBOLS
EC NO: UCP2012-3876	GENERAL TOLERANCES (UNLESS SPECIFIED)
DRAWN/PPR 2012/05/25	mm INCH
CHKD/BELL 2012/05/25	4 PLACES ±.--- ±.---
APPR/SMITH 2012/06/20	3 PLACES ±.--- ±.010
	2 PLACES ±0.25 ±.015
	1 PLACE ±0.38 ±.---
	ANGULAR ±1/2°
	DRAFT WHERE APPLICABLE MUST REMAIN WITHIN DIMENSIONS

DESCRIPTION	SCALE	DESIGN UNITS	THIRD ANGLE PROJECTION
	2:1	INCH	

DRAWN BY	DATE	TITLE
SCHAFFER	11-19-03	KK 156 HEADER ASSEMBLY
CHECKED BY	DATE	FLAT RIGHT ANGLE
SAMIEC	11-21-03	SOLID BODY W/O PEGS
APPROVED BY	DATE	MOLEX INCORPORATED
MARGULIS	11-25-03	
MATERIAL NO.	DOCUMENT NO.	SDA-41772
SEE CHART		1 OF *

SIZE	THIS DRAWING CONTAINS INFORMATION THAT IS PROPRIETARY TO MOLEX INCORPORATED AND SHOULD NOT BE USED WITHOUT WRITTEN PERMISSION	
B		