

Excellent Integrated System Limited

Stocking Distributor

Click to view price, real time Inventory, Delivery & Lifecycle Information:

[Molex Connector Corporation](#)
[0029110103](#)

For any questions, you can email us directly:

sales@integrated-circuit.com

10 9 8 7 6 5 4 3 2 1

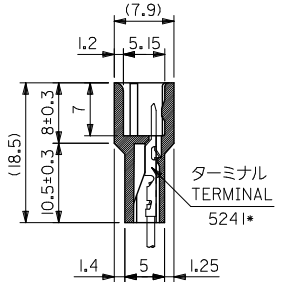
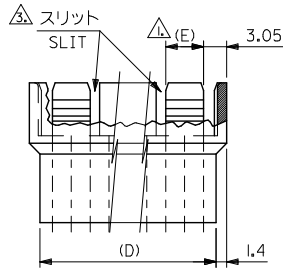
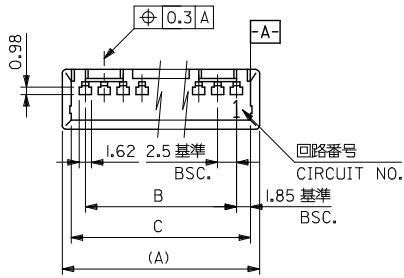

ナイロン66, 94V-0
NYLON66, 94V-0
色: オフホワイト
COLOR: OFF WHITE

注)
NOTE.

△ フリクションロック構成:
FRICTION LOCK CONFIGURATION:
4種までは1箇所
4CKT AND UNDER - 1LOCK
5種以上は2箇所
5CKT AND OVER - 2LOCKS

2. 嵌合相手: 5102-N
MATES WITH HOUSING: 5102-N

△ スリット構成:
SLIT CONFIGURATION:
4種以下はなし
4CKT AND UNDER - NO SLIT
5及び6極は1箇所
5 AND 6CKTS - 1 SLIT
7種以上は2箇所
7CKT AND OVER - 2 SLITS

29-11-0153	5240-151	35	38.7	41.1	5	38.3	15
↑ -0143	↑ -141	32.5	36.2	38.6	5	35.8	14
↑ -0133	↑ -131	30	33.7	36.1	5	33.3	13
↑ -0123	↑ -121	27.5	31.2	33.6	5	30.8	12
↑ -0103	↑ -101	22.5	26.2	28.6	5	25.8	10
↑ -0093	↑ -091	20	23.7	26.1	5	23.3	9
↑ -0083	↑ -081	17.5	21.2	23.6	5	20.8	8
↑ -0073	↑ -071	15	18.7	21.1	5	18.3	7
↑ -0063	↑ -061	12.5	16.2	18.6	5	15.8	6
↑ -0053	↑ -051	10	13.7	16.1	3.75	13.3	5
↑ -0043	↑ -041	7.5	11.2	13.6	7.5	10.8	4
↑ -0033	↑ -031	5	8.7	11.1	5	8.3	3
↓ 29-11-0023	↓ 5240-021	2.5	6.2	8.6	2.5	5.8	2
EDP.NO.	ENG.NO.	B	C	(A)	(E)	(D)	極数 CKT.

REVISED EC NO: J2016-0727 DRWN: SWAKURAO 2016/01/20 CHKD: SASAKAWA 2016/02/12 APPR: KANEKO 2016/02/26	GENERAL TOLERANCES (UNLESS SPECIFIED)			DIMENSION STYLE		SCALE	DESIGN UNITS	THIRD ANGLE PROJECTION
	0.25 UNDER	UNDER	+0.2	MM ONLY		2:1	METRIC	
	0.25 OVER	0.5 UNDER	+0.2	DRAWN BY		DATE		MINI. SPOX PLUG HSG molex SEE CHART DOCUMENT NO. SD-5240-N1 SHEET NO. 1 OF 1
	0.5 OVER	1.0 UNDER	+0.2	CHECKED BY		DATE		
1.0 OVER	10 UNDER	+0.2	TYAMAGUCHI		2000/03/30			
10 OVER	30 UNDER	+0.25	APPROVED BY		DATE			
30 OVER		+0.3	MATERIAL NO.		DOCUMENT NO.			
ANGULAR	± 3 °		SEE CHART					
DRAFT WHERE APPLICABLE MUST REMAIN WITHIN DIMENSIONS			SIZE	THIS DRAWING CONTAINS INFORMATION THAT IS PROPRIETARY TO MOLEX ELECTRONIC TECHNOLOGIES, LLC AND SHOULD NOT BE USED WITHOUT WRITTEN PERMISSION				

9 8 7 6 5 4 3 2 1