

Excellent Integrated System Limited

Stocking Distributor

Click to view price, real time Inventory, Delivery & Lifecycle Information:

[Molex Connector Corporation](#)
[0029110123](#)

For any questions, you can email us directly:

sales@integrated-circuit.com

10 9 8 7 6 5 4 3 2 1

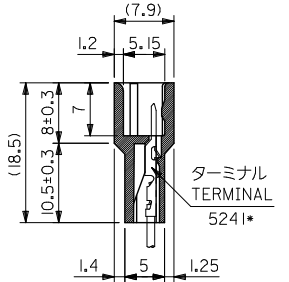
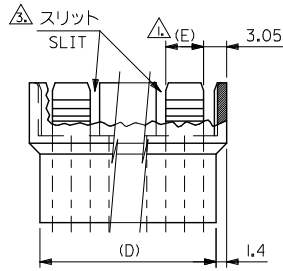
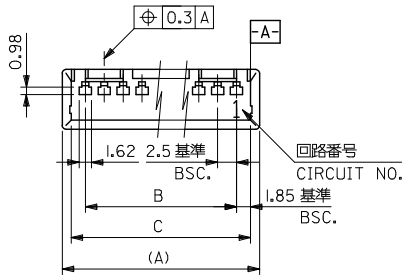

ナイロン66, 94V-0
NYLON66, 94V-0
色: オフホワイト
COLOR: OFF WHITE

注)
NOTE.

△ フリクションロック構成:
FRICTION LOCK CONFIGURATION:
4種までは1箇所
4CKT AND UNDER - 1LOCK
5種以上は2箇所
5CKT AND OVER - 2LOCKS

2. 嵌合相手: 5102-N
MATES WITH HOUSING: 5102-N

△ スリット構成:
SLIT CONFIGURATION:
4種以下はなし
4CKT AND UNDER - NO SLIT
5及び6極は1箇所
5 AND 6CKTS - 1 SLIT
7種以上は2箇所
7CKT AND OVER - 2 SLITS

29-11-0153	5240-151	35	38.7	41.1	5	38.3	15
↑ -0143	↑ -141	32.5	36.2	38.6	5	35.8	14
↑ -0133	↑ -131	30	33.7	36.1	5	33.3	13
↑ -0123	↑ -121	27.5	31.2	33.6	5	30.8	12
↑ -0103	↑ -101	22.5	26.2	28.6	5	25.8	10
↑ -0093	↑ -091	20	23.7	26.1	5	23.3	9
↑ -0083	↑ -081	17.5	21.2	23.6	5	20.8	8
↑ -0073	↑ -071	15	18.7	21.1	5	18.3	7
↑ -0063	↑ -061	12.5	16.2	18.6	5	15.8	6
↑ -0053	↑ -051	10	13.7	16.1	3.75	13.3	5
↑ -0043	↑ -041	7.5	11.2	13.6	7.5	10.8	4
↑ -0033	↑ -031	5	8.7	11.1	5	8.3	3
↓ 29-11-0023	↓ 5240-021	2.5	6.2	8.6	2.5	5.8	2
EDP.NO.	ENG.NO.	B	C	(A)	(E)	(D)	極数 CKT.

REVISED EC NO. J2016-0727 DRWN: SWAKURAOB 2016/01/20 CHKD: KASAKAWA 2016/02/12 APPR: KANEKO 2016/02/26	GENERAL TOLERANCES (UNLESS SPECIFIED)			DIMENSION STYLE		SCALE	DESIGN UNITS	THIRD ANGLE PROJECTION
	0.25 UNDER	UNDER	+0.2	MM ONLY		2:1	METRIC	
	0.25 OVER	0.5 UNDER	+0.2	DRAWN BY		TITLE		MINI. SPOX PLUG HSG molex SEE CHART SD-5240-N1 SHEET NO. 1 OF 1
	0.5 OVER	1.0 UNDER	+0.2	DATE		2000/01/28		
	1.0 OVER	10 UNDER	+0.2	CHECKED BY		DATE		
10 OVER	30 UNDER	+0.25	DATE		2000/03/30			
30 OVER		+0.3	APPROVED BY		DATE			
ANGULAR	± 3 °		MATERIAL NO.		DOCUMENT NO.			
DRAFT WHERE APPLICABLE MUST REMAIN WITHIN DIMENSIONS			SIZE	THIS DRAWING CONTAINS INFORMATION THAT IS PROPRIETARY TO MOLEX ELECTRONIC TECHNOLOGIES, LLC AND SHOULD NOT BE USED WITHOUT WRITTEN PERMISSION				

9 8 7 6 5 4 3 2 1