

Excellent Integrated System Limited

Stocking Distributor

Click to view price, real time Inventory, Delivery & Lifecycle Information:

[E-Switch](#)
[TL3210AF160RQ](#)

For any questions, you can email us directly:

sales@integrated-circuit.com

SHEET 1 OF 1

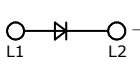
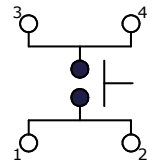
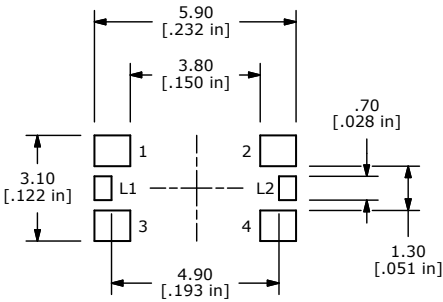

CIRCUIT: SPST

- NOTES:
1. ALL DIMENSIONS IN MM [INCH]
 2. GENERAL TOLERANCE: X.X=±0.4
X.XX=±0.25
 3. RATING: 12VDC, 50mA MAX.
 4. CONTACT RESISTANCE: 500mΩ MAX.
 5. INSULATION RESISTANCE: 100MΩ MIN. @ 100VDC
 6. TRAVEL: 0.2 ± 0.1 mm
 7. DIELECTRIC STRENGTH: 250V AC FOR 1 MIN.
 8. OPERATING FORCE: 160 ± 50gf
 9. OPERATING TEMPERATURE: -20°C TO 70°C
 10. OPERATING LIFE: 100,000 CYCLES.
 11. PACKAGING: TAPE & REEL, 2000 PIECES PER REEL C
 12. ▲ DENOTES CRITICAL PARAMETER
 13. 2002/95/EC (ROHS) COMPLIANT

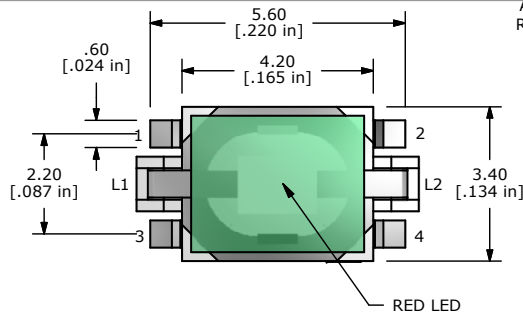

AUTOMATED PICKUP TAPE:
REMOVE AFTER SOLDERING

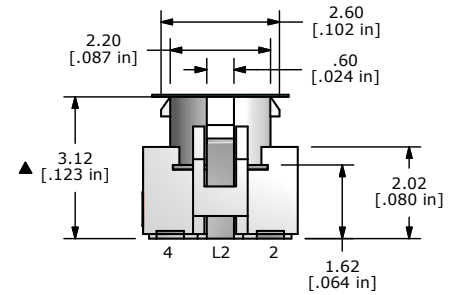
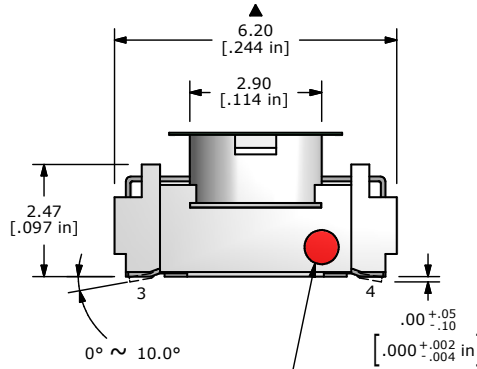
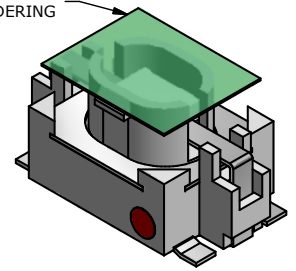

| | | | | |
|-----|--------|---------------------------------|----------|-----|
| D | 21166 | ADD TAPE | 7/1/13 | EBP |
| C | 21007 | 2000 PER REEL WAS 2500 PER REEL | 2/6/13 | EBP |
| B | 20321 | UPDATE TERMINAL CALL OUTS | 12/05/11 | BMA |
| A | 20221 | RELEASE FOR PRODUCTION | 11/17/11 | BMA |
| REV | PCR NO | DESCRIPTION | DATE | BY |

THE INFORMATION CONTAINED IN THIS DOCUMENT IS PROPRIETARY TO E-SWITCH AND IS NOT TO BE COPIED OR TRANSFERRED

| LED SPECS | UNITS | RED |
|--------------------|-------|--------------------|
| FORWARD CURRENT | mA | 20 |
| FORWARD VOLTAGE | V | 1.95 typ.- 2.5 max |
| LUMINOUS INTENSITY | mcd | 230 typ. |



TITLE TL3210AF160RQ

| | | | | | | | | | |
|-------|-----|------|------------|----|-----|-----|---------|-----|---|
| SCALE | 8:1 | DATE | 10/11/2011 | DR | BGL | DWG | B200300 | REV | D |
|-------|-----|------|------------|----|-----|-----|---------|-----|---|