

Excellent Integrated System Limited

Stocking Distributor

Click to view price, real time Inventory, Delivery & Lifecycle Information:

[Harting](#)
[09022646821](#)

For any questions, you can email us directly:
sales@integrated-circuit.com

Alle Rechte vorbehalten. All rights reserved.

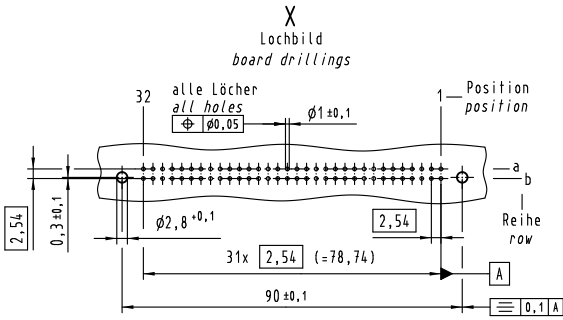

X
Kontaktanordnung
contact arrangement

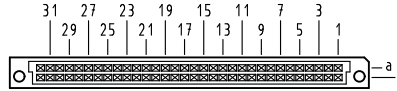

64 WW Kontakte
64 WW contacts

☒ = Kontaktposition belegt
= position with contact
☐ = Kontaktposition nicht belegt
= position without contact

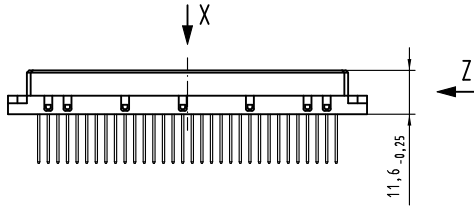

Z (2:1)

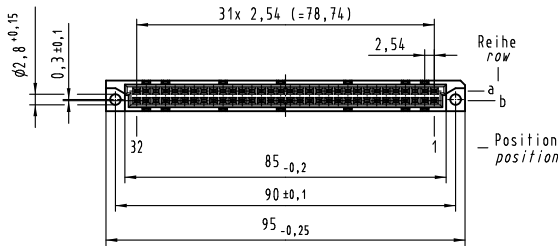
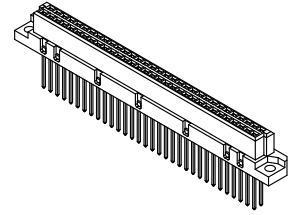
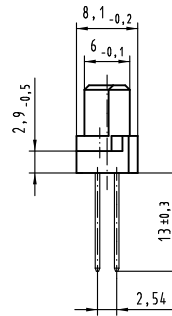

① weitere Informationen siehe: DS 09 03 210 00 02
further information see: DS 09 03 210 00 02

All Dimensions in mm Original Size DIN A 3		Techn. Character.		Maßstab/Scale 1:1		Nicht tolerierte Maß/Free size tolerances IEC 60603-2	
36468	04.01.12	Hage.	Detail.	12.10.99	Rie.	Bauform / type B Federleiste WW 13 64-polig female connector WW 13 64-pole	
34650	25.10.07	Hage.	Insp.	12.10.99	Pa.		
26962	24.01.00	Rie.	Stand.				
26091							
Mod.	Dat.	Name	HARTING Electronics GmbH & Co. KG D-32339 ESPELKAMP			TB 09 02 264 x821 Sub.	

09 02 264 6821	2
Bestell-Nr. part-no.	Anforderungsstufe performance level ①