



Distributor of Molex Connector Corporation: Excellent Integrated System Limited
Datasheet of 0192740004 - Connector Quick Connect Receptacle 14-16 AWG 0.250"
(6.35mm) Crimp

Contact us: sales@integrated-circuit.com Website: www.integrated-circuit.com

Excellent Integrated System Limited

Stocking Distributor

Click to view price, real time Inventory, Delivery & Lifecycle Information:

[Molex Connector Corporation](#)
[0192740004](#)

For any questions, you can email us directly:
sales@integrated-circuit.com

LOOSE PIECE		TAPE MOUNTED		CONTINUOUS STRIP		SPECIFICATIONS									
MATERIAL NUMBER	ENGINEERING NUMBER	MATERIAL NUMBER	ENGINEERING NUMBER	MATERIAL NUMBER	ENGINEERING NUMBER	INS. COLOR	WIRE RANGE AWG	WIRE RANGE MM	FIT SIZE TAB SIZE	STOCK THICKNESS	STOCK THICKNESS MAX.	STOCK THICKNESS MAX.	'D' ±.01	'G' NOM.	MWID
192740002	AA-2140-LIF	192740003	AA-2140T-LIF	192740001	AAZ-2140-LIF	RED	22-18/ 0.25-1.5	250x.032 / 6.35x0.81	.016 / 0.41	.87 / 22.0	.42 / 10.7	.307 / 7.80	.156 / 3.96	.31 / 7.9	.13 / 3.3
192740005	BB-2141-LIF	192740006	BB-2141T-LIF	192740004	BBZ-2141-LIF	BLUE	16-14/ 1.0-2.5	.250x.032 / 6.35x0.81	.016 / 0.41	.87 / 22.0	.42 / 10.7	.307 / 7.80	.156 / 3.96	.31 / 7.9	.14 / 3.5

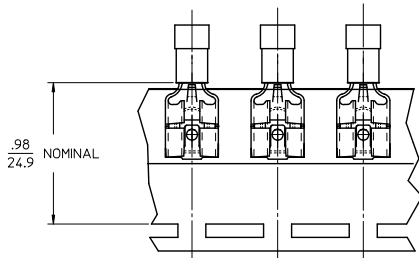
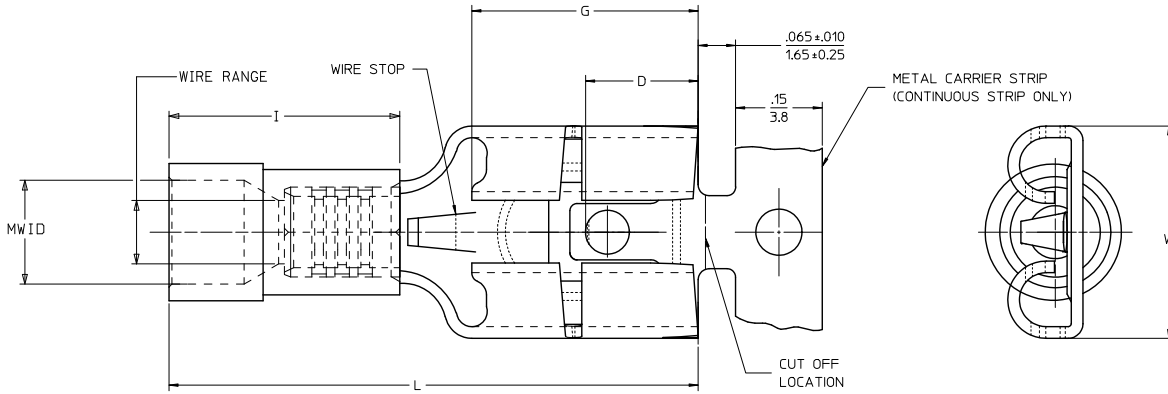

PARTS ON TAPE

NOTES:

- MATERIALS:
TERMINAL: MATTE-TIN PLATED BRASS
INSULATION: PVC 94V-0,
SEE CHART FOR COLORS
- PRODUCT SPECIFICATION: PS-19902-012
- MWID = MAXIMUM WIRE INSULATION DIAMETER
- PARTS ARE ROHS COMPLIANT

FERRULE DESCR. CONT. P/N EC NO: WNA2009-07/61 DRAWN BY: ETHRODAHL 2010/03/18 CHECKED BY: JMACNEIL 2010/03/18 APPROV: JMACNEIL 2011/01/06 REV: A	QUALITY SYMBOLS ▽=0 ▽=0	GENERAL TOLERANCES (UNLESS SPECIFIED)		DIMENSION STYLE		SCALE	DESIGN UNITS	THIRD ANGLE PROJECTION	
				IN/MM		1:1	INCH		
		4 PLACES ±---	±---	DRAWN BY	DATE	TITLE			
		3 PLACES ±---	±.005	ETHRODAHL	2010/03/18	QUIXON LOW INSERT FORCE PARTIAL INSUL QUICK DISC INSULKRIMP 22-14 AWG			
2 PLACES ±0.13	±.010	CHECKED BY	DATE	MATERIAL NO.					
1 PLACE ±0.25	±.020	JMACNEIL	2010/03/18	SD-19274-001					
ANGULAR ±1/2°		APPROVED BY	DATE	DOCUMENT NO.					
		JMACNEIL	2011/01/06	MOLEX INCORPORATED					
DRAFT WHERE APPLICABLE MUST REMAIN WITHIN DIMENSIONS		SEE CHART		SHEET NO. 1 OF 1					
THIS DRAWING CONTAINS INFORMATION THAT IS PROPRIETARY TO MOLEX INCORPORATED AND SHOULD NOT BE USED WITHOUT WRITTEN PERMISSION									