

## Excellent Integrated System Limited

Stocking Distributor

Click to view price, real time Inventory, Delivery & Lifecycle Information:

[Molex Connector Corporation](#)  
[0194350812](#)

For any questions, you can email us directly:

[sales@integrated-circuit.com](mailto:sales@integrated-circuit.com)

MATERIAL NUMBER	WIRE GAGE	GASKET	KEYING OPTION	COLOR
194350811	16-14	YES	A	BLACK
194350812	22-18	YES	A	BLACK
194350813	16-14	NO	A	BLACK
194350814	22-18	NO	A	BLACK
194350816	16-14	YES	B	GRAY
194350817	22-18	YES	B	GRAY
194350818	16-14	NO	B	GRAY
194350819	22-18	NO	B	GRAY
194350821	16-14	YES	C	BROWN
194350822	22-18	YES	C	BROWN
194350823	16-14	NO	C	BROWN
194350824	22-18	NO	C	BROWN
194350826	16-14	YES	D	GREEN
194350827	22-18	YES	D	GREEN
194350828	16-14	NO	D	GREEN
194350829	22-18	NO	D	GREEN

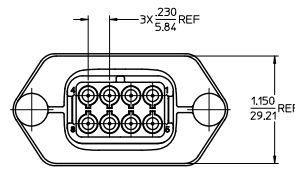
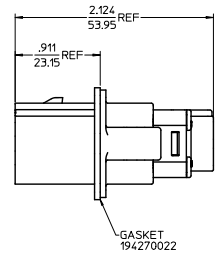
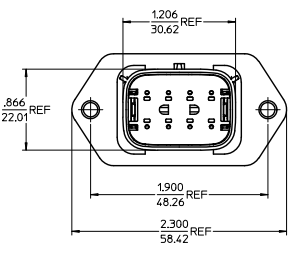
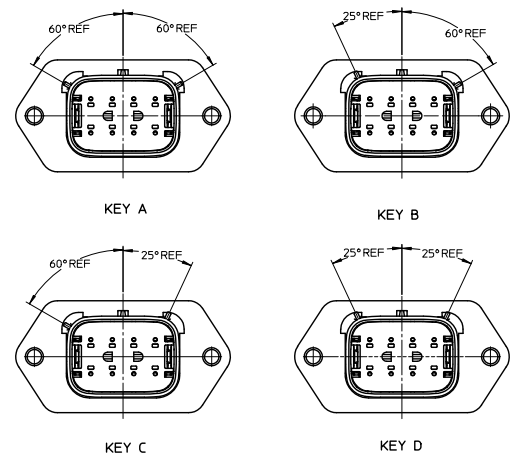
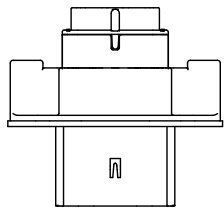
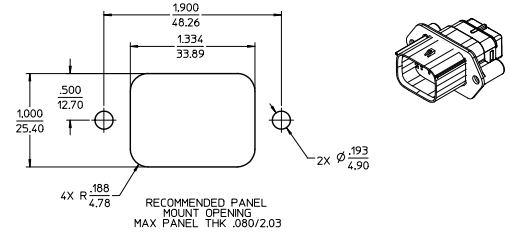

- NOTES:
- MATERIALS:  
HOUSING: POLYESTER (PB1), GLASS FILLED, UL94 V-0.  
COLOR: SEE CHART  
SEAL: SILICONE RUBBER.  
GASKET: EPDM RUBBER.
  - PRODUCT SPECIFICATION: PS-19417-001
  - PACKAGING SPECIFICATION: PK-19435-001
  - GASKETS, IF REQUIRED FOR THE ASSEMBLIES, ARE BULK PACKAGED IN A SEPARATE BAG.
  - MATES WITH 19418 SERIES RECEPTACLE ASSEMBLIES.
  - USE CONNECTOR WITH MALE CRIMP TERMINAL, SERIES 19417.
  - RECOMMENDED MOUNTING HARDWARE: 12x10 X .62/15.8 LONG PLASTIC THREAD CUTTING SCREWS, RECOMMENDED TORQUE 15-17 IN.-LBS. SUGGESTED SOURCE: ITW SHAKEPROOF INDUSTRIAL BOSSCREW OR EQUIVALENT.

UPDATE NOTES REC NO: P162012-0303 DRAWING ENG: 2011/12/28 CHKD: [blank] APPROVED: [blank] DESIGNED BY: [blank]	QUALITY SYMBOLS	GENERAL TOLERANCES (UNLESS SPECIFIED)	DIMENSION STYLE	SCALE	DESIGN UNITS	THIRD ANGLE PROJECTION
	4 PLACES $\pm .015$ 3 PLACES $\pm .015$ 2 PLACES $\pm 0.38$ 1 PLACE $\pm .015$	IN/MM DATE DRAWN BY: JPWALICKI DATE: 02/10/05 CHECKED BY: JPWALICKI DATE: 02/10/05 APPROVED BY: [blank] DATE: 02/11/05	IN/MM DATE DRAWN BY: JPWALICKI DATE: 02/10/05 CHECKED BY: JPWALICKI DATE: 02/10/05 APPROVED BY: [blank] DATE: 02/11/05	2:1	INCH	THIRD ANGLE PROJECTION
	DRAFT WHERE APPLICABLE MUST REMAIN WITHIN DIMENSIONS	MATERIAL NO: SEE CHART DOCUMENT NO: SD-19435-008	MOLEX INCORPORATED	8 WAY SEALED PLUG PANEL MOUNT ASSEMBLY, 22-14 AWG, A-D POLARIZATION		