

Excellent Integrated System Limited

Stocking Distributor

Click to view price, real time Inventory, Delivery & Lifecycle Information:

[Molex Connector Corporation](#)
[0191780014](#)

For any questions, you can email us directly:

sales@integrated-circuit.com



NOTES:

① MATERIAL : COPPER (STOCK TKN. $\frac{.040}{1.02}$)
 PLATING : ELECTRO-TIN (.0003 MIN.)

STUD SIZES: ($\pm .005$)

- 02 = .094
- 04 = .119
- 06 = .146
- 08 = .173
- 10 = .198
- 14 = .265
- 56 = .328
- 38 = .390

"UL" LISTING #E32244
 "CSA" LISTING #18689

ALL DIMENSIONS = $\frac{\text{INCHES}}{\text{MM}}$

WIRE SIZE : 12 - 10AWG.
 4.0 - 6.0 MM²

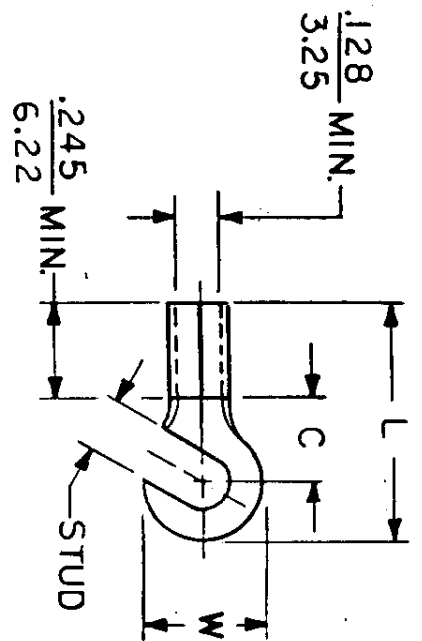

FILE NO. C-CD-101-02

PART NUMBER	"W" ±.010	"C" MIN.	"L" MAX.	AVAILABLE STUD SIZES	TITLE:		
					HOOK TONGUE	TERMINAL KRIMPTITE 100-SERIES	
C-111-	$\frac{.372}{9.45}$	$\frac{.303}{7.70}$	$\frac{.775}{19.69}$	06, 08, 10			
C-199-	$\frac{.533}{13.54}$	$\frac{.393}{9.98}$	$\frac{.953}{24.21}$	14, 56			
DIMENSIONAL TOLERANCES UNLESS OTHERWISE SPECIFIED					REFERENCE	SCALE: NTS	DATE
FRAC. DEC. ANG.					DRWN. BY: K	10-16-84	
± ± ±					CHKD. BY: GZ	10-23-84	
					APPRD. BY:		



DWG. NO. A CUSTOMER DWG.