

Excellent Integrated System Limited

Stocking Distributor

Click to view price, real time Inventory, Delivery & Lifecycle Information:

[Molex Connector Corporation](#)
[0192030033](#)

For any questions, you can email us directly:

sales@integrated-circuit.com



FILE NO. AA-CD-101-04

- NOTES:**
 ① MAT'L: PURE NICKEL
 PLATING: NONE

STUD SIZES: ($\pm .005$)

- 02 = .094
- 04 = .119
- 06 = .146
- 08 = .173
- 10 = .198
- 14 = .265
- 56 = .328
- 38 = .390

ALL DIMENSIONS = $\frac{\text{INCHES}}{\text{MM}}$

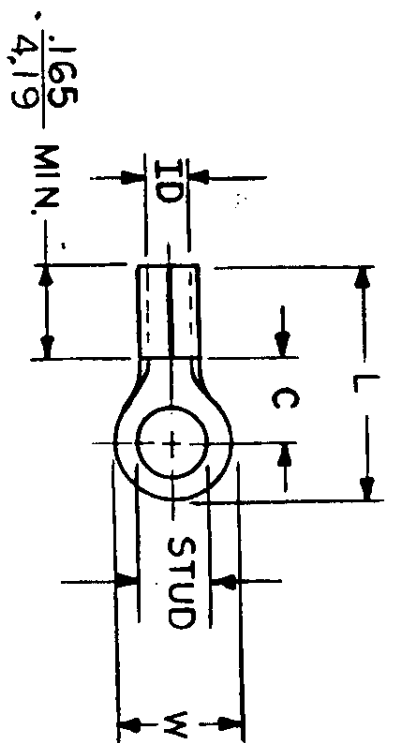

WIRE SIZE: 22-18 AWG
 25-15 MM²

PART NUMBER	"W"	"C" MIN.	"L" MAX.	"ID" MIN.	AVAILABLE STUD SIZES	STOCK THICKNESS	DIMENSIONAL TOLERANCES UNLESS OTHERWISE SPECIFIED	
							FRAC.	DEC.
02	.225	.157	.484	.062	02, 04, 06	.028 \pm .001	\pm	\pm
04	5.72	3.99	12.29	1.57	06, 08, 10	.028 \pm .001	\pm	\pm
06	.312	.270	.641	.062	10, 14, 56	.031 \pm .001	\pm	\pm
08	7.93	6.86	16.28	1.57	10, 14, 56, 38	.028 \pm .001	\pm	\pm
10	.467	.386	.835	.062	04, 06, 08	.028 \pm .001	\pm	\pm
14	11.86	9.80	21.21	1.57		.79	\pm	\pm
56	.534	.552	1.034	.054		.028 \pm .001	\pm	\pm
38	13.56	14.02	26.26	1.37		.71	\pm	\pm
AA-U-132-	.254	.240	.582	.062		.71	\pm	\pm
	6.45	6.10	14.78	1.57				

TITLE: TEMP-TERM (1200°)
 RING TONGUE
 TERMINAL
 KRIMPITE
 100-SERIES



DWG. NO. A CUSTOMER DWG.

SCALE: NTS
 DATE: 2-3-87
 DRWN. BY: EMF
 APPD. BY: