

Excellent Integrated System Limited

Stocking Distributor

Click to view price, real time Inventory, Delivery & Lifecycle Information:

[Molex Connector Corporation](#)
[0191600022](#)

For any questions, you can email us directly:
sales@integrated-circuit.com

This document was generated on 07/27/2016

PLEASE CHECK WWW.MOLEX.COM FOR LATEST PART INFORMATION

Part Number: [0191600022](#)
Status: **Active**
Overview: [Splices](#)
Description: Closed-End Connector Insert for 12-22 AWG Wire

Documents:

[Drawing \(PDF\)](#) [RoHS Certificate of Compliance \(PDF\)](#)

General

Product Family	Splices
Series	19160
Crimp Quality Equipment	Yes
Mil-Spec	N/A
Overview	Splices
Product Name	Closed-End Connector Insert
UPC	800755091526

Physical

Barrel Type	Closed
Insulation	None
Material - Metal	Copper
Material - Plating Mating	Tin
Material - Plating Termination	Tin
Net Weight	0.359/g
Packaging Type	Bag
Temperature Range - Operating	149°C
Wire Insulation Diameter	N/A
Wire Size AWG	12, 14, 16, 18, 20, 22

Material Info

Old Part Number	CE-2212
-----------------	---------

Reference - Drawing Numbers

Sales Drawing	SD-19160-009
---------------	--------------

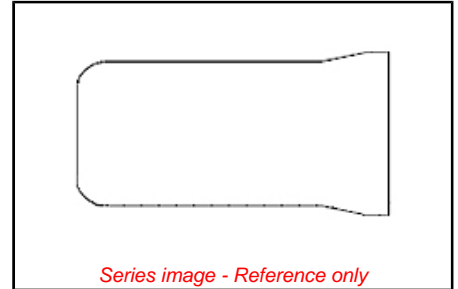

EU ELV

Not Relevant

EU RoHS

Compliant

China RoHS

REACH SVHC

Not Contained Per - ED/21/2016 (20 June 2016)

Halogen-Free

Status

Low-Halogen

Need more information on product environmental compliance?

Email productcompliance@molex.com
 Please visit the [Contact Us](#) section for any non-product compliance questions.

China ROHS	Green Image
ELV	Not Relevant

Search Parts in this Series
[19160 Series](#)

This document was generated on 07/27/2016

PLEASE CHECK WWW.MOLEX.COM FOR LATEST PART INFORMATION