



Distributor of Molex Connector Corporation: Excellent Integrated System Limited
Datasheet of 0476301000 - Connector Receptacle HDMI 19 Position Board Cutout, Through
Hole, Right Angle

Contact us: sales@integrated-circuit.com Website: www.integrated-circuit.com

Excellent Integrated System Limited

Stocking Distributor

Click to view price, real time Inventory, Delivery & Lifecycle Information:

[Molex Connector Corporation](#)
[0476301000](#)

For any questions, you can email us directly:
sales@integrated-circuit.com

Contact us: sales@integrated-circuit.com Website: www.integrated-circuit.com

DATE CODE
YYMMDD

NOTES:

- MATERIAL:
HOUSING/COVER: HIGH TEMPERATURE THERMAL PLASTIC, UL94V-0, COLOR: BLACK.
SHELL: COPPER ALLOY.
TERMINAL: COPPER ALLOY.
- PLATING:
TERMINAL:
CONTACT AREA: SEE TABLE.
SOLDER AREA: 1 MICROMETER MIN. TIN-BISMUTH ALLOY PLATED.
UNDER PLATE: 1 MICROMETER MIN. NICKEL.
SHELL: 127 MICROMETER MIN. SOLDERABLE NICKEL PLATE OVERALL.
- PRODUCT SPECIFICATION REFER TO PS-47152-001, TBA FOR PD/NI OPTION.
- PACKAGE SPECIFICATION REFER TO PK-47630-001.
- PRODUCT COMPLIANT TO RoHS DIRECTIVE 2002/95/EC AND ELV DIRECTIVE 2000/53/EC.

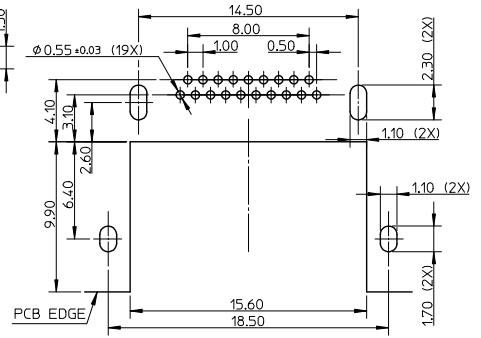
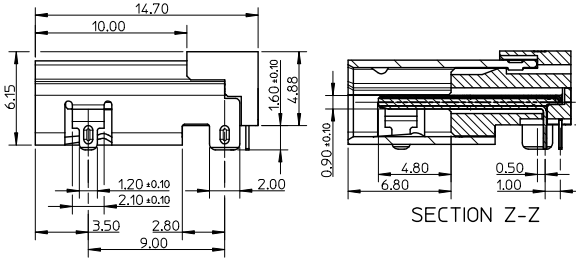
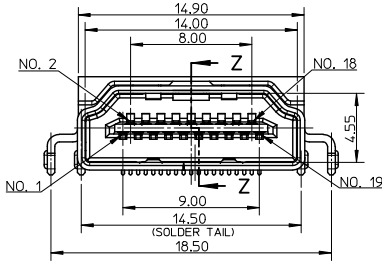
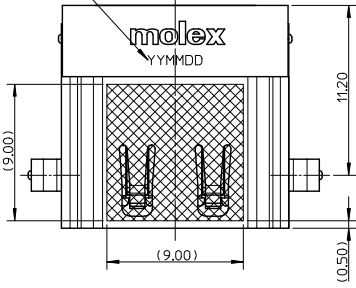
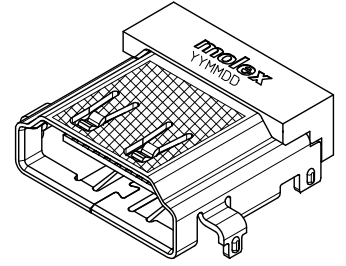

P/N	CONTACT AREA PLATING	DESCRIPTION
47630-1013	0.05 MICROMETER MIN. GOLD PLATING OVER	HALOGEN FREE
47630-1003	0.70 MICROMETER MIN. PD/NI PLATING	HALOGEN
47630-1012	GOLD FLASH	
47630-1011	0.25 MICROMETER MIN. GOLD PLATING	HALOGEN FREE
47630-1010	0.76 MICROMETER MIN. GOLD PLATING	
47630-1002	GOLD FLASH	
47630-1001	0.25 MICROMETER MIN. GOLD PLATING	HALOGEN
47630-1000	0.76 MICROMETER MIN. GOLD PLATING	

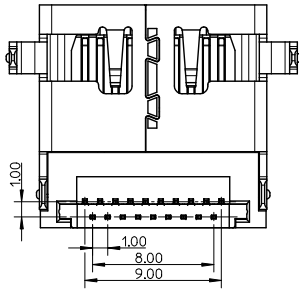

ADD PART NUMBER EC NO: S2012-0578 DRAWN: JENG CHKD: JESSIECHUA APPR: MAJESHKN 2012/03/15 2012/03/19	QUALITY SYMBOLS ▽=0 ▽=0	GENERAL TOLERANCES (UNLESS SPECIFIED)		DIMENSION STYLE MM ONLY		SCALE 4:1	DESIGN UNITS METRIC	THIRD ANGLE PROJECTION	
		4 PLACES ± --- ± ---	3 PLACES ± --- ± ---	2 PLACES ± 0.20 ± ---	1 PLACE ± 0.30 ± ---	ANGULAR ± 1°	DRAWN BY CHEN BO	DATE 2007/10/15	TITLE HDMI RECEPTACLE RIGHT ANGLE MID MOUNT TYPE
		DRAFT WHERE APPLICABLE MUST REMAIN WITHIN DIMENSIONS		SEE TABLE		MATERIAL NO.	APPROVED BY HARVEY	DATE 2007/10/15	MOLEX INCORPORATED
		THIS DRAWING CONTAINS INFORMATION THAT IS PROPRIETARY TO MOLEX INCORPORATED AND SHOULD NOT BE USED WITHOUT WRITTEN PERMISSION		DOCUMENT NO. SD-47630-100		SHEET NO. 1 OF 1			