

Excellent Integrated System Limited

Stocking Distributor

Click to view price, real time Inventory, Delivery & Lifecycle Information:

[Molex Connector Corporation](#)
[0495110301](#)

For any questions, you can email us directly:

sales@integrated-circuit.com

DWG. NO. SD-49511-001
 SIMILAR ITEM
 PROJECT NO.
 DO NOT SCALE DRAWING DIMENSION IN METRIC

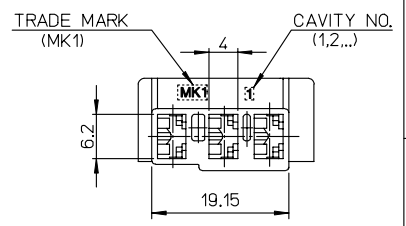
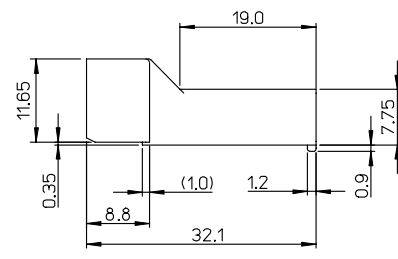
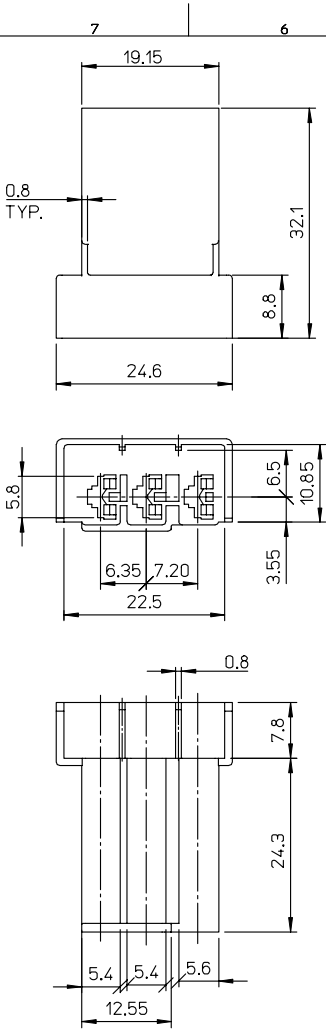

NOTES

- MATERIAL : POLYAMIDE6(UL94V-0, UNFILLED G/F)
BLACK COLOR,
(GLOW WIRE CAPABLE HAVING AN IEC GWIT & GWFI RATING OF 960 DEGREES C
AT 0.75mm WALL THICKNESS)
- APPLICABLE TERMINAL : 35068-9**2

NEW RELEASED ECN NO. KOR2005-0062 DRWN: JEJIN 04/10/01 CHK: W.Y.YANG APPR: C.W.LEE	QUALITY SYMBOLS MAJOR - 0 CRITICAL C/0	GENERAL TOLERANCES: (UNLESS SPECIFIED)		SCALE 1:1	DESIGN UNITS <input checked="" type="checkbox"/> mm <input type="checkbox"/> INCH	THIRD ANGLE PROJECTION <input checked="" type="checkbox"/> THIRD ANGLE PROJECTION	DIMENSIONS: <input type="checkbox"/> mm <input type="checkbox"/> INCH <input checked="" type="checkbox"/> mm ONLY		SHT	REV	
		4 PLACES ±0. ±-	3 PLACES ±0. ±-	2 PLACES ±0.25 ±-	1 PLACE ±0.30 ±-	ANGULAR: ± 1 °	DRAWN BY & DATE C.B.CHIN 04/07/02		TITLE: .187 MP-LOCK HOUSING-3P (FOR DOOR S/W)		REVISION ON CAD ONLY
A	REV	DRAFT WHERE APPLICABLE MUST REMAIN WITHIN DIMENSIONS		CHECKED BY & DATE W.Y.YANG 04/07/02		APPROVED BY & DATE C.W.LEE 04/07/02		MATERIAL NO. 495110301		DRAWING NO. SD-49511-001	SHEET NO. 1 OF 1
		THIS DRAWING CONTAINS INFORMATION THAT IS PROPRIETARY TO MOLEX INCORPORATED AND SHOULD NOT BE USED WITHOUT WRITTEN PERMISSION.		CAD FILENAME E495000301MO		MOLEX INCORPORATED		KOREA		SIZE B	MX-A3