

## Excellent Integrated System Limited

Stocking Distributor

Click to view price, real time Inventory, Delivery & Lifecycle Information:

[Molex Connector Corporation](#)  
[0510480400](#)

For any questions, you can email us directly:

[sales@integrated-circuit.com](mailto:sales@integrated-circuit.com)

10 9 8 7 6 5 4 3 2 1

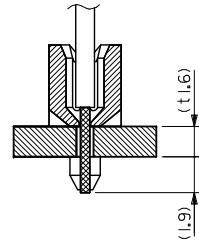
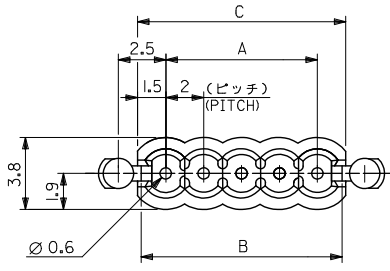

電線挿入図  
SECT.(CABLE ASS'Y)

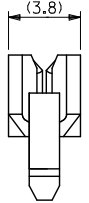
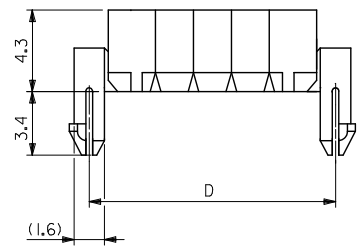

注記  
NOTES

- 材料: ナイロン66, UL94V-2  
MATERIAL: NYLON66, UL94V-2
- 適合電線: 2mmピッチリボンケーブル  
AWG#26鍍コート平行線  
APPLICABLE WIRE: 2mm PITCH RIBBON CABLE WIRE  
AWG#26, TOP COATED WIRE

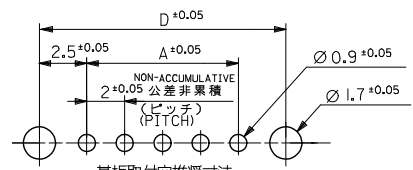

基板取付穴推奨寸法  
RECOMMENDED P.C.BOARD HOLE DIM.  
( $t=1.6+0.05$ )

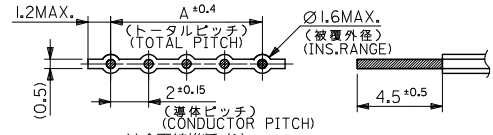

適合電線推奨寸法  
RECOMMENDED WIRE DIM.

37	35	34.6	32	51048-1700	17
35	33	32.6	30	-1600	16
33	31	30.6	28	-1500	15
31	29	28.6	26	-1400	14
29	27	26.6	24	-1300	13
27	25	24.6	22	-1200	12
25	23	22.6	20	-1100	11
23	21	20.6	18	-1000	10
21	19	18.6	16	-0900	9
19	17	16.6	14	-0800	8
17	15	14.6	12	-0700	7
15	13	12.6	10	-0600	6
13	11	10.6	8	-0500	5
11	9	8.6	6	-0400	4
9	7	6.6	4	-0300	3
7	5	4.6	2	51048-0200	2
D	C	B	A	ENG. NO.	極致 CRTS.

REVISED EC NO. J2014-0350 DRAWN: SATO02 2013/08/26 CHKD: KAKAWA 2013/08/26 APPR: NIKITA 2013/08/26	GENERAL TOLERANCES (UNLESS SPECIFIED)		DIMENSION STYLE MM ONLY	SCALE 5:1	DESIGN UNITS METRIC	THIRD ANGLE PROJECTION
	10 UNDER	± 0.2	DRAWN BY T. ITOH	DATE	TITLE	2.0 CABLE HOLDER (FOR 4.5 STRIP LENGTH)
	10 OVER 30 UNDER	± 0.25	CHECKED BY M. FUKUSHIMA	DATE '92/02/27		
	30 OVER	± 0.3	APPROVED BY M. ENOMOTO	DATE '92/02/27		
ANGULAR	± 3 °	MATERIAL NO.	DOCUMENT NO.			
DRAFT WHERE APPLICABLE MUST REMAIN WITHIN DIMENSIONS		SIZE A3	SEE TABLE THIS DRAWING CONTAINS INFORMATION THAT IS PROPRIETARY TO MOLEX INCORPORATED AND SHOULD NOT BE USED WITHOUT WRITTEN PERMISSION			

9 8 7 6 5 4 3 2