

Excellent Integrated System Limited

Stocking Distributor

Click to view price, real time Inventory, Delivery & Lifecycle Information:

[Molex Connector Corporation](#)
[0511030204](#)

For any questions, you can email us directly:

sales@integrated-circuit.com

DWG. NO. SD-51103-020

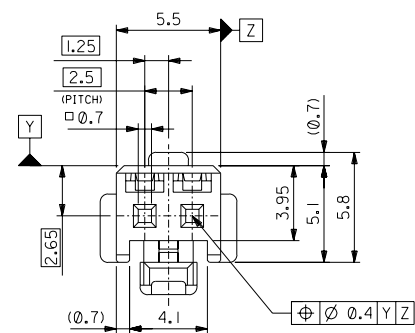
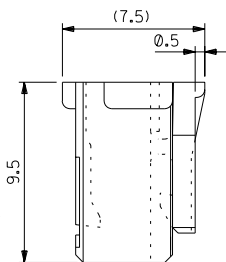
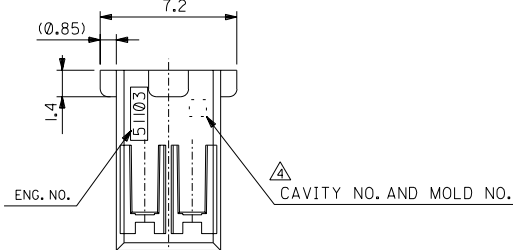
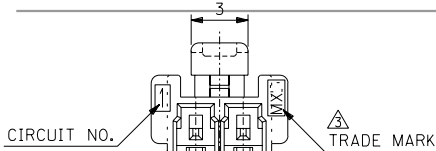

注記 NOTES

- △ 適合ターミナル: 50351-8*00
APPLICABLE TERMINAL : 50351-8*00
- 2. 嵌合相手: 53464 シリーズ
MATE WITH : 53464 SERIES.
- △ MXJと表示。
INDICATE MXJ.
- △ キャビティー番号: 1桁~2桁の数字
金型番号: アルファベット1文字にて構成。(例, 1A, 10B)
FORMED BY 1 DIGIT TO 2 DIGIT NUMBERS (TO CAVITY NO.)
AND BY 1 LETTER OF ALPHABET (TO MOLD NO.).
(e.g., 1A, 10B)
- 5. 製品番号の末尾は製品の色を示す
LAST NUMBER OF DWG.NO. MEANS PART COLLER.

51103-**25
色番号 COLLER CODE
5 蛍光灰色 GRAY

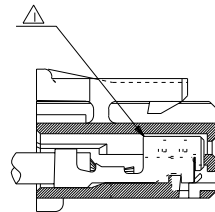

ターミナル装着状態図
TERMINAL ASSEMBLY DRAWING

51103-0225	2
MATERIAL NO.	NO. OF CIRCUIT

DIMENSIONS:	SHT	REV
<input type="checkbox"/> mm <input type="checkbox"/> INCH <input checked="" type="checkbox"/> mm ONLY	<input type="checkbox"/>	<input type="checkbox"/>
EXCEPT OTHERWISE ON CAD ONLY		

GENERAL TOLERANCES: (UNLESS SPECIFIED) 一般公差	SCALE 5 : 1	DESIGN UNITS <input checked="" type="checkbox"/> mm <input type="checkbox"/> INCH	PROJECTION <input checked="" type="checkbox"/> FIRST ANGLE	TITLE: 2.5 WIRE TO BOARD CONN. HOUSING (POSITIVE LOCK)
10 UNDER 未満 +0.2	DRAWN BY & DATE N.I.TO '02/11/22	MATERIAL NO. DRAWING NO. SHEET NO. SEE CHART SD-51103-020 1 OF 1		
10 OVER 以上 30 UNDER 未満 +0.25	CHECKED BY & DATE K.SAKAWA '02/11/22	MOLEX INCORPORATED		
30 OVER 以上 +0.3	APPROVED BY & DATE T.YAMAGUCHI '02/11/22	MATERIAL NO. DRAWING NO. SHEET NO. SEE CHART SD-51103-020 1 OF 1		
ANGLE 角度 ±3°	CAD FILENAME SD-51103-020.S01	MATERIAL NO. DRAWING NO. SHEET NO. SEE CHART SD-51103-020 1 OF 1		
*BBS DRAWING CONTAINS INFORMATION THAT IS PROPRIETARY TO MOLEX INCORPORATED AND SHOULD NOT BE USED WITHOUT WRITTEN PERMISSION.				
				SIZE B

DO NOT SCALE DRAWING	8	7	6	5	4	3	2	1
ENG. NO. DRAWN: CHK: APPR:	ENG. NO. DRAWN: CHK: APPR:	ENG. NO. DRAWN: CHK: APPR:	RELEASED '02/11/22 DRAWN: N.I.TO CHK: K.SAKAWA APP: T.YAMAGUCHI	MATERIAL 材料 POLYBUTYLENE TEREPHTHALATE UL94V-0	FINISH 仕上り	WIRE RANGE 適用電線範囲	INS. RANGE 被覆外径	EN-02J(097) MXJ-54

10 9 8 7 6 5 4 3 2 1

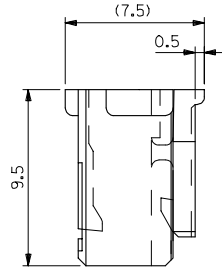
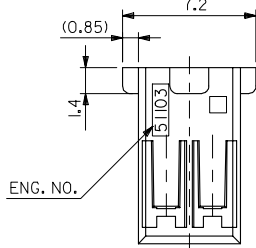
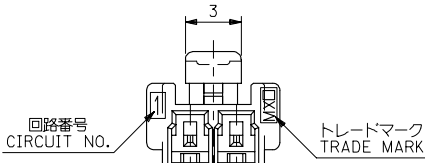

注記 NOTES

- △ 適合ターミナル : 5035I-8*00
APPLICABLE TERMINAL : 5035I-8*00
2. 嵌合相手 : 53375,53426 シリーズ
MATE WITH : 53375,53426 SERIES
- △ 偶数極の製品に適用。
APPLY EVEN CIRCUIT PRODUCTS.
4. 製品型番の下1桁は色を表す。
LAST DIGIT OF PART NUMBER INDICATES COLOR.
0 : 白 WHITE 1 : 黒 BLACK 2 : 赤 RED
3 : 黄 YELLOW 4 : 青 BLUE

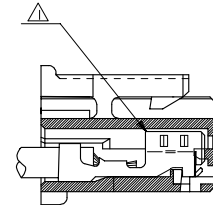

ターミナル装着状態図
TERMINAL ASSEMBLY DRAWING

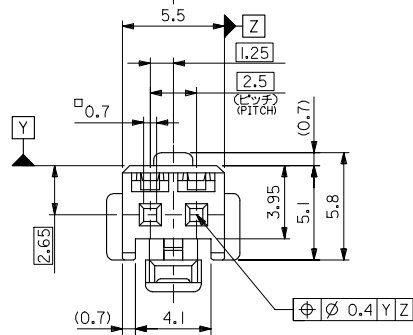

2極に適用
FOR 2 CKTS.

51103-020*	2
MATERIAL NO.	CIRCUIT
◎	THIRD ANGLE PROJECTION

RELEASED EC NO. : J2005-2009 DRAWN BY M.UMEDA CHK'D BY K.TOYODA APPR'D BY N.UKITA 2005/02/02 2005/02/04 2005/02/14	GENERAL TOLERANCES (UNLESS SPECIFIED)		DIMENSION STYLE MM ONLY	SCALE ---	DESIGN UNITS METRIC	TITLE 2.5 W/B CONN. HOUSING (POSITIVE LOCK)
	10 UNDER	± 0.2	DRAWN BY M.UMEDA	DATE 2005/01/14	MOLEX INCORPORATED	
	10 OVER 30 UNDER	± 0.25	CHECKED BY K.TOYODA	DATE 2005/01/14		
	30 OVER	± 0.3	APPROVED BY N.UKITA	DATE 2005/01/14		
ANGULAR ± 3 °		DRAFT WHERE APPLICABLE MUST REMAIN WITHIN DIMENSIONS		MATERIAL NO. SEE CHART	DOCUMENT NO. SD-51103-021	SHEET NO. 1 OF 2
SIZE A3 THIS DRAWING CONTAINS INFORMATION THAT IS PROPRIETARY TO MOLEX INCORPORATED AND SHOULD NOT BE USED WITHOUT WRITTEN PERMISSION						

10 9 8 7 6 5 4 3 2 1

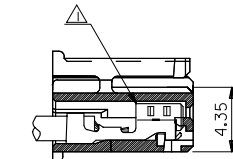
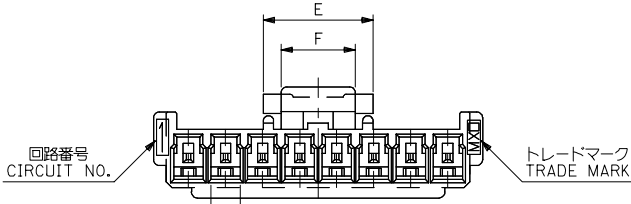

ターミナル装着状態図
TERMINAL ASSEMBLY DRAWING

注記 NOTES

- △ 適合ターミナル : 50351-8*00
APPLICABLE TERMINAL : 50351-8*00
- 嵌合相手 : 53375,53426 シリーズ
MATE WITH : 53375,53426 SERIES
- △ 偶数極の製品に適用。
APPLY EVEN CIRCUIT PRODUCTS.
- 製品型番の下1桁は色を表す。
LAST DIGIT OF PART NUMBER INDICATES COLOR.
0 : 白 WHITE 1 : 黒 BLACK 2 : 赤 RED
3 : 黄 YELLOW 4 : 青 BLUE

3-15 極に適用
FOR 3-15 CKTS.

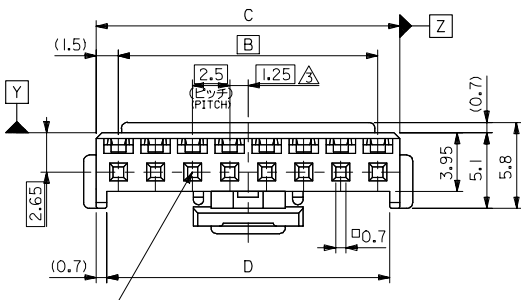
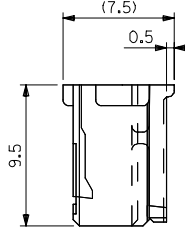
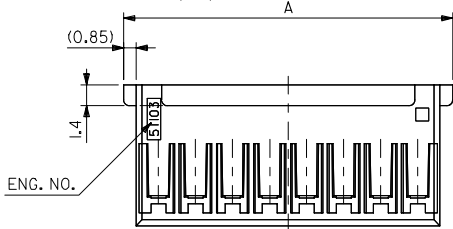

5	7.4	36.6	38	35	39.7	51103-150*	15
↑	↑	34.1	35.5	32.5	37.2	↑ -140*	14
		31.6	33	30	34.7	↑ -130*	13
		29.1	30.5	27.5	32.2	↑ -120*	12
		26.6	28	25	29.7	↑ -110*	11
		24.1	25.5	22.5	27.2	↑ -100*	10
		21.6	23	20	24.7	↑ -090*	9
		19.1	20.5	17.5	22.2	↑ -080*	8
		16.6	18	15	19.7	↑ -070*	7
		14.1	15.5	12.5	17.2	↑ -060*	6
		11.6	13	10	14.7	↑ -050*	5
5	7.4	9.1	10.5	7.5	12.2	↓ -040*	4
3	5	6.6	8	5	9.7	51103-030*	3
F	E	D	C	B	A	MATERIAL NO.	CIRCUIT

RELEASED EC NO: J2005-2009 DRAWN BY: M.UMEDA CHKD BY: K.TOYODA APP: N. KITAHARA DATE: 2005/02/04 DATE: 2005/02/14 DATE: 2005/02/14	GENERAL TOLERANCES (UNLESS SPECIFIED)		DIMENSION STYLE	SCALE	DESIGN UNITS	THIRD ANGLE PROJECTION
			MM ONLY	---	METRIC	☉
	10 UNDER	± 0.2	DRAWN BY	DATE	TITLE	
	10 OVER 30 UNDER	± 0.25	M.UMEDA	2005/01/14	2.5 W/B CONN. HOUSING (POSITIVE LOCK)	
30 OVER	± 0.3	CHECKED BY	DATE	MATERIAL NO.		
ANGULAR	± 3 °	K.TOYODA	2005/01/14	SD-51103-021		
DRAFT WHERE APPLICABLE MUST REMAIN WITHIN DIMENSIONS		APPROVED BY	DATE	DOCUMENT NO.		
		N. KITAHARA	2005/01/14	SEE CHART		
		MATERIAL NO.	DATE	SHEET NO.		
		SEE CHART	2005/01/14	2 OF 2		
		SIZE	THIS DRAWING CONTAINS INFORMATION THAT IS PROPRIETARY TO MOLEX INCORPORATED AND SHOULD NOT BE USED WITHOUT WRITTEN PERMISSION			
		A3				