

Excellent Integrated System Limited

Stocking Distributor

Click to view price, real time Inventory, Delivery & Lifecycle Information:

[Molex Connector Corporation](#)
[0511031200](#)

For any questions, you can email us directly:

sales@integrated-circuit.com

DWG. NO. SD-51103-020

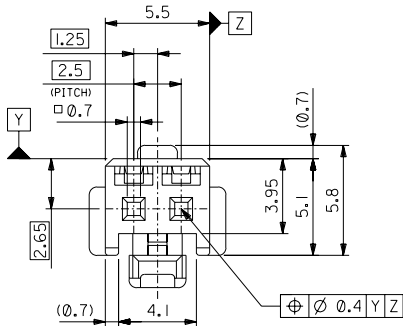
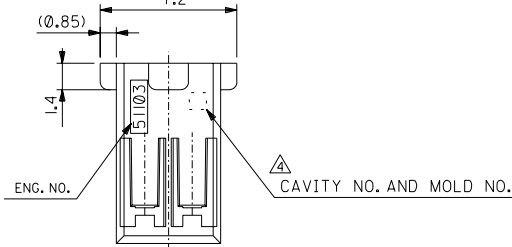
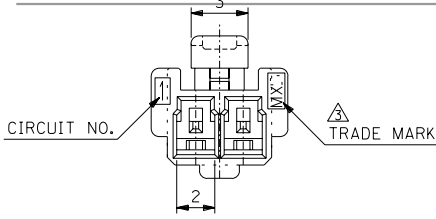

注記 NOTES

- 適合ターミナル: 50351-8*00
APPLICABLE TERMINAL: 50351-8*00
- 嵌合相手: 53464 シリーズ
MATE WITH: 53464 SERIES.
- MXJと表示。
INDICATE MXJ.
- キャビティー番号: 1桁~2桁の数字
金型番号: アルファベット1文字にて構成。(例, 1A, 10B)
FORMED BY 1 DIGIT TO 2 DIGIT NUMBERS (TO CAVITY NO.)
AND BY 1 LETTER OF ALPHABET (TO MOLD NO.).
(e.g., 1A, 10B)
- 製品番号の末尾は製品の色を示す
LAST NUMBER OF DWG.NO. MEANS PART COLLER.

51103-**25
色番号 COLLER CODE
5 蛍光灰色 GRAY

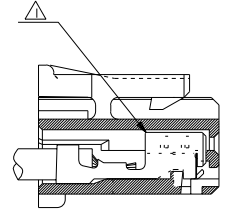

ターミナル装着状態図
TERMINAL ASSEMBLY DRAWING

| | |
|--------------|----------------|
| 51103-0225 | 2 |
| MATERIAL NO. | NO. OF CIRCUIT |

DO NOT SCALE DRAWING

| | | | | | |
|---|---------------------------------------|---|---------------------------------------|---|---|
| 8 | ENG. NO. DRAWN: CHK'G: APPR: | 7 | ENG. NO. DRAWN: CHK'G: APPR: | 6 | RELEASED '02/11/22 DRAWN: N.IITO CHK'G: K.SAKAWA APPR: T.YAMAGUCHI |
|---|---------------------------------------|---|---------------------------------------|---|---|

| | | | |
|---|---------------|----------------------|--------------------|
| MATERIAL 材料 POLYBUTYLENE TEREPHTHALATE UL94V-0 | FINISH 仕上り | WIRE RANGE 適用電線範囲 | INS. RANGE 被覆外径 |
|---|---------------|----------------------|--------------------|

| | | |
|---|--------------|---|
| GENERAL TOLERANCES: (UNLESS SPECIFIED) 一般公差 | SCALE 5:1 | DESIGN UNITS mm INCH |
| 10 UNDER 未満 | +0.2 | DRAWN BY & DATE N.IITO '02/11/22 |
| 10 OVER 以上 | +0.25 | CHECKED BY & DATE K.SAKAWA '02/11/22 |
| 30 OVER 以上 | +0.3 | APPROVED BY & DATE T.YAMAGUCHI '02/11/22 |
| ANGLE 角度 | ±3° | CAD FILENAME SD-51103-020.S01 |

| | | | |
|------------|------------|------------|------------|
| PROJECTION | PROJECTION | PROJECTION | PROJECTION |
| mm INCH | mm INCH | mm INCH | mm INCH |
| mm ONLY | mm ONLY | mm ONLY | mm ONLY |

| | | | |
|--|---------------------------|-----------------------------|---------------------|
| TITLE: 2.5 WIRE TO BOARD CONN. HOUSING (POSITIVE LOCK) | MATERIAL NO. SEE CHART | DRAWING NO. SD-51103-020 | SHEET NO. 1 OF 1 |
| MOLEX INCORPORATED | | | SIZE B |
| EN-02J(097) MXJ-54 | | | |

THIS DRAWING CONTAINS INFORMATION THAT IS PROPRIETARY TO MOLEX INCORPORATED AND SHOULD NOT BE USED WITHOUT WRITTEN PERMISSION.

10 9 8 7 6 5 4 3 2 1

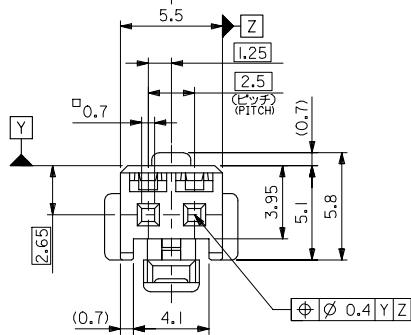
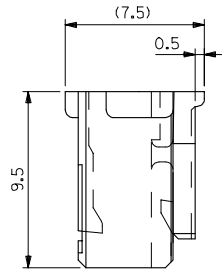
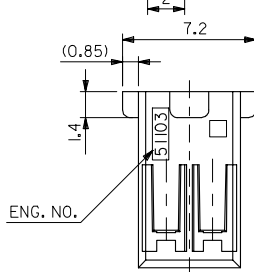
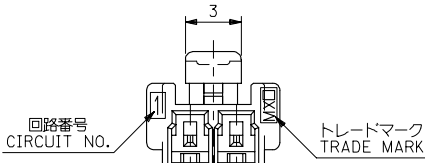

注記 NOTES

- △ 適合ターミナル : 5035I-8*00
APPLICABLE TERMINAL : 5035I-8*00
2. 嵌合相手 : 53375,53426 シリーズ
MATE WITH : 53375,53426 SERIES
- △ 偶数極の製品に適用。
APPLY EVEN CIRCUIT PRODUCTS.
4. 製品型番の下1桁は色を表す。
LAST DIGIT OF PART NUMBER INDICATES COLOR.
0 : 白 WHITE 1 : 黒 BLACK 2 : 赤 RED
3 : 黄 YELLOW 4 : 青 BLUE

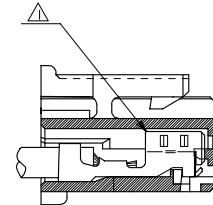

ターミナル装着状態図
TERMINAL ASSEMBLY DRAWING

2極に適用
FOR 2 CKTS.

| | |
|--------------|------------------------|
| 51103-020* | 2 |
| MATERIAL NO. | CIRCUIT |
| ◎ | THIRD ANGLE PROJECTION |

| | | | | | | |
|---|---------------------------------------|--|----------------------------|--------------------|---|---|
| RELEASED EC NO. : J2005-2009 DRAWN BY M.UMEDA 2005/02/04 CHECKED BY K.TOYODA 2005/02/04 APPR. BY N.UKITA 2005/02/14 REV. | GENERAL TOLERANCES (UNLESS SPECIFIED) | | DIMENSION STYLE MM ONLY | SCALE --- | DESIGN UNITS METRIC | TITLE 2.5 W/B CONN. HOUSING (POSITIVE LOCK) |
| | 10 UNDER | ± 0.2 | DRAWN BY M.UMEDA | DATE 2005/01/14 | MOLEX INCORPORATED | |
| | 10 OVER 30 UNDER | ± 0.25 | CHECKED BY K.TOYODA | DATE 2005/01/14 | | |
| | 30 OVER | ± 0.3 | APPROVED BY N.UKITA | DATE 2005/01/14 | MATERIAL NO. SEE CHART DOCUMENT NO. SD-51103-021 | |
| ANGULAR ± 3 ° | | DRAFT WHERE APPLICABLE MUST REMAIN WITHIN DIMENSIONS | | SHEET NO. 1 OF 2 | | THIS DRAWING CONTAINS INFORMATION THAT IS PROPRIETARY TO MOLEX INCORPORATED AND SHOULD NOT BE USED WITHOUT WRITTEN PERMISSION |

9 8 7 6 5 4 3 2 1 EN-02JA(021)

10 9 8 7 6 5 4 3 2 1

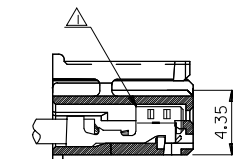
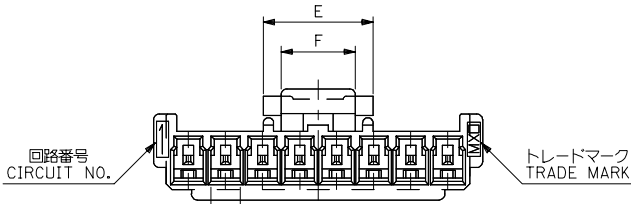

ターミナル装着状態図
TERMINAL ASSEMBLY DRAWING

注記 NOTES

- △ 適合ターミナル : 50351-8*00
APPLICABLE TERMINAL : 50351-8*00
2. 嵌合相手 : 53375,53426 シリーズ
MATE WITH : 53375,53426 SERIES
- △ 偶数極の製品に適用。
APPLY EVEN CIRCUIT PRODUCTS.
4. 製品型番の下1桁は色を表す。
LAST DIGIT OF PART NUMBER INDICATES COLOR.
0 : 白 WHITE 1 : 黒 BLACK 2 : 赤 RED
3 : 黄 YELLOW 4 : 青 BLUE

3-15 極に適用
FOR 3-15 CKTS.

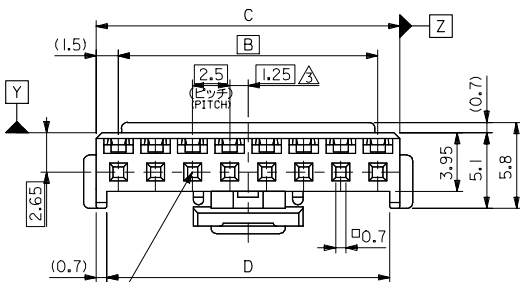
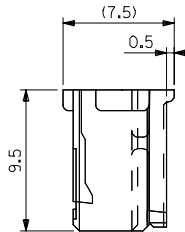
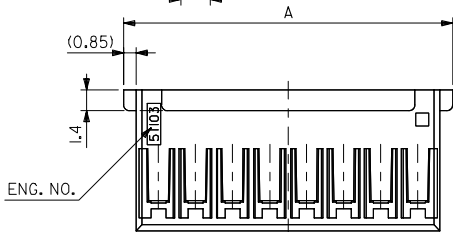

| | | | | | | | |
|---|-----|------|------|------|------|--------------|---------|
| 5 | 7.4 | 36.6 | 38 | 35 | 39.7 | 51103-150* | 15 |
| ↑ | ↑ | 34.1 | 35.5 | 32.5 | 37.2 | ↑ -140* | 14 |
| | | 31.6 | 33 | 30 | 34.7 | ↑ -130* | 13 |
| | | 29.1 | 30.5 | 27.5 | 32.2 | ↑ -120* | 12 |
| | | 26.6 | 28 | 25 | 29.7 | ↑ -110* | 11 |
| | | 24.1 | 25.5 | 22.5 | 27.2 | ↑ -100* | 10 |
| | | 21.6 | 23 | 20 | 24.7 | ↑ -090* | 9 |
| | | 19.1 | 20.5 | 17.5 | 22.2 | ↑ -080* | 8 |
| | | 16.6 | 18 | 15 | 19.7 | ↑ -070* | 7 |
| | | 14.1 | 15.5 | 12.5 | 17.2 | ↑ -060* | 6 |
| | | 11.6 | 13 | 10 | 14.7 | ↑ -050* | 5 |
| 5 | 7.4 | 9.1 | 10.5 | 7.5 | 12.2 | ↓ -040* | 4 |
| 3 | 5 | 6.6 | 8 | 5 | 9.7 | 51103-030* | 3 |
| F | E | D | C | B | A | MATERIAL NO. | CIRCUIT |

| | | | | | | | |
|--|---|--------|-----------------|--------------|--------------|------------------------|--|
| RELEASED EC NO: J2005-2009 DRAWN BY: M.UMEDA CHK'D BY: K.TOYODA APPR'D BY: N.UKITA DATE: 2005/02/04 DATE: 2005/02/14 DATE: 2005/02/14 | GENERAL TOLERANCES (UNLESS SPECIFIED) | | DIMENSION STYLE | SCALE | DESIGN UNITS | THIRD ANGLE PROJECTION | |
| | 10 UNDER | ± 0.2 | MM ONLY | --- | METRIC | ☉ | |
| | 10 OVER 30 UNDER | ± 0.25 | | | | | |
| | 30 OVER | ± 0.3 | | | | | |
| | ANGULAR | ± 3 ° | | | | | |
| | DRAFT WHERE APPLICABLE MUST REMAIN WITHIN DIMENSIONS | | MATERIAL NO. | DOCUMENT NO. | SHEET NO. | | |
| | | | SEE CHART | SD-51103-021 | 2 OF 2 | | |
| | THIS DRAWING CONTAINS INFORMATION THAT IS PROPRIETARY TO MOLEX INCORPORATED AND SHOULD NOT BE USED WITHOUT WRITTEN PERMISSION | | | | | | |

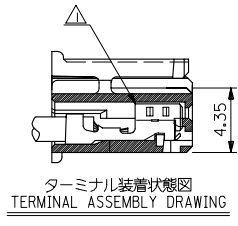
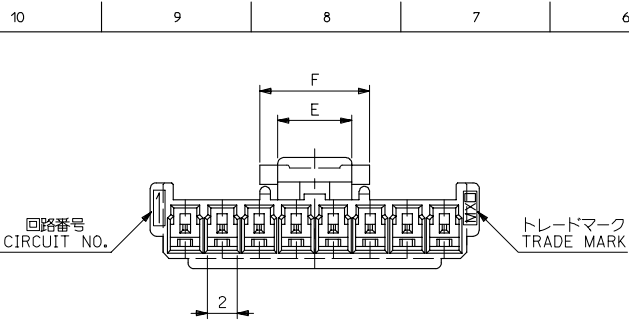

注記 NOTES

- △ 適合ターミナル : 50351-8*00
APPLICABLE TERMINAL : 50351-8*00
- 2. 嵌合相手 : 53375,53376,53388,53389
53426 シリーズ
MATE WITH : 53375,53376,53388,53389
53426 SERIES
- △ 偶数極の製品に適用。
APPLY EVEN CIRCUIT PRODUCTS.

3-15 極に適用
FOR 3-15 CKTS.

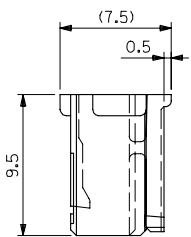
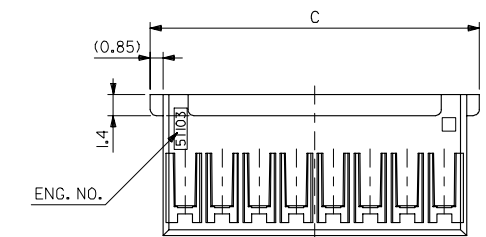

| | | | | | | | |
|-----|---|------|------|------|------|--------------|------------|
| 7.4 | 5 | 36.6 | 39.7 | 38 | 35 | 51103-1500 | 15 |
| ↑ | ↑ | 34.1 | 37.2 | 35.5 | 32.5 | -1400 | 14 |
| | | 31.6 | 34.7 | 33 | 30 | -1300 | 13 |
| | | 29.1 | 32.2 | 30.5 | 27.5 | -1200 | 12 |
| | | 26.6 | 29.7 | 28 | 25 | -1100 | 11 |
| | | 24.1 | 27.2 | 25.5 | 22.5 | -1000 | 10 |
| | | 21.6 | 24.7 | 23 | 20 | -0900 | 9 |
| | | 19.1 | 22.2 | 20.5 | 17.5 | -0800 | 8 |
| | | 16.6 | 19.7 | 18 | 15 | -0700 | 7 |
| | | 14.1 | 17.2 | 15.5 | 12.5 | -0600 | 6 |
| | | 11.6 | 14.7 | 13 | 10 | -0500 | 5 |
| 7.4 | 5 | 9.1 | 12.2 | 10.5 | 7.5 | -0400 | 4 |
| 5 | 3 | 6.6 | 9.7 | 8 | 5 | 51103-0300 | 3 |
| F | E | D | C | B | A | MATERIAL NO. | 極数 OF CKT. |

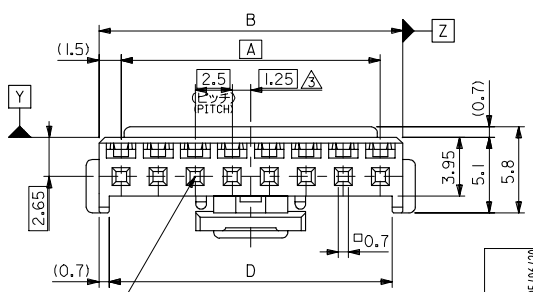

| | | | | | | | |
|---|---|--|-------|--|-------|--------------|---------------------------------|
| 材料 MATERIAL PBTP, UL94V-0 (色 WHITE) 仕上り FINISH 適用電線範囲 WIRE RANGE 被覆外径 INS. RANGE | REVISED EC NO: J2005-3799 DRAWN/MABEI 2005/06/20 CHK/KK/TOYODA 2005/06/21 APP/RIKITA 2005/06/27 | GENERAL TOLERANCES (UNLESS SPECIFIED) | | DIMENSION STYLE | SCALE | DESIGN UNITS | 第三角投影 THIRD ANGLE PROJECTION |
| | | 10 UNDER | ±0.2 | MM ONLY | 4:1 | METRIC | |
| | | 10 OVER | ±0.25 | | | | |
| | | 30 OVER | ±0.3 | | | | |
| | | ANGULAR ±3° | | | | | |
| | | DRAFT WHERE APPLICABLE MUST REMAIN WITHIN DIMENSIONS | | | | | |
| | | DRAWN BY DATE | | TITLE | | | |
| | | T. ITO '92/05/06 | | 2.5 WIRE TO BOARD CONN HOUSING (POSITIVE LOCK) | | | |
| | | CHECKED BY DATE | | APPROVED BY DATE | | | |
| | | H.HIRAMOTO '95/10/03 | | M.FUKUSHIMA '95/10/03 | | | |
| | | MATERIAL NO. | | DOCUMENT NO. | | SHEET NO. | |
| | | SEE CHART | | SD-51103-023 | | 1 OF 2 | |
| SIZE A3 THIS DRAWING CONTAINS INFORMATION THAT IS PROPRIETARY TO MOLEX INCORPORATED AND SHOULD NOT BE USED WITHOUT WRITTEN PERMISSION | | | | | | | |

10 9 8 7 6 5 4 3 2 1

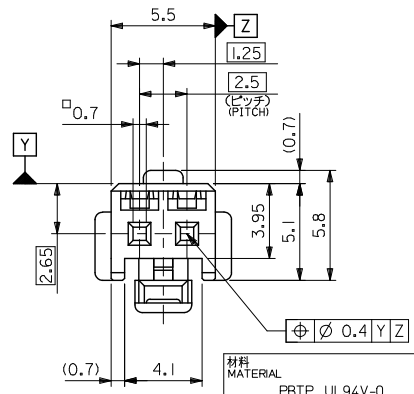
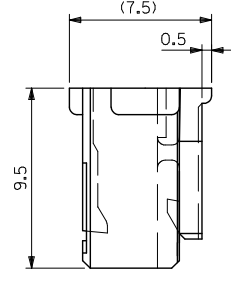
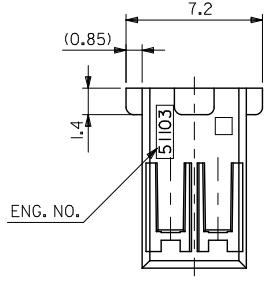
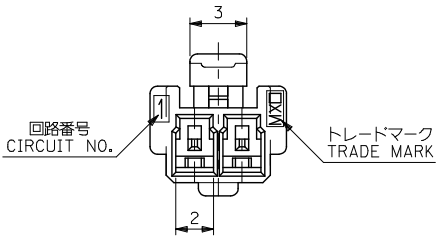

注記 NOTES

- △ 適合ターミナル: 50351-8*00
APPLICABLE TERMINAL: 50351-8*00
- 2. 嵌合相手: 53375,53426 シリーズ
MATE WITH: 53375,53426 SERIES

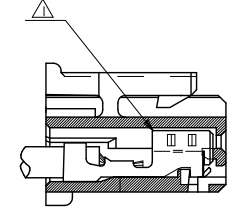

ターミナル装着状態図
TERMINAL ASSEMBLY DRAWING

2極に適用
FOR 2 CKTS.

| | |
|------------------------|--------------|
| 51103-0200 | 2 |
| MATERIAL NO. | NO. OF CKTS. |
| THIRD ANGLE PROJECTION | |

| | |
|-------------------|--------------------------|
| 材料 MATERIAL | PBTP, UL94V-0 (白色 WHITE) |
| 仕上げ FINISH | — |
| 適用電線範囲 WIRE RANGE | — |
| 被覆外径 INS. RANGE | — |

| | | | | | | |
|---|-------------|---|------------------------|--------------------|--------------|-------|
| REVISED REV. NO. J2005-3799 DRAWN BY: 2005/06/20 CHKD BY: 2005/06/21 APPR. BY: 2005/06/27 | DESCRIPTION | GENERAL TOLERANCES (UNLESS SPECIFIED) | DIMENSION STYLE | SCALE | DESIGN UNITS | TITLE |
| | | 10 UNDER ±0.2 | MM ONLY | 5:1 | METRIC | |
| REVISED REV. NO. J2005-3799 DRAWN BY: 2005/06/20 CHKD BY: 2005/06/21 APPR. BY: 2005/06/27 | DESCRIPTION | 10 OVER 30 UNDER ±0.25 | DRAWN BY DATE | MATERIAL NO. | | |
| | | 30 OVER ±0.3 | T. ITO '92/05/06 | MOLEX INCORPORATED | | |
| REVISED REV. NO. J2005-3799 DRAWN BY: 2005/06/20 CHKD BY: 2005/06/21 APPR. BY: 2005/06/27 | DESCRIPTION | ANGULAR ±3° | CHECKED BY DATE | DOCUMENT NO. | | |
| | | DRAFT WHERE APPLICABLE MUST REMAIN WITHIN DIMENSIONS | H. HIRAMOTO '95/10/03 | SD-51103-023 | | |
| REVISED REV. NO. J2005-3799 DRAWN BY: 2005/06/20 CHKD BY: 2005/06/21 APPR. BY: 2005/06/27 | DESCRIPTION | SEE CHART | APPROVED BY DATE | SHEET NO. | | |
| | | THIS DRAWING CONTAINS INFORMATION THAT IS PROPRIETARY TO MOLEX INCORPORATED AND SHOULD NOT BE USED WITHOUT WRITTEN PERMISSION | M. FUKUSHIMA '95/10/03 | 2 OF 2 | | |