

## Excellent Integrated System Limited

Stocking Distributor

Click to view price, real time Inventory, Delivery & Lifecycle Information:

[Molex Connector Corporation](#)  
[0716612430](#)

For any questions, you can email us directly:

[sales@integrated-circuit.com](mailto:sales@integrated-circuit.com)

NOTES:

1. MATERIAL:  
HOUSING: LIQUID CRYSTAL POLYMER (LCP), GLAS-FILLED, UL 94V-0.  
COLOR: BRASS
  2. FINISH:  
TERMINAL: BRASS  
TERMINAL: 0.76 MICROMETERS/30 MICROINCHES MINIMUM SELECTIVE GOLD  
IN CONTACT AREA, 1.27 MICROMETERS/50 MICROINCHES MINIMUM  
SELECTIVE TIN IN THE PC TAIL AREA, NICKEL UNDERPLATE OVERALL
  3. ASSEMBLY MATES WITH MOLEX P/N SDA-71660-\*\*\*\*
  4. CONFORMS TO PRODUCT SPEC: PS-71660
- △ RECOMMENDED PC BOARD THICKNESS IS .062/1.60  
 △ FOUR DIGIT DATE CODE (WK.YR) EXAMPLE 26 96 LOCATED IN AREA SHOWN  
 △ TOOLING STATUS: 'X' INDICATES NO TOOLING AVAILABLE  
 CONTACT FACTORY FOR FURTHER INFORMATION

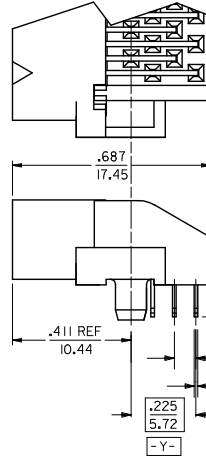
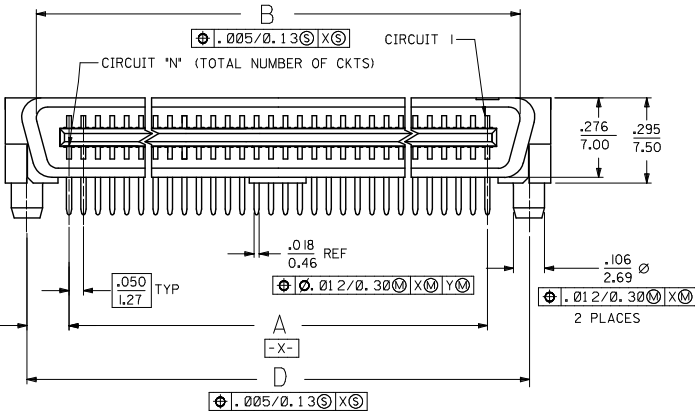
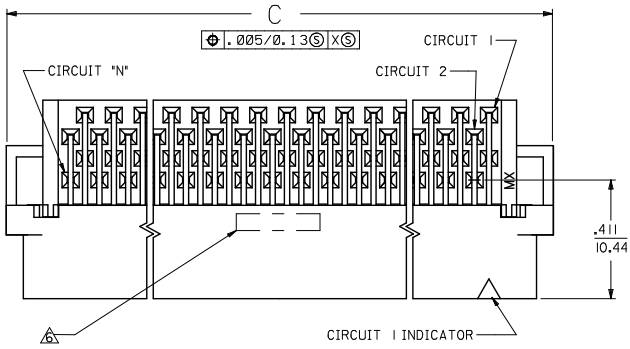

END DETAIL  
OPTION A  
(BOTH ENDS)

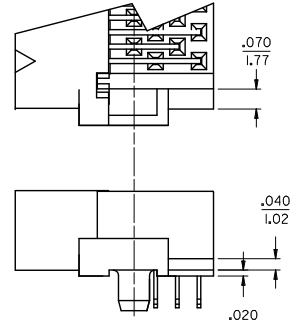

END DETAIL  
OPTION B  
(BOTH ENDS)

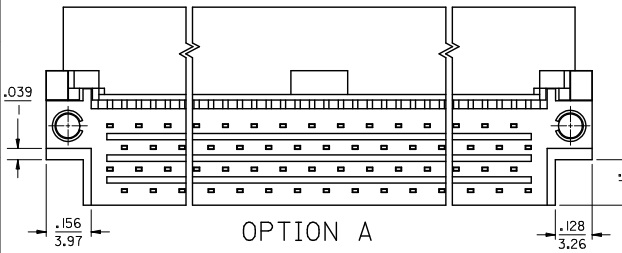

CHANGE MATERIAL IEC NO: 2008/12/19 DRAWING BARRA 2009/01/06 CHKD BARBER 2009/01/06 APPR SMILLER 2009/01/06 DESCRIPTION REV	QUALITY SYMBOLS	GENERAL TOLERANCES (UNLESS SPECIFIED)	DIMENSION STYLE	SCALE	DESIGN UNITS	THIRD ANGLE PROJECTION
	▽=0 ▽=0	4 PLACES ± --- 3 PLACES ± --- ± .010 2 PLACES ± 0.25 ± --- 1 PLACE ± --- ± --- ANGULAR ± 1/2°	IN/MM DRAWN BY RAN DATE 1993/02/23 CHECKED BY DATE RAN DATE 1993/02/23 APPROVED BY CAB DATE 1993/02/23	4:1	INCH	SALES ASSEMBLY EBBI 50D RIGHT ANGLE PLUG CONNECTOR MOLEX INCORPORATED
	DRAFT WHERE APPLICABLE MUST REMAIN WITHIN DIMENSIONS	SEE TABLE	MATERIAL NO. SDA-71661-2***	DOCUMENT NO.	SHEET NO. 1 OF 2	
			THIS DRAWING CONTAINS INFORMATION THAT IS PROPRIETARY TO MOLEX INCORPORATED AND SHOULD NOT BE USED WITHOUT WRITTEN PERMISSION			

13 12 11 10 9 8 7 6 5 4 3 2 1

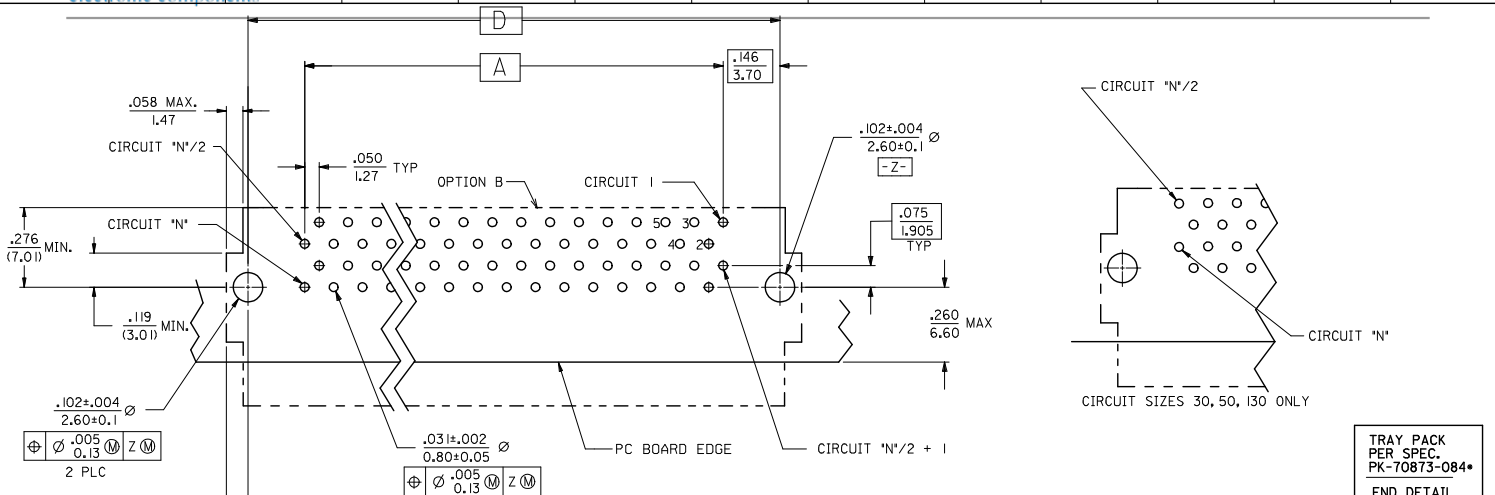

RECOMMENDED PC BOARD LAYOUT  
COMPONENT SIDE

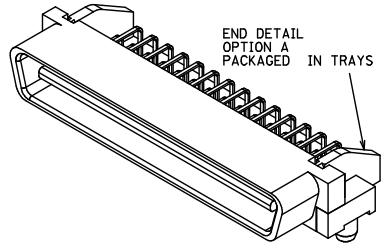

50 CIRCUIT ASSEMBLY SHOWN

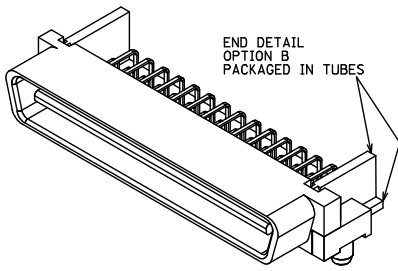

CIRCUIT SIZES 30, 50, 130 ONLY	.125 (3.18)				ITEM NUMBER
	3.491 (88.68)	3.642 (92.50)	3.426 (87.02)	3.200 (81.28)	
	3.241 (82.33)	3.392 (86.15)	3.176 (80.67)	2.950 (74.93)	130
	2.741 (69.63)	2.892 (73.45)	2.676 (67.97)	2.450 (62.23)	120
	2.241 (56.93)	2.392 (60.75)	2.176 (55.27)	1.950 (49.53)	100
	1.941 (49.31)	2.092 (53.13)	1.875 (47.65)	1.650 (41.91)	80
	1.741 (44.23)	1.892 (48.05)	1.676 (42.57)	1.450 (36.83)	68
	1.491 (37.88)	1.642 (41.70)	1.426 (36.22)	1.200 (30.48)	60
	1.241 (31.53)	1.392 (35.35)	1.176 (29.87)	.950 (24.13)	50
	.991 (25.18)	1.142 (29.00)	.925 (23.52)	.700 (17.78)	40
					30
.110 (2.79)	.125 (3.18)				ITEM NUMBER
	3.491 (88.68)	3.642 (92.50)	3.426 (87.02)	3.200 (81.28)	
	3.241 (82.33)	3.392 (86.15)	3.176 (80.67)	2.950 (74.93)	130
	2.741 (69.63)	2.892 (73.45)	2.676 (67.97)	2.450 (62.23)	120
	2.241 (56.93)	2.392 (60.75)	2.176 (55.27)	1.950 (49.53)	100
	1.941 (49.31)	2.092 (53.13)	1.875 (47.65)	1.650 (41.91)	80
	1.741 (44.23)	1.892 (48.05)	1.676 (42.57)	1.450 (36.83)	68
	1.491 (37.88)	1.642 (41.70)	1.426 (36.22)	1.200 (30.48)	60
	1.241 (31.53)	1.392 (35.35)	1.176 (29.87)	.950 (24.13)	50
	.991 (25.18)	1.142 (29.00)	.925 (23.52)	.700 (17.78)	40
					30

TRAY PACK PER SPEC. PK-70873-084\*  
END DETAIL OPTION 'A'

<b>CHANGE MATERIAL</b> EC NO: UCP2009-1234 DRAWN BY: 2008/12/19 CHKD BY: 2009/01/06 APPR: 2009/01/06 DESCRIPTION:	<b>QUALITY SYMBOLS</b> ▽=0 ▽=0	<b>GENERAL TOLERANCES (UNLESS SPECIFIED)</b>		<b>DIMENSION STYLE</b> IN/MM		SCALE 4:1	DESIGN UNITS INCH	THIRD ANGLE PROJECTION
		4 PLACES ± --- INCH 3 PLACES ± --- INCH 2 PLACES ± 0.25 INCH 1 PLACE ± --- INCH	mm INCH	DRAWN BY RAN DATE 1993/02/23	CHECKED BY RAN DATE 1993/02/23	TITLE SALES ASSEMBLY EBBI 50D RIGHT ANGLE PLUG CONNECTOR		
		ANGULAR ± 1/2°	MATERIAL NO. SEE TABLE	APPROVED BY CAB DATE 1993/02/23	MOLEX INCORPORATED	DOCUMENT NO. SDA-71661-2***		
		DRAFT WHERE APPLICABLE MUST REMAIN WITHIN DIMENSIONS	SIZE C	THIS DRAWING CONTAINS INFORMATION THAT IS PROPRIETARY TO MOLEX INCORPORATED AND SHOULD NOT BE USED WITHOUT WRITTEN PERMISSION				