

Excellent Integrated System Limited

Stocking Distributor

Click to view price, real time Inventory, Delivery & Lifecycle Information:

[Molex Connector Corporation](#)
[0716617280](#)

For any questions, you can email us directly:

sales@integrated-circuit.com

NOTES:

- 1) MATERIALS:
HOUSING - LIQUID CRYSTAL POLYMER (LCP), GLASS FILLED, UL94V-0, COLOR: BLACK
TERMINALS - COPPER ALLOY
- 2) TERMINAL FINISH:
30 MICROINCH/0.76 MICROMETER MINIMUM GOLD IN CONTACT AREA AND 50 MICROINCH/L27 MICROMETER MINIMUM TIN IN TAIL AREA OVER NICKEL UNDERPLATE OVERALL.
- 3) ASSEMBLY MATES WITH MOLEX PART NUMBER 71660-7***. CONFORMS TO PRODUCT SPECIFICATION PS-71660.
- 4) RECOMMENDED P.C. BOARD THICKNESS IS .062/1.6 MILLIMETER.
- 5) FOUR DIGIT DATE CODE TO BE LOCATED ON SURFACE AS SHOWN.
- 6) PRODUCT PACKAGED PER SPECIFICATION PK-71660.

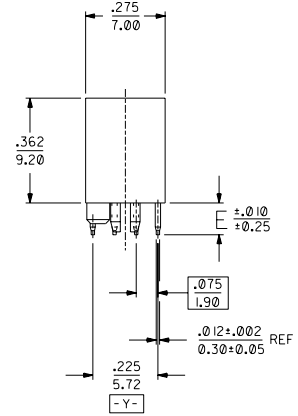
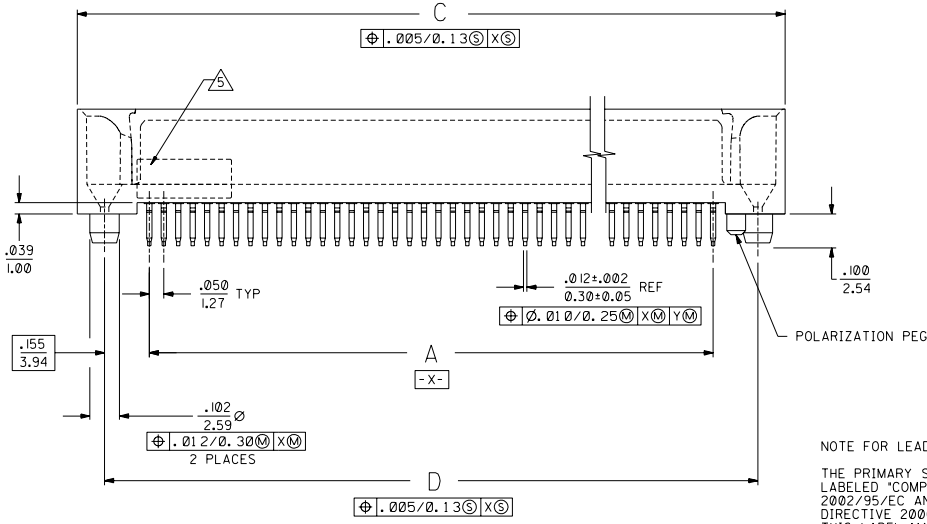
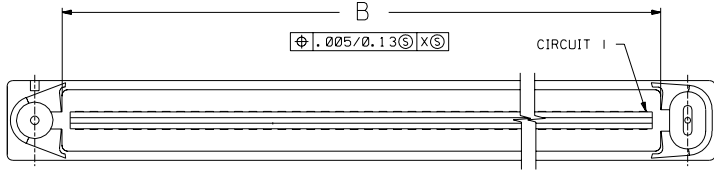

NOTE FOR LEAD FREE CONVERSION:

THE PRIMARY SHIPPING CARTON WILL BE LABELED "COMPLIANT TO ROHS DIRECTIVE 2002/95/EC AND ELV ANNEX II OF DIRECTIVE 2000/53/EC". CARTONS WITHOUT THIS LABEL MAY CONTAIN PRODUCT WITH LEAD.

L	LEAD FREE CONV PER ECN UCP2004-2096 RKADAMS 04/04/26
K	REVISOR PER ECN U71314 ACHAMMER 97-4-28
J	REVISOR PER ECN U70133 ACHAMMER 96-8-7
I	REVISOR PER ECN U51477 7-3-96 DGA
H	REVISOR PER ECN U51278 5-2-96 DGA
G	REVISOR PER ECN U60641 11-28-95 DMS
F	REVISOR PER ECN U60564 11-8-95 RAN
E	REVISOR PER ECN U50229 9-23-94 RAN
D	REVISOR PER ECN U50090 8-30-94 RAN
C	REVISOR PER ECN U40506 4-15-94 RAN
B	REVISOR PER ECN U40305 3-4-94 RAN
A	INITIAL RELEASE PER ECN U31532 12-15-93 RAN
I	PRELIMINARY 11-17-93 RAN

2	K	I
I	L	I
MFG.	SH.	REV.
LTR.	REVISIONS	

DIMENSIONS SHOWN (METRIC) INCH (UNLESS OTHERWISE SPECIFIED TOLERANCES ARE AS SHOWN)		REVISE ONLY ON CAD SYSTEM	
± PLACE	± .005	---	
± PLACE	± .01	±	
± PLACE	---	±	
DRAFTING NOTE: DIMENSIONS MUST REMAIN WITHIN DIMENSIONS		PART NO. DATE	
DRG: RAN		FILE NAME	
BY: CAB		SCALE: 4:1	
APP'D: CAB		DATE: 11/17/93	
CAB		C	

TITLE		SALES ASSEMBLY	
EBBI 50D, VERTICAL PLUG		BLIND MATE CONNECTOR	
MOLEX INCORPORATED		SHEET NO. DATE	
1 OF 2		11/17/93	
SEE TABLE		PART NO. DATE	
SDA-71661-7***		FILE NAME	
ST/661X7		SCALE: 4:1	
S81		DATE: 11/17/93	
C		C	

ITEM NUMBER	CKT. ('N')	A	B	C	D	E
71661-7030	30	.700 (17.78)	.820 (20.83)	1.199 (30.45)	1.010 (25.65)	.110 (2.79)
71661-7040	40	.950 (24.13)	1.070 (27.18)	1.449 (36.80)	1.260 (32.00)	
71661-7050	50	1.200 (30.48)	1.320 (33.53)	1.699 (43.15)	1.510 (38.35)	
71661-7060	60	1.450 (36.83)	1.570 (39.88)	1.949 (49.50)	1.760 (44.70)	
71661-7068	68	1.650 (41.91)	1.770 (44.96)	2.149 (54.58)	1.960 (49.78)	
71661-7080	80	1.950 (49.53)	2.070 (52.58)	2.449 (62.20)	2.260 (57.40)	
71661-7100	100	2.450 (62.23)	2.570 (65.28)	2.949 (74.90)	2.760 (70.10)	
71661-7120	120	2.950 (74.93)	3.070 (77.98)	3.449 (87.60)	3.260 (82.80)	
71661-7130	130	3.200 (81.28)	3.320 (84.33)	3.699 (93.95)	3.510 (89.15)	
71661-7230	30	.700 (17.78)	.820 (20.83)	1.199 (30.45)	1.010 (25.65)	.134 (3.40)
71661-7240	40	.950 (24.13)	1.070 (27.18)	1.449 (36.80)	1.260 (32.00)	
71661-7250	50	1.200 (30.48)	1.320 (33.53)	1.699 (43.15)	1.510 (38.35)	
71661-7260	60	1.450 (36.83)	1.570 (39.88)	1.949 (49.50)	1.760 (44.70)	
71661-7268	68	1.650 (41.91)	1.770 (44.96)	2.149 (54.58)	1.960 (49.78)	
71661-7280	80	1.950 (49.53)	2.070 (52.58)	2.449 (62.20)	2.260 (57.40)	
71661-7300	100	2.450 (62.23)	2.570 (65.28)	2.949 (74.90)	2.760 (70.10)	
71661-7320	120	2.950 (74.93)	3.070 (77.98)	3.449 (87.60)	3.260 (82.80)	
71661-7330	130	3.200 (81.28)	3.320 (84.33)	3.699 (93.95)	3.510 (89.15)	

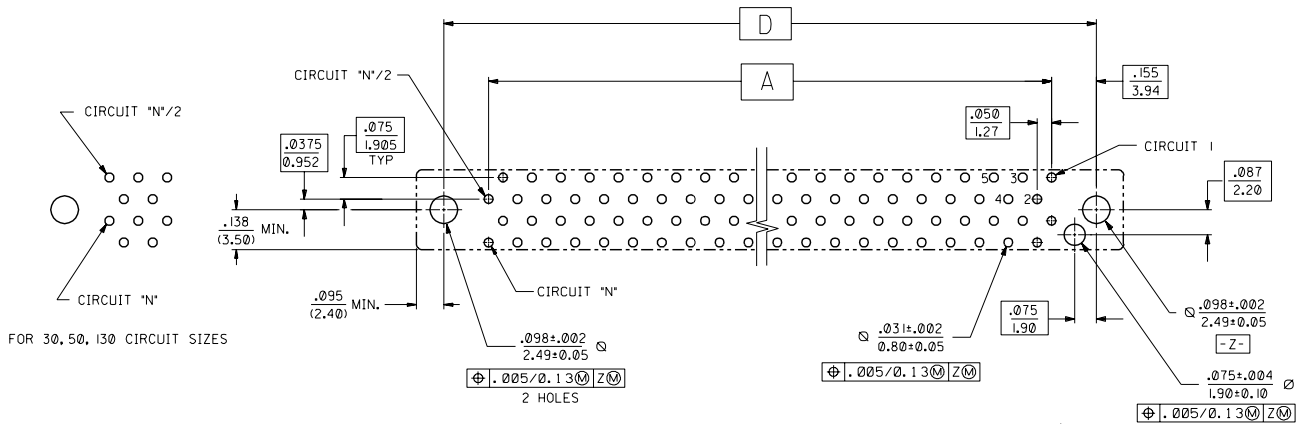

RECOMMENDED PC BOARD LAYOUT COMPONENT SIDE
FOR 40, 60, 68, 80, 100, 120 CIRCUIT SIZES

MFG. SH.		REV.	LTR.	REVISIONS
V = 0		W = 0	REVISE ONLY ON CAD SYSTEM	
TITLE				
SALES ASSEMBLY				
EBBI 50D, VERTICAL PLUG				
BLIND MATE CONNECTOR				
MOLEX INCORPORATED		SHEET NO.	DATE	
USA, ILL.		2	11 / 17 / 93	
PART NO.		DRWG. NO.		
SEE TABLE		SDA-71661-7***		
DRWG. BY: RAN	CHKD. BY: RAN	FILE NAME: 0716617280		
APPD. BY: CAB	SCALE: 4:1	DATE: 07/93		