

Excellent Integrated System Limited

Stocking Distributor

Click to view price, real time Inventory, Delivery & Lifecycle Information:

[Molex Connector Corporation](#)
[0731750020](#)

For any questions, you can email us directly:

sales@integrated-circuit.com

MATERIALS AND FINISHES:

BODY, CLAMP BODY, CLAMP, NUT, C'NUT, WASHER: BRASS
PLATED: NICKEL

CENTER/INTERMEDIATE CONTACT: BRASS
PLATED: GOLD

INSULATOR: TEFLON

SPRING WASHER: BeCu
PLATED: NICKEL

GASKET: SILICONE RUBBER

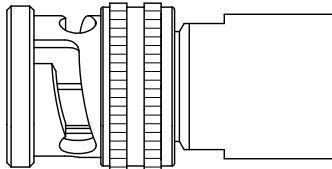
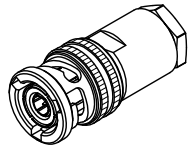
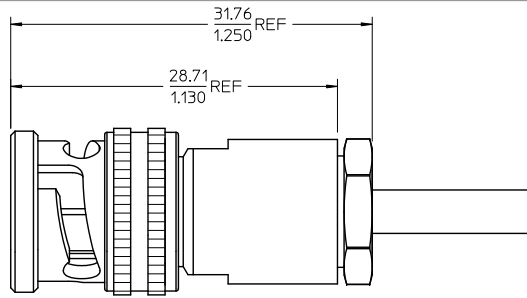

FRONT BODY

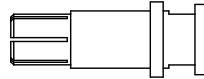

INTERMEDIATE CONTACT



FRONT INSULATOR

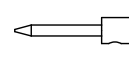

CONTACT



REAR INSULATOR

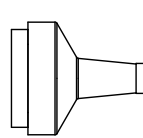

CLAMP BODY/INS

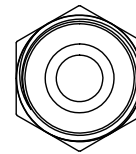

CLAMP/NUT

73175-0021	73175-0020, ONE PER BAG
73175-0020	BULK
PART NO.	PACKAGING

MIL-STD-348A, FIG. 201-1	INTERFACE
SPECIFICATION	DESCRIPTION

CHG: ADDED ASSY INSTRUCTIONS AND SHEET 2
EC NO: URF2012-0430 2012/01/18
DRAWN: SHH 2012/01/19
CHKD: JEE 2012/01/19
APPR: JMENER 2012/01/19

QUALITY SYMBOLS	GENERAL TOLERANCES (UNLESS SPECIFIED)	DIMENSION STYLE	SCALE	DESIGN UNITS	THIRD ANGLE PROJECTION
▽=0	mm INCH	MM/IN		METRIC	
▽=0	4 PLACES ± --- ± ---	DRAWN BY DATE	SSS 2003/12/19	TITLE	TRIAX PLUG STR 3 LUG
	3 PLACES ± --- ± ---	CHECKED BY DATE	TEF 2003/12/19		TWC-78-1 TWINAX CABLE
	2 PLACES ± --- ± ---	APPROVED BY DATE	GMH 2003/12/17		TRIAX-PC
	1 PLACE ± --- ± ---				
	ANGULAR ± 2 °	MATERIAL NO.		DOCUMENT NO.	MOLEX INCORPORATED
	DRAFT WHERE APPLICABLE MUST REMAIN WITHIN DIMENSIONS	SEE TABLE		SD-73175-002	SHEET NO. 1 OF 2
		THIS DRAWING CONTAINS INFORMATION THAT IS PROPRIETARY TO MOLEX INCORPORATED AND SHOULD NOT BE USED WITHOUT WRITTEN PERMISSION			

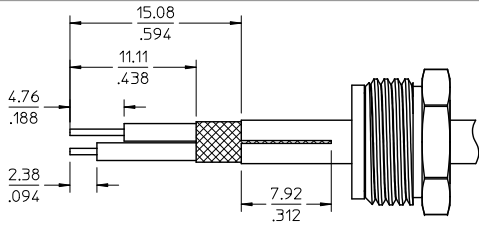

1. SLIDE CLAMP NUT ASSEMBLY ON CABLE. STRIP/SPLIT CABLE TO DIMENSION SHOWN. SLIGHTLY TIN CONDUCTORS

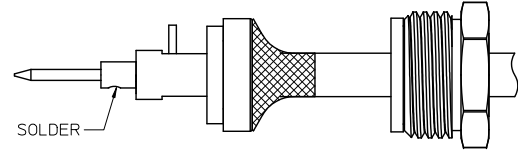

4. SLIDE CONTACT OVER CENTER CONDUCTOR AND SEAT AGAINST REAR INSULATOR. SOLDER CONTACT IN PLACE

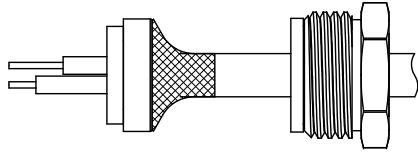

2. FLARE BRAID AND PUSH CLAMP BODY/INS ASSEMBLY UNDER BRAID UNTIL BRAID IS FLUSH WITH EDGE OF CONE

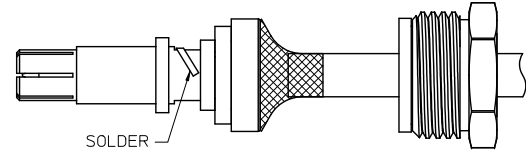

5. SLIDE FRONT INSULATOR OVER CONTACT. SLIDE INTERMEDIATE CONTACT OVER FRONT INSULATOR UNTIL BOTTOMS. WRAP BENT CONDUCTOR OVER INTERMEDIATE CONTACT AND SOLDER

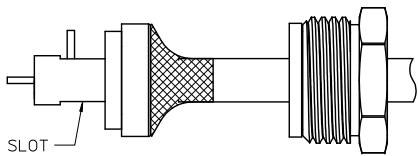

3. BEND LONGER STRIPPED CONDUCTOR AT ANGLE OF 90° AND POSITION OTHER CONDUCTOR AT CENTER OF CABLE. SLIDE REAR INSULATOR WITH SHORTER CONDUCTOR SLIDING IN HOLE AND BENT CONDUCTOR SLIDING THROUGH SLOT

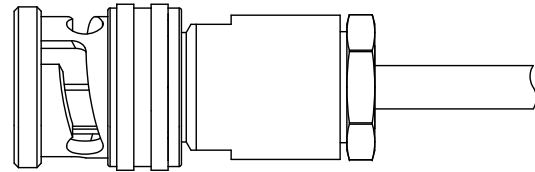

6. SLIDE CLAMP NUT ASSEMBLY FORWARD ONTO TAPERED BRAID. INSERT ASSEMBLY INTO FRONT BODY AND TIGHTEN NUT. TORQUE TO 2.82-3.95 N-m(25-35 IN-LB)

CHG: SEE SHEET 1 EC NO: URF-2012-0430 DRWNS:SHAH 2012/01/18 CHKD:JEE 2012/01/19 APPR:JWENER 2012/01/19	QUALITY SYMBOLS ▽=0 ▽=0	GENERAL TOLERANCES (UNLESS SPECIFIED)		DIMENSION STYLE MM/IN		SCALE	DESIGN UNITS	THIRD ANGLE PROJECTION
		mm	INCH	DRAWN BY	DATE	TITLE	METRIC TRIAX PLUG STR 3 LUG TWC-78-1 TWINAX CABLE TRIAX-PC	MOLEX INCORPORATED
		4 PLACES ± ---	± ---	SSS	2003/12/19			
		3 PLACES ± ---	± ---	CHECKED BY	DATE			
2 PLACES ± ---	± ---	TEF	2003/12/19					
1 PLACE ± ---	± ---	APPROVED BY	DATE					
		GMH	2003/12/17					
		ANGULAR ± 2 °		MATERIAL NO.	DOCUMENT NO.	SHEET NO.		
				SEE SHEET 1	SD-73175-002	2 OF 2		
DRAFT WHERE APPLICABLE MUST REMAIN WITHIN DIMENSIONS				THIS DRAWING CONTAINS INFORMATION THAT IS PROPRIETARY TO MOLEX INCORPORATED AND SHOULD NOT BE USED WITHOUT WRITTEN PERMISSION				