

Excellent Integrated System Limited

Stocking Distributor

Click to view price, real time Inventory, Delivery & Lifecycle Information:

[Molex Connector Corporation](#)
[0580888010](#)

For any questions, you can email us directly:

sales@integrated-circuit.com

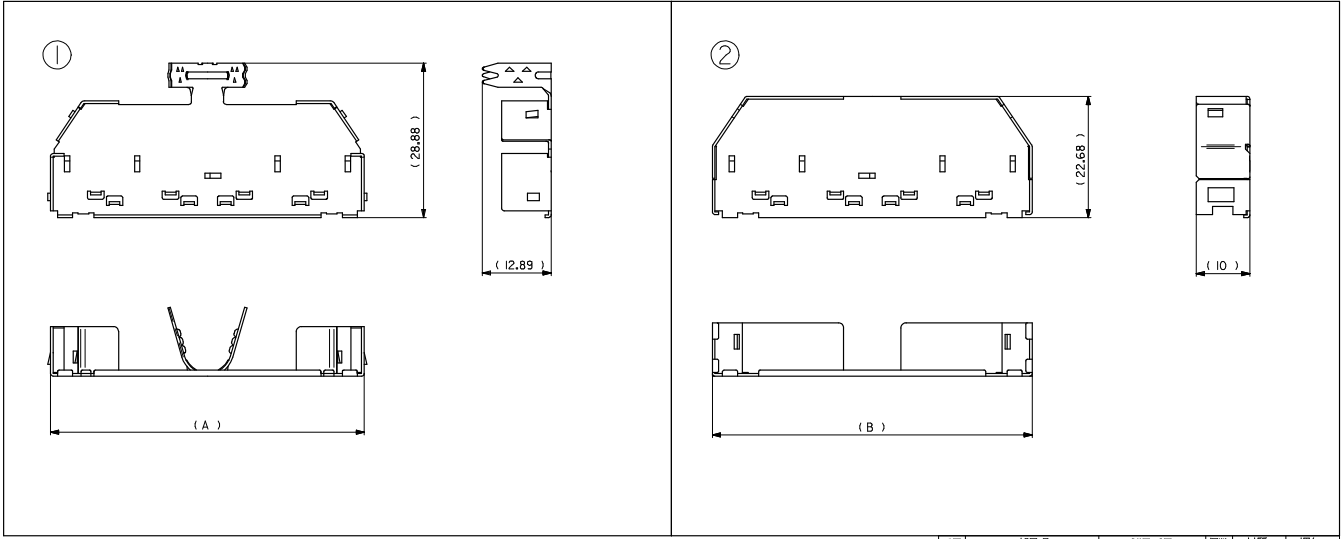

番号 NO.	部品名 PART NAME	製品番号 ENG. NO.	倍率 QVAL	材質 MATERIAL	梱包 PACKAGE
①	シェル ボディ SHELL BODY	59719-**-00	1	SPCE	トレー TRAY
②	シェル カバー SHELL COVER	59825-**-00	1	SPCE	トレー TRAY

59.88	58.72	59825-8000	59719-8000	58088-8010	80
B	A	シェル カバー SHELL COVER ENG. NO.	シェル ボディ SHELL BODY ENG. NO.	ENG. NO.	CKT.

REVISED EC NO. 12008-4146 DRAWN BY S. ITO CHKD: HARUYAMA APPR: MIKITA 2008/06/30 2008/06/30 2008/07/17	GENERAL TOLERANCES (UNLESS SPECIFIED)	DIMENSION STYLE MM ONLY	SCALE 1:1	DESIGN UNITS METRIC	THIRD ANGLE PROJECTION
	10 UNDER ±0.2	DRAWN BY S. ITO	DATE '95/11/17	TITLE	1.27 SCREW LOCK I/O HARNESS (PACKAGE)
	10 OVER 30 UNDER ±0.25	CHECKED BY Y. ITO	DATE	APPROVED BY H. IKESUGI	DATE
	30 OVER ±0.3	ANGULAR ±3 °	MATERIAL NO.	DOCUMENT NO.	SHEET NO.
	DRAFT WHERE APPLICABLE MUST REMAIN WITHIN DIMENSIONS	SEE TABLE	SD-58088-001	1 OF 1	1 OF 1