

Excellent Integrated System Limited

Stocking Distributor

Click to view price, real time Inventory, Delivery & Lifecycle Information:

[Molex Connector Corporation](#)
[0734040570](#)

For any questions, you can email us directly:

sales@integrated-circuit.com

MATERIALS AND FINISHES:

BODY: ZINC/BRASS
PLATED NICKEL

CENTER CONTACT: BRASS
PLATED GOLD

OUTER CASING: PLASTIC
KEYING: SEE TABLE
COLOR: SEE TABLE

INSULATOR: TEFLON

RETENTION SPECIFICATION:
THE FAKRA CONNECTOR WILL WITHSTAND
A LONGITUDINAL FORCE OF 110 N(24.75 LBS)

FAKRA
CONNECTOR
KEYING
CODE D

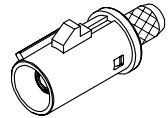
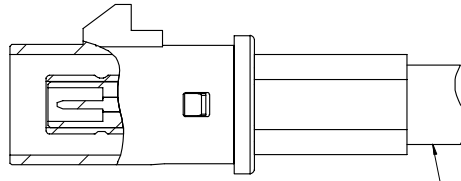

RG58 CABLE

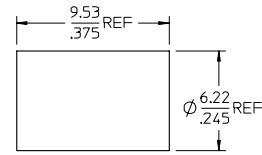
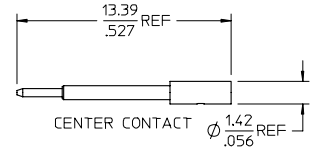
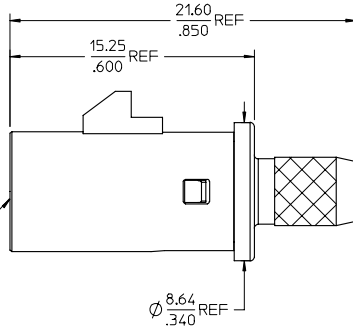

CRIMP TUBE

AS-89678-750	ASSEMBLY INSTRUCTIONS
MIL-STD-348A, FIG. 311.1	INTERFACE
SPECIFICATION	DESCRIPTION

CHG: REDREW IN SD
CHANGED ALL DIMS
FROM IN/MM TO MM/IN
ADDED P/N
73404-0581 THRU
-0583
ADDED RIGHT VIEW
TO SHEET 1
ADDED SHEET 2
AND 3

EC NO: URF2007-0200
DRAWN: LASHARY 2006/11/10
CHKD: SHAH 2006/11/10
APPR: IMIENER 2006/11/10

QUALITY
SYMBOLS
▽=0
∇=0

GENERAL TOLERANCES (UNLESS SPECIFIED)	
	MM/IN
4 PLACES	± .005 / ± .0008
3 PLACES	± .004 / ± .0006
2 PLACES	± .003 / ± .0004
1 PLACE	± .002 / ± .0003
ANGULAR ± 2 °	

DRAWN BY	DATE	TITLE
SSS	2001/07/20	SMB JACK, STR, RG58, FAKRA, 50 OHMS SMB-JC
CHECKED BY	DATE	
TEF	2001/07/20	
APPROVED BY	DATE	
GMH	2001/07/20	

SCALE	DESIGN UNITS	THIRD ANGLE PROJECTION
	METRIC	☉
MOLEX INCORPORATED		
MATERIAL NO.	DOCUMENT NO.	SHEET NO.
SEE SHEET 3	SD-73404-057	1 OF 3

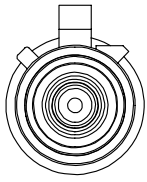

CODE - A

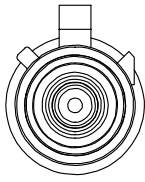

CODE - B

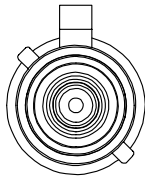

CODE - C

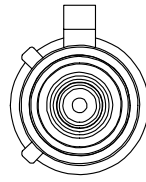

CODE - D

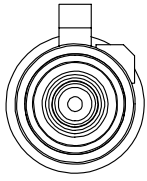

CODE - E

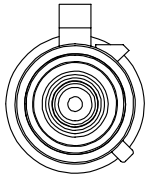

CODE - F

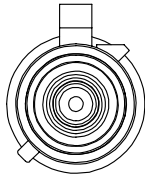

CODE - G

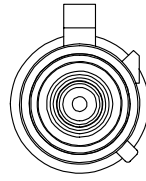

CODE - H

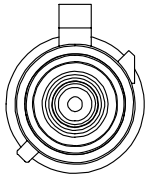

CODE - I

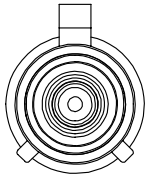

CODE - K

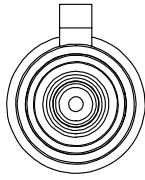

CODE - Z

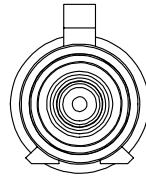

CODE - L

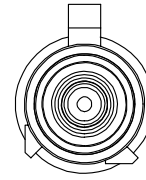

CODE - M

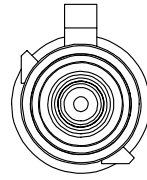

CODE - N

CHG: SEE SHEET 1 EC NO: URF2007-0200 DRAWN BY: DR.MITLAHERY 2006/11/10 CHKD BY: CH.KOUSHAH 2006/11/10 APPR: JWIENER 2006/11/10 A2	QUALITY SYMBOLS ▽=0 ▽=0	GENERAL TOLERANCES (UNLESS SPECIFIED)		DIMENSION STYLE MM/IN	SCALE	DESIGN UNITS METRIC	THIRD ANGLE PROJECTION		
		4 PLACES ± --- ± ---	3 PLACES ± --- ± ---	2 PLACES ± --- ± ---	1 PLACE ± --- ± ---	DRAWN BY: SSS DATE: 2001/07/20	TITLE: SMB JACK, STR, RG58, FAKRA, 50 OHMS, SMB-JC		
		ANGULAR ± 2 °				CHECKED BY: TEF DATE: 2001/07/20	APPROVED BY: GMH DATE: 2001/07/20		
		DRAFT WHERE APPLICABLE MUST REMAIN WITHIN DIMENSIONS		MATERIAL NO. SEE SHEET 3	DOCUMENT NO. SD-73404-057	MOLEX INCORPORATED		SHEET NO. 2 OF 3	

N	PASTEL GREEN	73404-0583
M	PASTEL ORANGE	73404-0582
L	CARMINE RED	73404-0581
Z	WATER BLUE	73404-0580
K	CURRY YELLOW	73404-0579
I	BEIGE	73404-0578
H	VIOLET	73404-0577
G	GRAY	73404-0576
F	BROWN	73404-0575
E	GREEN	73404-0574
D	BORDEAUXVIOLET	73404-0573
C	BLUE	73404-0572
B	CREAM WHITE	73404-0571
A	BLACK	73404-0570
KEYING CODE	COLOR	PART NO.

CHG: SEE SHEET 1 ILC NO: URF2007-0200 DRW: TELANHERY 2006/11/10 CHK: KOS SHAH 2006/11/10 APPR: JWIENER 2006/11/10 A2	QUALITY SYMBOLS ▽=0 ▽=0	GENERAL TOLERANCES (UNLESS SPECIFIED)		DIMENSION STYLE MM/IN	SCALE	DESIGN UNITS METRIC	THIRD ANGLE PROJECTION		
		4 PLACES ±--- ±---	3 PLACES ±--- ±---	2 PLACES ±--- ±---	1 PLACE ±--- ±---	DRAWN BY SSS	DATE 2001/07/20	TITLE SMB JACK, STR, RG58, FAKRA, 50 OHMS SMB-JC	
		ANGULAR ± 2 °				CHECKED BY TEF	DATE 2001/07/20	MOLEX INCORPORATED	
		DRAFT WHERE APPLICABLE MUST REMAIN WITHIN DIMENSIONS				APPROVED BY GMH	DATE 2001/07/20	MATERIAL NO. SEE TABLE	DOCUMENT NO. SD-73404-057
				SIZE C	THIS DRAWING CONTAINS INFORMATION THAT IS PROPRIETARY TO MOLEX INCORPORATED AND SHOULD NOT BE USED WITHOUT WRITTEN PERMISSION				
						SHEET NO. 3 OF 3			