



Distributor of Molex Connector Corporation: Excellent Integrated System Limited
Datasheet of 0743203009 - Connector Receptacle DVI-A 12 Position Through Hole, Vertical

Contact us: sales@integrated-circuit.com Website: www.integrated-circuit.com

Excellent Integrated System Limited

Stocking Distributor

Click to view price, real time Inventory, Delivery & Lifecycle Information:

[Molex Connector Corporation](#)
[0743203009](#)

For any questions, you can email us directly:

sales@integrated-circuit.com

Contact us: sales@integrated-circuit.com Website: www.integrated-circuit.com

74320

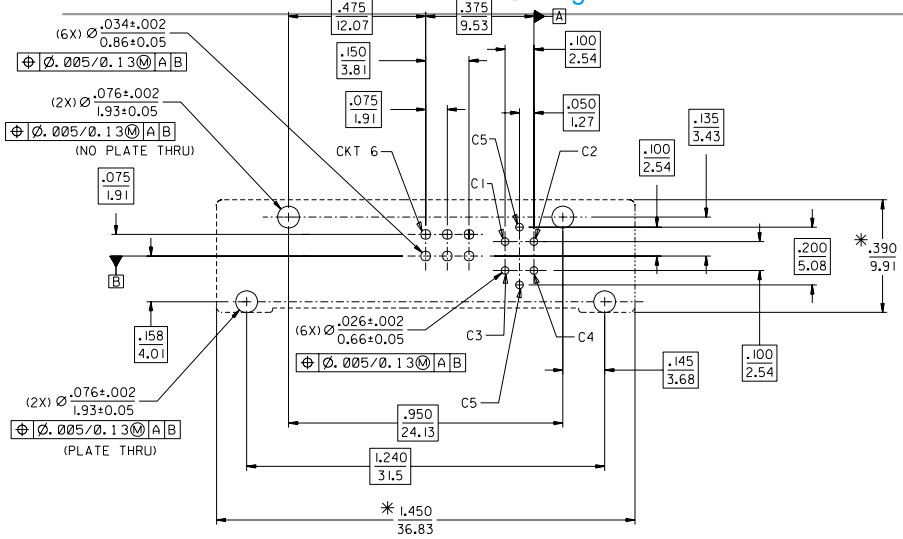

RECOMMENDED PCB LAYOUT

* THESE DIMENSIONS REPRESENT CONNECTOR OVERLAY ON PCB.

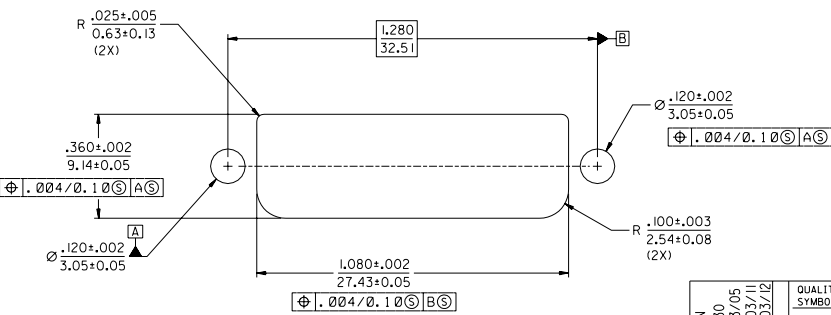

RECOMMENDED PANEL CUT-OUT

PANEL THICKNESS: 030/0.76 - .040/1.02

PLATING OPTIONS:

PLATING OPTION #1:

- OUTER SHIELD -- 150µ/3.75µm MIN. BRIGHT TIN OVER 50µ/1.27µm MIN. NICKEL OVER COPPER FLASH.
- .075"/1.91mm CONTACTS -- 30µ/0.75µm MIN. SELECT GOLD AND 100µ/2.50µm MIN. SELECT PURE TIN OVER 50µ/1.27µm MIN. NICKEL OVERALL.
- .100"/2.54mm CONTACTS -- 30µ/0.75µm MIN. SELECT GOLD AND 100µ/2.50µm MIN. SELECT PURE TIN OVER 50µ/1.27µm MIN. NICKEL OVERALL.
- MICROCROSS GROUND -- 30µ/0.75µm MIN. SELECT GOLD AND 100µ/2.50µm MIN. SELECT PURE TIN OVER 50µ/1.27µm MIN. NICKEL OVERALL.

PLATING OPTION #2:

- OUTER SHIELD -- 150µ/3.75µm MIN. BRIGHT TIN OVER 50µ/1.27µm MIN. NICKEL OVER COPPER FLASH.
- .075"/1.91mm CONTACTS -- SELECT GOLD FLASH AND 100µ/2.50µm MIN. SELECT PURE TIN OVER 50µ/1.27µm MIN. NICKEL OVERALL.
- .100"/2.54mm CONTACTS -- SELECT GOLD FLASH AND 100µ/2.50µm MIN. SELECT PURE TIN OVER 50µ/1.27µm MIN. NICKEL OVERALL.
- MICROCROSS GROUND -- 30µ/0.75µm MIN. SELECT GOLD AND 100µ/2.50µm MIN. SELECT PURE TIN OVER 50µ/1.27µm MIN. NICKEL OVERALL.

INDICATION	EC NO. SH2004-0130	QUALITY SYMBOLS	GENERAL TOLERANCES: (UNLESS SPECIFIED):		SCALE	DESIGN UNITS	THIRD ANGLE PROJECTION	DIMENSIONS:		SHT	REV	
	DRWN: DXUE 04/03/05		CHK: HARVEY 04/03/11	APPROVAL: 04/03/12	mm	INCH		4 ± 1	mm			mm ONLY
DESCRIPTION	MAJOR	CRITICAL	4 PLACES ±0.1		DRAWN BY & DATE		TITLE: DVI - A VERTICAL RECEPTACLE CONNECTOR					
	MINOR		3 PLACES ±0.1	KSMITH 99/07/15								
REV	D	V	2 PLACES ±0.25		CHECKED BY & DATE		MOLEX INCORPORATED					
			1 PLACE ±0.25		DSCHMIDG 99/07/15							
DRAFT WHERE APPLICABLE MUST REMAIN WITHIN DIMENSIONS			ANGULAR ± 1/2°		APPROVED BY & DATE		MATERIAL NO.		DRAWING NO.		SHEET NO.	
					RNELSON 99/07/15		SD74320016.S02		SD-74320-016		2	
THIS DRAWING CONTAINS INFORMATION THAT IS PROPRIETARY TO MOLEX INCORPORATED AND SHOULD NOT BE USED WITHOUT WRITTEN PERMISSION.												