

## Excellent Integrated System Limited

Stocking Distributor

Click to view price, real time Inventory, Delivery & Lifecycle Information:

[Molex Connector Corporation](#)  
[0460140306](#)

For any questions, you can email us directly:  
[sales@integrated-circuit.com](mailto:sales@integrated-circuit.com)

13

12

11

10

9

8

7

6

5

4

3

2

1

J

J

I

I

H

H

G

G

F

F

E

E

D

D

C

C

B

B

A

A

- NOTES:
- MATERIALS:  
HOUSING: 1 - NYLON 6/6, UNFILLED UL 94V-2, COLOR: NATURAL  
2 - NYLON 6/6, UNFILLED UL 94V-0, COLOR: NATURAL  
TERMINALS: COPPER ALLOY
  - TERMINAL PLATING:  
1 - .000100/(.00254) MIN. MATTE TIN OVER  
.000050/(.00127) MIN. NICKEL OVERALL  
2 - .000030/(.00076) MIN. SELECT GOLD AND  
.000100/(.00254) MIN. SELECT MATTE TIN OVER  
.000050/(.00127) MIN. NICKEL OVERALL
  - PRODUCT SPECIFICATION: PS-45750-001
  - PACKAGING: TRAY PACK PER PK-5566-002
  - PART MATES WITH WITH MINI-FIT JR. RECEPTACLE #5557.
  - PART IS NOT DESIGNED FOR CURRENT SHARING.
  - PARTS TO HAVE 'HCS+' MARKING.
  - PART CONFORMS TO CLASS 'B' REQUIREMENTS OF COSMETIC SPECIFICATION PS-45499-002.

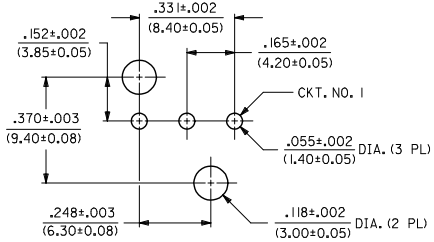
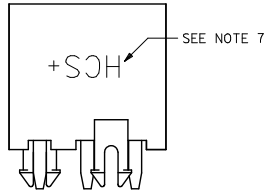
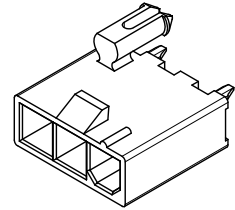
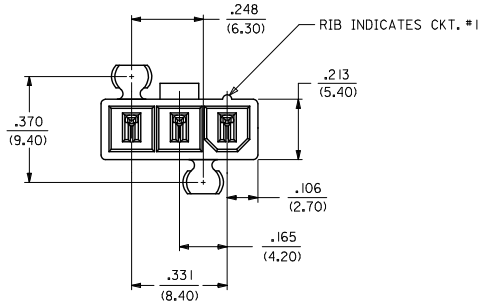
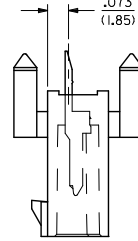
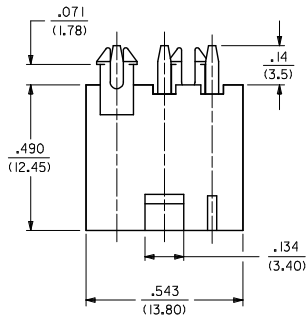

RECOMMENDED HOLE LAYOUT FOR  
.070/(1.78) MAX. THICK P.C. BOARD

UPDATE TOLERANCES EC NO: UCP2015-0706 DRAWN BY: WANGJUNEN CHKD: BELL APPROVED BY: SMITH DATE: 2012/08/20 DATE: 2012/08/20 DATE: 2012/09/05	QUALITY SYMBOLS ∇=0 ∇=0 ∇=0	GENERAL TOLERANCES (UNLESS SPECIFIED)		DIMENSION STYLE IN/MM		SCALE 4:1	DESIGN UNITS METRIC	THIRD ANGLE PROJECTION	
		4 PLACES ± --- ± --- 3 PLACES ± --- ± .010 2 PLACES ± 0.25 ± .020 1 PLACE ± 0.50 ± --- 0 PLACE ± ±	DRAWN BY: T GREGORI CHECKED BY: J COMERC I APPROVED BY: F SMITH DATE: 2006/04/27 DATE: 2006/04/27 DATE: 2010/04/09	TITLE VERTICAL HEADER ASSEMBLY SINGLE ROW, 3 CKT MINI-FIT PLUS HCS SERIES			MATERIAL NO. SD-46014-003		DOCUMENT NO. SD-46014-003
DRAFT WHERE APPLICABLE MUST REMAIN WITHIN DIMENSIONS		SEE CHART		THIS DRAWING CONTAINS INFORMATION THAT IS PROPRIETARY TO MOLEX INCORPORATED AND SHOULD NOT BE USED WITHOUT WRITTEN PERMISSION					

12

11

10

9

8

7

6

5

4

3

2

1