

Excellent Integrated System Limited

Stocking Distributor

Click to view price, real time Inventory, Delivery & Lifecycle Information:

[Molex Connector Corporation](#)
[0709821002](#)

For any questions, you can email us directly:

sales@integrated-circuit.com

PART NUMBER	DIMINSION "A"	INTERNAL THREAD	EXTERNAL THREAD	FINISH
70982-1002	.394±.020	4-40 UNC	M3	TIN PLATE

NOTE:

COMPONENTS WILL BE KITTED IN PVC BAGS PER THE FOLLOWING BILL OF MATERIALS:

BILL OF MATERIALS		
ITEM #	QTY	DESCRIPTION
1	2	HEX. LOCK SCREW
2	4	WASHER
3	2	LOCKWASHER
4	2	NUT

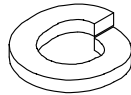
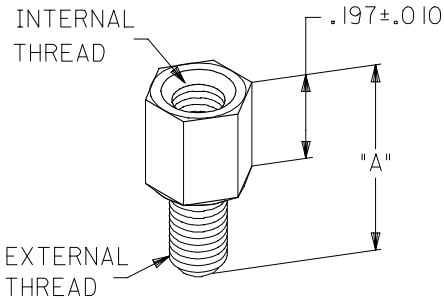

ITEM #3

ITEM #1

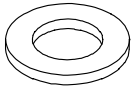

ITEM #2

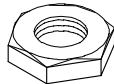

ITEM #4

REMOVED 70982-1006 EC NO: UCP2006-2579 2006/09/25 DRWNS/BARRA CHKD/BARKER 2006/10/02 APPR:SMILLER 2006/10/03	QUALITY SYMBOLS	GENERAL TOLERANCES (UNLESS SPECIFIED)	DIMENSION STYLE INCH ONLY	SCALE 4:1	DESIGN UNITS INCH	THIRD ANGLE PROJECTION																												
	$\nabla=0$ $\sphericalangle=0$	<table border="1"> <tr> <th></th> <th>mm</th> <th>INCH</th> </tr> <tr> <td>4 PLACES</td> <td>± .004</td> <td>± .001</td> </tr> <tr> <td>3 PLACES</td> <td>± .005</td> <td>± .001</td> </tr> <tr> <td>2 PLACES</td> <td>± .007</td> <td>± .001</td> </tr> <tr> <td>1 PLACE</td> <td>± .010</td> <td>± .001</td> </tr> </table>		mm	INCH	4 PLACES	± .004	± .001	3 PLACES	± .005	± .001	2 PLACES	± .007	± .001	1 PLACE	± .010	± .001	<table border="1"> <tr> <td>DRAWN BY</td> <td>DATE</td> </tr> <tr> <td>MOS</td> <td>1992/09/14</td> </tr> <tr> <td>CHECKED BY</td> <td>DATE</td> </tr> <tr> <td>OSULL IVAN</td> <td>1992/09/14</td> </tr> <tr> <td>APPROVED BY</td> <td>DATE</td> </tr> <tr> <td>BIXLER</td> <td>1992/09/14</td> </tr> </table>	DRAWN BY	DATE	MOS	1992/09/14	CHECKED BY	DATE	OSULL IVAN	1992/09/14	APPROVED BY	DATE	BIXLER	1992/09/14	TITLE			
		mm	INCH																															
	4 PLACES	± .004	± .001																															
3 PLACES	± .005	± .001																																
2 PLACES	± .007	± .001																																
1 PLACE	± .010	± .001																																
DRAWN BY	DATE																																	
MOS	1992/09/14																																	
CHECKED BY	DATE																																	
OSULL IVAN	1992/09/14																																	
APPROVED BY	DATE																																	
BIXLER	1992/09/14																																	
DESCRIPTION	ANGULAR ±1/2°	MATERIAL NO.	MOLEX MOLEX INCORPORATED	DOCUMENT NO.																														
REV	DRAFT WHERE APPLICABLE MUST REMAIN WITHIN DIMENSIONS	SEE TABLE	SDMS-70982-****	SHEET NO.	1 OF 1																													