

Excellent Integrated System Limited

Stocking Distributor

Click to view price, real time Inventory, Delivery & Lifecycle Information:

[Molex Connector Corporation](#)
[0879209146](#)

For any questions, you can email us directly:

sales@integrated-circuit.com

10 9 8 7 6 5 4 3 2 1

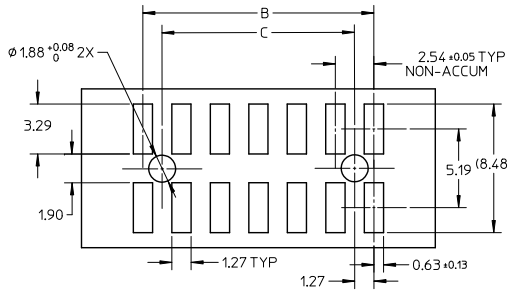
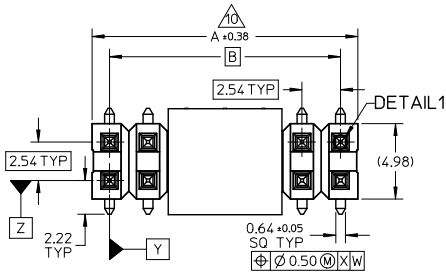

RECOMMENDED PCB LAYOUT

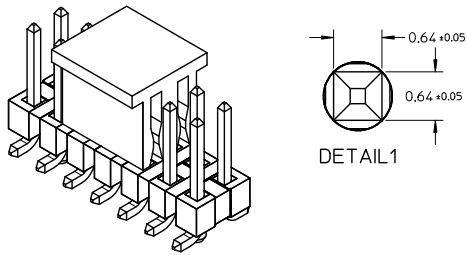
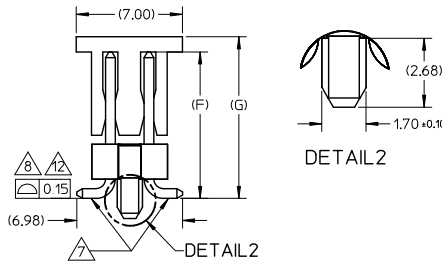
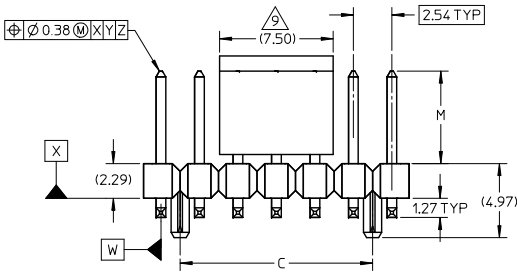

NOTES:

- MATERIAL:
HSG: LCP, GLASS-FILLED, UL94V-0, COLOR: BLACK
CAP: NYLON, GLASS-FILLED, UL94V-0, COLOR: BLACK
PIN: 0.64MM SQ, COPPER ALLOY
- PLATING TYPE:
(1) 0.38µm MIN. GOLD PLATE ON CONTACT AND 2.00µm MIN. TIN ON SOLDER TAIL OVER 1.25µm MIN. NICKEL OVERALL.
(2) 0.75µm MIN. GOLD PLATE ON CONTACT AND 2.00µm MIN. TIN ON SOLDER TAIL OVER 1.25µm MIN. NICKEL OVERALL.
(3) 2.50µm MIN. TIN OVERALL 1.25µm MIN. NICKEL OVERALL
- PACKAGING TYPE: SEE TABLE
- PCB THICKNESS 1.60+/-0.10mm
- PRODUCT SPECIFICATION: PS-87920-019
- WAFER TO BE FLAT WITHIN 0.003 mm/mm
- BEND DEPRESSION IS ACCEPTED SO LONG AS IT DOES NOT AFFECT THE OVERALL COPLANARITY OF TAIL
- COPLANARITY IS TO BE MEASURED BY RESTING THE SOLDER TAIL ON A FLAT SURFACE
- CAP LOCATION IS CENTERED ALONG THE MATING ENDS AS SHOWN. TOP SURFACE OF CAP TO BE FLAT FOR THE PURPOSE OF PICK & PLACE BY VACUUM SUCTION NOZZLE
- IRREGULAR CIRCUIT CUTOFF WITHIN BREAKAWAY SECTION IS PERMISSIBLE. CUTTING OR CHIPPING OF THE MAIN BODY IS NOT ACCEPTABLE
- PARTS ARE NOT STACKABLE ON 2.54 CENTER
- COPLANARITY FOR SIZES UP TO 40 IS 0.15MM.
- THE ABOVE CKT 14 IS FOR ILLUSTRATION PURPOSE ONLY
- TUBE LENGTH IS 560MM PER STANDARD
- CKT 4 & 6 TO BE PACKED IN BULK/TRAY PACKING
- PACKAGING SPECIFICATION: TUBE: PK-89990-478
TAPE & REEL : PK-89990-479

ADD P/N: 87920-9120 EC NO.: S2011-0043 DRAWN: SKANG CHKD: ATSEE APPR: MLONG	REV D6	DESCRIPTION	QUALITY SYMBOLS	GENERAL TOLERANCES (UNLESS SPECIFIED)		DIMENSION STYLE		SCALE	DESIGN UNITS	THIRD ANGLE PROJECTION
				mm	INCH	MM ONLY	NTS	METRIC		
			√=0	4 PLACES ±---	±---	DRAWN BY	DATE	TITLE		
			√=0	3 PLACES ±---	±---	SKL IM01	2006/02/09	CUSTOM HEADER		
	√=0	2 PLACES ±0.2	±---	CHECKED BY	DATE	HEADER SINGLE WAFER SMT				
	√=0	1 PLACE ±---	±---	PATEY	2006/02/16	MOLEX INCORPORATED				
		ANGULAR ± 3°		APPROVED BY	DATE					
				MLONG	2010/02/08					
				MATERIAL NO.	DOCUMENT NO.					
				SEE TABLE	SD-87920-020					
				SIZE						
				A3						
				THIS DRAWING CONTAINS INFORMATION THAT IS PROPRIETARY TO MOLEX INCORPORATED AND SHOULD NOT BE USED WITHOUT WRITTEN PERMISSION						

9 8 7 6 5 4 3 2 1

10 9 8 7 6 5 4 3 2 1

CIRCUITS POSITION CONFIGURATION

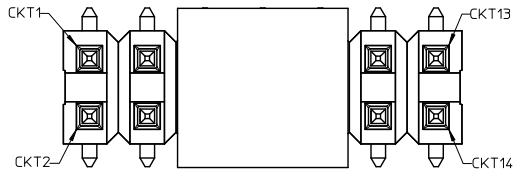

PART PACKED IN TUBE ORIENTATION

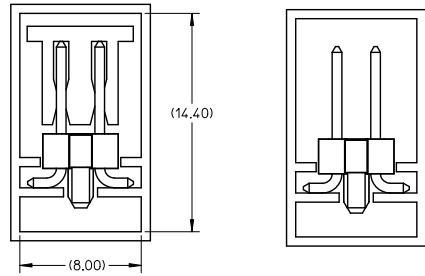

PART WITH PEGS WITH CAP IN TUBE

PART WITH PEGS WITHOUT CAP IN TUBE

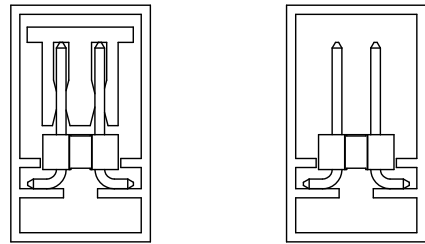

PART WITHOUT PEGS WITH CAP IN TUBE

PART WITHOUT PEGS WITHOUT CAP IN TUBE

ADD P/N: 87920-9120 EC NO: S2011-0043 DRAWN: SKANG CHK: DATSEE APPR: MLONG 2010/07/14 2010/08/02 2010/08/03	QUALITY SYMBOLS √=0 √=0 √=0	GENERAL TOLERANCES (UNLESS SPECIFIED)		DIMENSION STYLE MM ONLY		SCALE NTS	DESIGN UNITS METRIC	THIRD ANGLE PROJECTION	
		4 PLACES ± --- ± ---	3 PLACES ± --- ± ---	2 PLACES ± 0.2 ± ---	1 PLACE ± --- ± ---	ANGULAR ± 3°	DRAWN BY SKLIM01	DATE 2006/02/09	TITLE CUSTOM HEADER 2.54MM PITCH DUAL ROW HEADER SINGLE WAFER SMT
		DRAFT WHERE APPLICABLE MUST REMAIN WITHIN DIMENSIONS	MATERIAL NO. SEE TABLE	APPROVED BY MLONG	DATE 2010/02/08	MOLEX INCORPORATED	DOCUMENT NO. SD-87920-020	SHEET NO. 2 OF 11	
		THIS DRAWING CONTAINS INFORMATION THAT IS PROPRIETARY TO MOLEX INCORPORATED AND SHOULD NOT BE USED WITHOUT WRITTEN PERMISSION							

9 8 7 6 5 4 3 2 1

10 9 8 7 6 5 4 3 2 1

CKT	F	P1	W
04	7.50	12.00	16.00

THIS TYPE OF CARRIER TAPE IS FOR CKT SIZE 04 ONLY

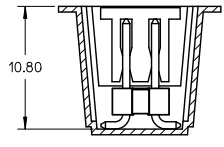
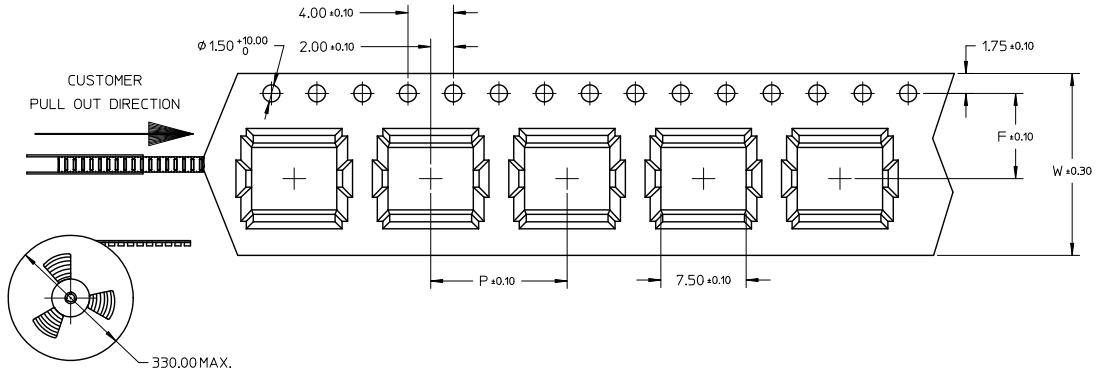

NOTES:

1. LEADER AND TRAILER TAPE

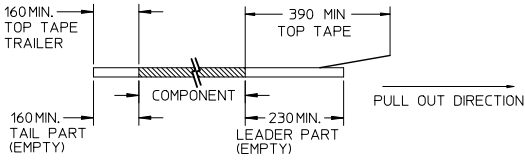

2. PEELING OFF FORCE OF THE TOP TAPE: 20-80gf.

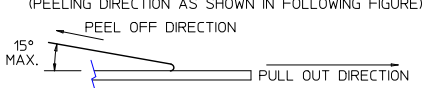

- 3. PACKAGING STANDARD IS AS PER EIA-481.
- 4. TAPE & REEL QUANTITY = 500 PCS/REEL
- 5. THE TAPE IS TREATED FOR ANTI-STATIC.

ADD P/N: 87920-9120 EC NO.: S2011-0043 DRAWN BY: DRWNSKANG CHKD BY: CHYKATSEE APPR: MLONG 2010/07/14 2010/08/02 2010/08/03	QUALITY SYMBOLS	GENERAL TOLERANCES (UNLESS SPECIFIED)	DIMENSION STYLE	SCALE	DESIGN UNITS	THIRD ANGLE PROJECTION																								
	$\nabla=0$ $\nabla=0$ $\nabla=0$	<table border="1"> <tr><th colspan="2">mm</th><th colspan="2">INCH</th></tr> <tr><td>4 PLACES</td><td>±---</td><td>±---</td><td>±---</td></tr> <tr><td>3 PLACES</td><td>±---</td><td>±---</td><td>±---</td></tr> <tr><td>2 PLACES</td><td>±0.2</td><td>±---</td><td>±---</td></tr> <tr><td>1 PLACE</td><td>±---</td><td>±---</td><td>±---</td></tr> <tr><td colspan="4">ANGULAR ± 3°</td></tr> </table>	mm		INCH		4 PLACES	±---	±---	±---	3 PLACES	±---	±---	±---	2 PLACES	±0.2	±---	±---	1 PLACE	±---	±---	±---	ANGULAR ± 3°				MM ONLY	NTS	METRIC	
	mm		INCH																											
	4 PLACES	±---	±---	±---																										
3 PLACES	±---	±---	±---																											
2 PLACES	±0.2	±---	±---																											
1 PLACE	±---	±---	±---																											
ANGULAR ± 3°																														
DRAWN BY: SKLIM01 CHECKED BY: PATEY APPROVED BY: MLONG DATE: 2006/02/09 DATE: 2006/02/16 DATE: 2010/02/08	MATERIAL NO. SEE TABLE SIZE: A3 THIS DRAWING CONTAINS INFORMATION THAT IS PROPRIETARY TO MOLEX INCORPORATED AND SHOULD NOT BE USED WITHOUT WRITTEN PERMISSION	TITLE: CUSTOM HEADER 2.54MM PITCH DUAL ROW HEADER SINGLE WAFER SMT MOLEX INCORPORATED	DOCUMENT NO. SD-87920-020	SHEET NO. 3 OF 11																										

9 8 7 6 5 4 3 2 1

10 9 8 7 6 5 4 3 2 1

CKT	F	P1	W
06	11.50	12.00	24.00

THIS TYPE OF CARRIER TAPE IS FOR CKT SIZE 06 ONLY

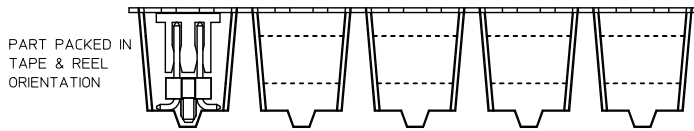
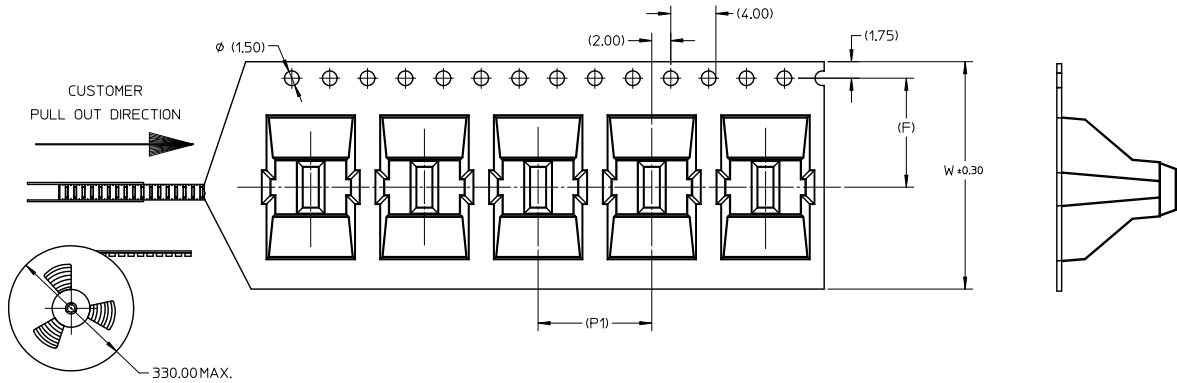

NOTES:

1. LEADER AND TRAILER TAPE

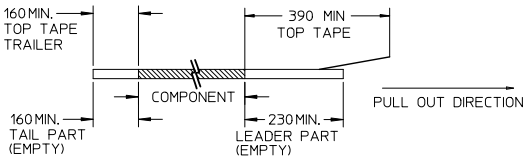

2. PEELING OFF FORCE OF THE TOP TAPE: 20-80gf. (PEELING DIRECTION AS SHOWN IN FOLLOWING FIGURE)

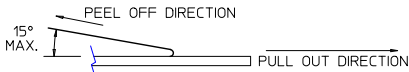

- 3. PACKAGING STANDARD IS AS PER EIA-481.
- 4. TAPE & REEL QUANTITY = 440PCS/REEL
- 5. THE TAPE IS TREATED FOR ANTI-STATIC.

ADD P/N: 87920-9120 EC NO: S2011-0043 DRAWN: KANG CHKD: ATSEE APPR: MLONG	QUALITY SYMBOLS √=0 √=0 √=0	GENERAL TOLERANCES (UNLESS SPECIFIED)		DIMENSION STYLE MM ONLY		SCALE NTS	DESIGN UNITS METRIC	THIRD ANGLE PROJECTION
		4 PLACES ± --- ± ---	3 PLACES ± --- ± ---	2 PLACES ± 0.2 ± ---	1 PLACE ± --- ± ---	ANGULAR ± 3 °	DRAWN BY SKL IM01	
REV D6	DESCRIPTION	DRAFT WHERE APPLICABLE MUST REMAIN WITHIN DIMENSIONS		MATERIAL NO. SEE TABLE		DOCUMENT NO. SD-87920-020		SHEET NO. 4 OF 11
		THIS DRAWING CONTAINS INFORMATION THAT IS PROPRIETARY TO MOLEX INCORPORATED AND SHOULD NOT BE USED WITHOUT WRITTEN PERMISSION						

9 8 7 6 5 4 3 2 1

10	9	8	7	6	5	4	3	2	1
----	---	---	---	---	---	---	---	---	---

CKT	F	P1	W
08	11.50	12.00	24.00
10	11.50	12.00	24.00

THIS TYPE OF CARRIER TAPE IS FOR CKT SIZE 08 AND 10 ONLY

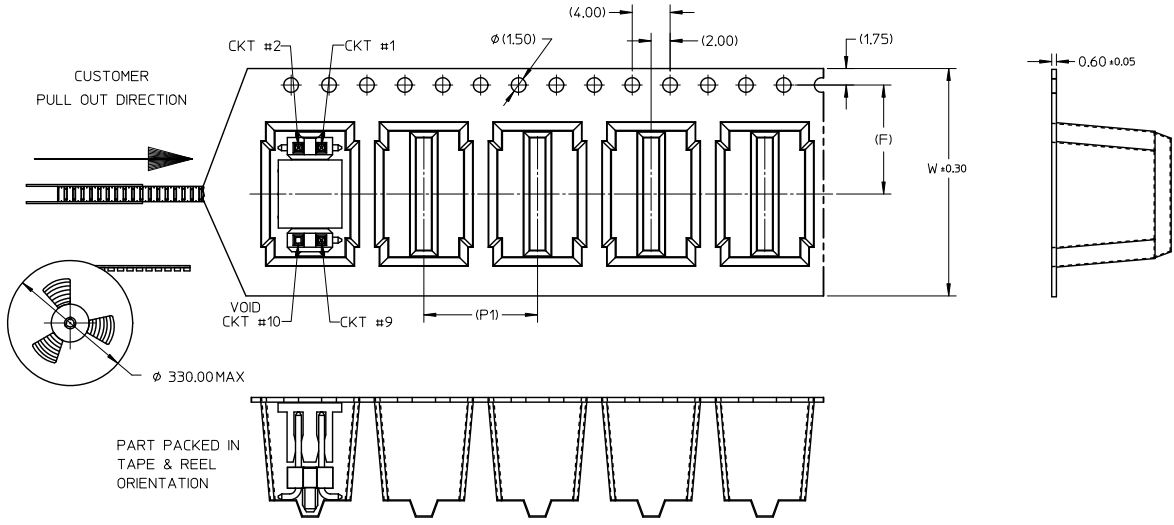

NOTES:

1. LEADER AND TRAILER TAPE

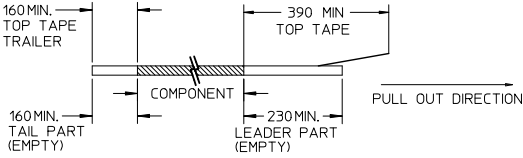

2. PEELING OFF FORCE OF THE TOP TAPE: 20-80gf. (PEELING DIRECTION AS SHOWN IN FOLLOWING FIGURE)

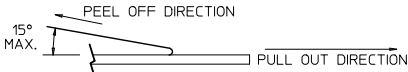

- 3. PACKAGING STANDARD IS AS PER EIA-481.
- 4. TAPE & REEL QUANTITY = 440PCS/REEL.
- 5. THE TAPE IS TREATED FOR ANTI-STATIC.
- 6. ATTACHED ABOVE CONNECTOR IN T&R WITH VOID CKT#10 IS FOR ILLUSTRATION ONLY.

ADD P/N: 87920-9120 EC NO: S2011-0043 DRAWN: KANG CHK: DATSEE APPR: MLONG 2010/07/14 2010/08/02 2010/08/03	QUALITY SYMBOLS $\nabla=0$ $\nabla=0$ $\nabla=0$	GENERAL TOLERANCES (UNLESS SPECIFIED)		DIMENSION STYLE		SCALE	DESIGN UNITS	THIRD ANGLE PROJECTION		
				MM ONLY		NTS	METRIC			
				DRAWN BY SKL I M01		DATE 2006/02/09			TITLE	
				CHECKED BY PATEY		DATE 2006/02/16			CUSTOM HEADER 2.54MM PITCH DUAL ROW HEADER SINGLE WAFER SMT	
REV D6	DESCRIPTION	DRAFT WHERE APPLICABLE MUST REMAIN WITHIN DIMENSIONS		MATERIAL NO. SEE TABLE		DOCUMENT NO. SD-87920-020		SHEET NO. 5 OF 11		
		SIZE A3		THIS DRAWING CONTAINS INFORMATION THAT IS PROPRIETARY TO MOLEX INCORPORATED AND SHOULD NOT BE USED WITHOUT WRITTEN PERMISSION						
				APPROVED BY MLONG		DATE 2010/02/08			MOLEX MOLEX INCORPORATED	

9	8	7	6	5	4	3	2	1
---	---	---	---	---	---	---	---	---

CKT	F	P1	So	W
12	14.20	12.00	28.40	32.00
14	14.20	12.00	28.40	32.00
16	14.20	12.00	28.40	32.00
20	20.20	12.00	40.40	44.00

THIS TYPE OF CARRIER TAPE IS FOR CKT SIZE 12, 14, 16 AND 20

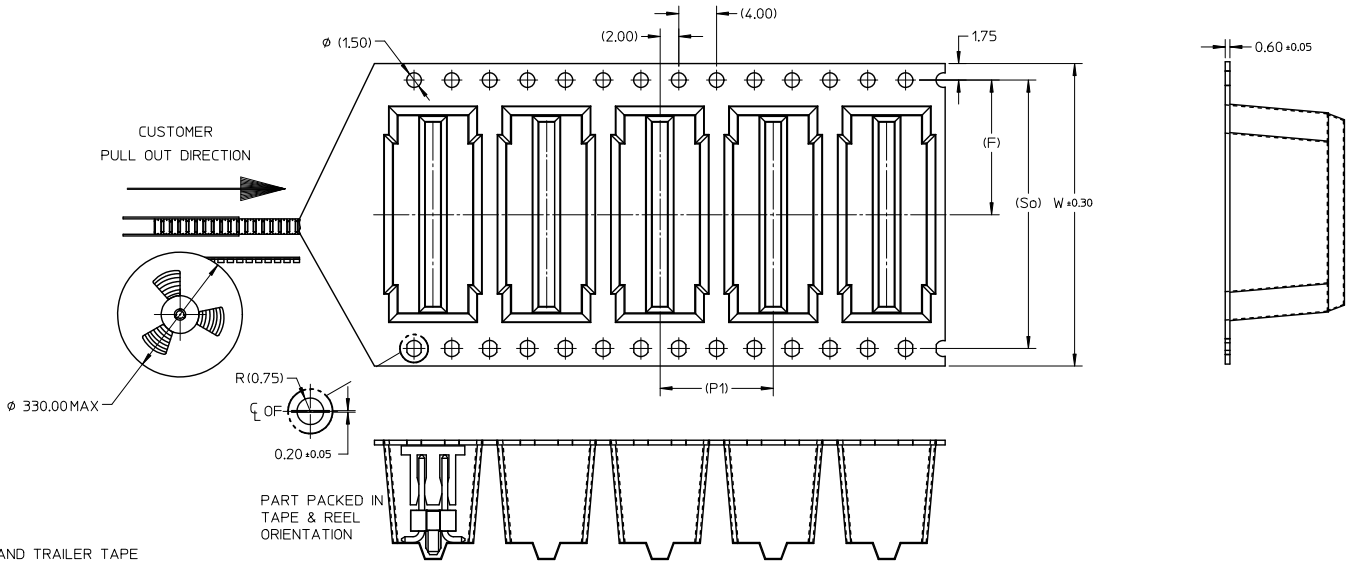

NOTES:

1. LEADER AND TRAILER TAPE

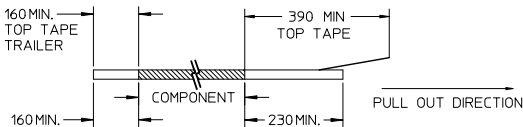

2. PEELING OFF FORCE OF THE TOP TAPE: 20-80gf. (PEELING DIRECTION AS SHOWN IN FOLLOWING FIGURE)

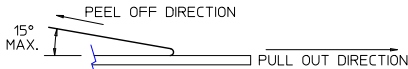

- 3. PACKAGING STANDARD IS AS PER EIA-481.
- 4. TAPE & REEL QUANTITY = 440PCS/REEL.
- 5. THE TAPE IS TREATED FOR ANTI-STATIC.

ADD P/N: 87920-9120 EC NO: S2011-0043 DRAWN: SANG CHKD: ATSEE APPR: HLONG	QUALITY SYMBOLS ▽=0 ▽=0 ▽=0	GENERAL TOLERANCES (UNLESS SPECIFIED)		DIMENSION STYLE		SCALE	DESIGN UNITS	THIRD ANGLE PROJECTION
		mm	INCH	MM ONLY	DATE			
D6	DESCRIPTION	4 PLACES	±---	±---	SKL I M01	2006/02/09	CUSTOM HEADER 2.54MM PITCH DUAL ROW HEADER SINGLE WAFER SMT MOLEX INCORPORATED	SHEET NO. 6 OF 11
		3 PLACES	±---	±---	CHECKED BY	DATE		
		2 PLACES	±0.2	±---	PATEY	2006/02/16		
		1 PLACE	±---	±---	APPROVED BY	DATE		
		ANGULAR		± 3 °	MLONG	2010/02/08		
DRAFT WHERE APPLICABLE MUST REMAIN WITHIN DIMENSIONS		MATERIAL NO. SEE TABLE		DOCUMENT NO. SD-87920-020				
THIS DRAWING CONTAINS INFORMATION THAT IS PROPRIETARY TO MOLEX INCORPORATED AND SHOULD NOT BE USED WITHOUT WRITTEN PERMISSION								

10	9	8	7	6	5	4	3	2	1
----	---	---	---	---	---	---	---	---	---

CKT	F	P1	So	W
40	34.20	16.00	68.50	72.00

THIS TYPE OF CARRIER TAPE IS FOR CKT SIZE 40

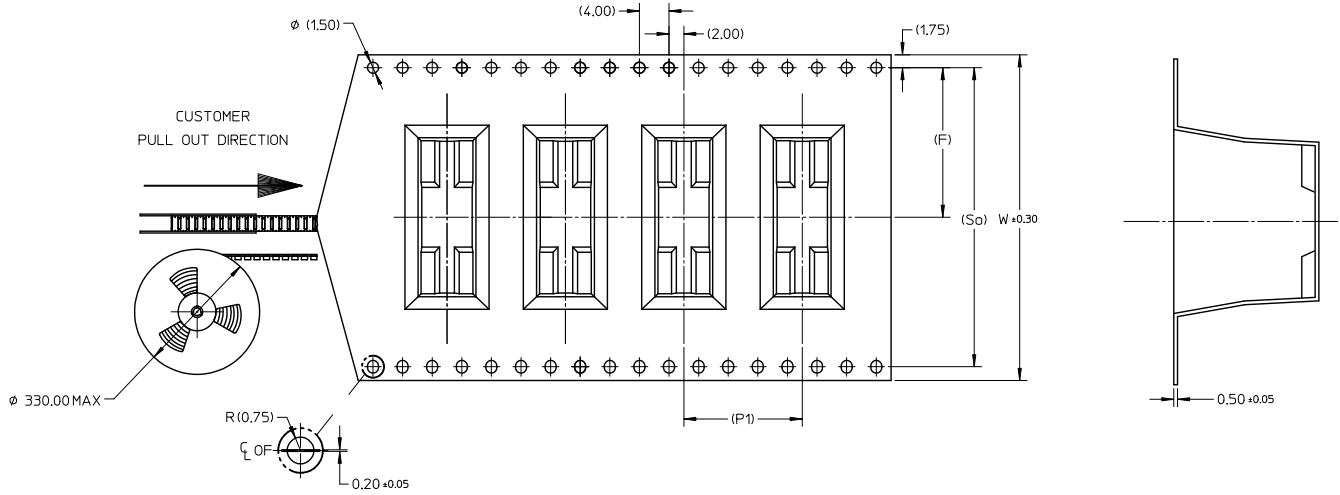

NOTES:

1. LEADER AND TRAILER TAPE

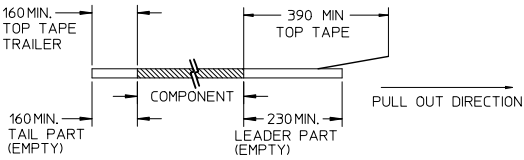

2. PEELING OFF FORCE OF THE TOP TAPE: 20-80gf. (PEELING DIRECTION AS SHOWN IN FOLLOWING FIGURE)

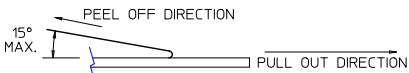

- 3. PACKAGING STANDARD IS AS PER EIA-481.
- 4. TAPE & REEL QUANTITY = 250PCS/REEL.
- 5. THE TAPE IS TREATED FOR ANTI-STATIC.

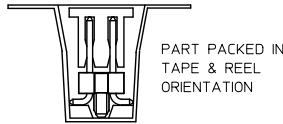

ADD P/N: 87920-9120 EC NO: S2011-0043 DRAWN: KWANG CHKD: ATSEE APPR: MLONG	QUALITY SYMBOLS √=0 √=0 √=0	GENERAL TOLERANCES (UNLESS SPECIFIED)	DIMENSION STYLE		SCALE	DESIGN UNITS	THIRD ANGLE PROJECTION	
			mm	INCH	MM ONLY	METRIC		
REV D6	DESCRIPTION	4 PLACES ± --- ± ---	DRAWN BY	DATE	TITLE			
		3 PLACES ± --- ± ---	SKL IM01	2006/02/09	CUSTOM HEADER			
		2 PLACES ± 0.2 ± ---	CHECKED BY	DATE	2.54MM PITCH DUAL ROW			
		1 PLACE ± --- ± ---	PATEY	2006/02/16	HEADER SINGLE WAFER SMT			
		ANGULAR ± 3 °	APPROVED BY	DATE	MOLEX INCORPORATED			
		DRAFT WHERE APPLICABLE MUST REMAIN WITHIN DIMENSIONS	MLONG	2010/02/08	MATERIAL NO.	DOCUMENT NO.	SHEET NO.	
			SEE TABLE			SD-87920-020	7 OF 11	
			THIS DRAWING CONTAINS INFORMATION THAT IS PROPRIETARY TO MOLEX INCORPORATED AND SHOULD NOT BE USED WITHOUT WRITTEN PERMISSION					

9	8	7	6	5	4	3	2	1
---	---	---	---	---	---	---	---	---

PART NUMBER IN PACKAGING OPTION										CTK SIZE	PEG	PLATE OPT.	VOID CKT	DIMENSION					
TAPE & REEL WITH CAP	TUBE WITHOUT CAP	TUBE WITH CAP	A	B	C	F	G	M											
87920-9111	87920-9044		4	N	1	--	5.08	2.54	-----	9.66	10.66	6.10							
87920-9211	87920-9045		4	N	2	--	5.08	2.54	-----	9.66	10.66	6.10							
87920-9311	87920-9046		4	N	3	--	5.08	2.54	-----	9.66	10.66	6.10							
87920-9112	87920-9064		6	N	1	--	7.62	5.08	-----	9.66	10.66	6.10							
87920-9212	87920-9065		6	N	2	--	7.62	5.08	-----	9.66	10.66	6.10							
87920-9312	87920-9066		6	N	3	--	7.62	5.08	-----	9.66	10.66	6.10							
87920-9113	87920-9084	87920-9087	8	N	1	--	10.16	7.62	-----	9.66	10.66	6.10							
87920-9213	87920-9085	87920-9088	8	N	2	--	10.16	7.62	-----	9.66	10.66	6.10							
87920-9313	87920-9086	87920-9089	8	N	3	--	10.16	7.62	-----	9.66	10.66	6.10							
87920-9114	87920-9104	87920-9107	10	N	1	--	12.70	10.16	-----	9.66	10.66	6.10							
87920-9214	87920-9105	87920-9108	10	N	2	--	12.70	10.16	-----	9.66	10.66	6.10							
87920-9314	87920-9106	87920-9109	10	N	3	--	12.70	10.16	-----	9.66	10.66	6.10							
87920-1007			10	N	1	10	12.70	10.16	-----	9.66	10.66	6.10							

⚠ PART TO BE PACKED IN BULK/TRAY PACKAGING.

ADD P/N: 87920-9120 EC NO: S2011-0043 DRAWN BY: DRWNSKANG CHKD BY: CHKDATSEE APPR: MLONG 2010/07/14 2010/08/02 2010/08/02	QUALITY SYMBOLS √=0 √=0 √=0	GENERAL TOLERANCES (UNLESS SPECIFIED)		DIMENSION STYLE		SCALE	DESIGN UNITS	THIRD ANGLE PROJECTION	
				MM ONLY		NTS	METRIC		
		4 PLACES	± ---	± ---	DRAWN BY	DATE	TITLE		
		3 PLACES	± ---	± ---	SKL IM01	2006/02/09	CUSTOM HEADER		
2 PLACES	± 0.2	± ---	CHECKED BY	DATE	HEADER SINGLE WAFER SMT				
1 PLACE	± ---	± ---	PATEY	2006/02/16	MOLEX INCORPORATED				
ANGULAR ± 3°		APPROVED BY		DATE	MATERIAL NO.				
		MLONG		2010/02/08	DOCUMENT NO.				
DRAFT WHERE APPLICABLE MUST REMAIN WITHIN DIMENSIONS		SEE TABLE		SD-87920-020		SHEET NO.			
		SIZE		THIS DRAWING CONTAINS INFORMATION THAT IS PROPRIETARY TO MOLEX INCORPORATED AND SHOULD NOT BE USED WITHOUT WRITTEN PERMISSION		8 OF 11			



PART NUMBER IN PACKAGING OPTION										DIMENSION						PART NUMBER IN PACKAGING OPTION										DIMENSION					
TAPE & REEL W/O CAP	TAPE & REEL WITH CAP	TUBE WITHOUT CAP	TUBE WITH CAP	CKT SIZE	PEG	PLATE OPT.	A	B	C	F	G	M	TAPE & REEL WITH CAP	TUBE WITHOUT CAP	TUBE WITH CAP	CKT SIZE	PEG	PLATE OPT.	A	B	C	F	G	M							
87920-9120	87920-9119	87920-9124	87920-9127	12	N	1	15.24	12.70	-----	9.66	10.66	6.10	-----	87920-8124	87920-8127	12	Y	1	15.24	12.70	10.16	9.66	10.66	6.10							
-----	-----	87920-9125	87920-9128	12	N	2	15.24	12.70	-----	9.66	10.66	6.10	-----	87920-8125	87920-8128	12	Y	2	15.24	12.70	10.16	9.66	10.66	6.10							
-----	-----	87920-9126	87920-9129	12	N	3	15.24	12.70	-----	9.66	10.66	6.10	-----	87920-8126	87920-8129	12	Y	3	15.24	12.70	10.16	9.66	10.66	6.10							
-----	87920-9115	87920-9144	87920-9147	14	N	1	17.78	15.24	-----	9.66	10.66	6.10	87920-8115	87920-8144	87920-8147	14	Y	1	17.78	15.24	12.70	9.66	10.66	6.10							
-----	87920-9215	87920-9145	87920-9148	14	N	2	17.78	15.24	-----	9.66	10.66	6.10	87920-8215	87920-8145	87920-8148	14	Y	2	17.78	15.24	12.70	9.66	10.66	6.10							
-----	87920-9315	87920-9146	87920-0014	14	N	3	17.78	15.24	-----	9.66	10.66	6.10	87920-8315	87920-8146	87920-8149	14	Y	3	17.78	15.24	12.70	9.66	10.66	6.10							
-----	87920-9116	87920-9164	87920-9167	16	N	1	20.32	17.78	-----	9.66	10.66	6.10	87920-8116	87920-8164	87920-8167	16	Y	1	20.32	17.78	15.24	9.66	10.66	6.10							
-----	87920-9216	87920-9165	87920-9168	16	N	2	20.32	17.78	-----	9.66	10.66	6.10	87920-8216	87920-8165	87920-8168	16	Y	2	20.32	17.78	15.24	9.66	10.66	6.10							
-----	87920-9316	87920-9166	87920-9169	16	N	3	20.32	17.78	-----	9.66	10.66	6.10	87920-8316	87920-8166	87920-8169	16	Y	3	20.32	17.78	15.24	9.66	10.66	6.10							
-----	-----	87920-9184	87920-9187	18	N	1	22.86	20.32	-----	9.66	10.66	6.10	-----	87920-8184	87920-8187	18	Y	1	22.86	20.32	17.78	9.66	10.66	6.10							
-----	-----	87920-9185	87920-9188	18	N	2	22.86	20.32	-----	9.66	10.66	6.10	-----	87920-8185	87920-8188	18	Y	2	22.86	20.32	17.78	9.66	10.66	6.10							
-----	-----	87920-9186	87920-9189	18	N	3	22.86	20.32	-----	9.66	10.66	6.10	-----	87920-8186	87920-8189	18	Y	3	22.86	20.32	17.78	9.66	10.66	6.10							
-----	87920-9117	87920-9204	87920-9207	20	N	1	25.40	22.86	-----	9.66	10.66	6.10	87920-8117	87920-8204	87920-8207	20	Y	1	25.40	22.86	20.32	9.66	10.66	6.10							
-----	87920-9217	87920-9205	87920-9208	20	N	2	25.40	22.86	-----	9.66	10.66	6.10	87920-8217	87920-8205	87920-8208	20	Y	2	25.40	22.86	20.32	9.66	10.66	6.10							
-----	87920-9317	87920-9206	87920-9209	20	N	3	25.40	22.86	-----	9.66	10.66	6.10	87920-8317	87920-8206	87920-8209	20	Y	3	25.40	22.86	20.32	9.66	10.66	6.10							

ADD P/N: 87920-9120 EC NO.: S2011-0043 DRAWN BY: DRWNSKANG CHKD BY: CHKDRSEE APPR: MLONG 2010/07/14 2010/08/02 2010/08/03	QUALITY SYMBOLS $\sqrt{\text{R}}=0$ $\sqrt{\text{E}}=0$ $\sqrt{\text{D}}=0$	GENERAL TOLERANCES (UNLESS SPECIFIED)		DIMENSION STYLE		SCALE	DESIGN UNITS	THIRD ANGLE PROJECTION	
				MM ONLY		NTS	METRIC		
		4 PLACES ± --- ± ---		DRAWN BY SKL IM01		DATE 2006/02/09		TITLE	
		3 PLACES ± --- ± ---		CHECKED BY		DATE		CUSTOM HEADER	
2 PLACES ± 0.2 ± ---		PATEY		2006/02/16		2.54MM PITCH DUAL ROW			
1 PLACE ± --- ± ---		APPROVED BY		DATE		HEADER SINGLE WAFER SMT			
ANGULAR ± 3°		MLONG		2010/02/08		MOLEX INCORPORATED			
DRAFT WHERE APPLICABLE MUST REMAIN WITHIN DIMENSIONS		MATERIAL NO.		SEE TABLE		DOCUMENT NO.			
		SIZE		A3		SD-87920-020			
		THIS DRAWING CONTAINS INFORMATION THAT IS PROPRIETARY TO MOLEX INCORPORATED AND SHOULD NOT BE USED WITHOUT WRITTEN PERMISSION				SHEET NO. 9 OF 11			



PART NUMBER IN PACKAGING OPTION		TUBE WITH CAP	TUBE WITHOUT CAP	TUBE WITH CAP	CKT SIZE	PEG	PLATE OPT.	DIMENSION					
TAPE & REEL WITH CAP	A							B	C	F	G	M	
-----	87920-9224	87920-9227	22	N	1	27.94	25.40	-----	9.66	10.66	6.10		
-----	87920-9225	87920-9228	22	N	2	27.94	25.40	-----	9.66	10.66	6.10		
-----	87920-9226	87920-9229	22	N	3	27.94	25.40	-----	9.66	10.66	6.10		
-----	87920-9244	87920-9247	24	N	1	30.48	27.94	-----	9.66	10.66	6.10		
-----	87920-9245	87920-9248	24	N	2	30.48	27.94	-----	9.66	10.66	6.10		
-----	87920-9246	87920-9249	24	N	3	30.48	27.94	-----	9.66	10.66	6.10		
-----	87920-9264	87920-9267	26	N	1	33.02	30.48	-----	9.66	10.66	6.10		
-----	87920-9265	87920-9268	26	N	2	33.02	30.48	-----	9.66	10.66	6.10		
-----	87920-9266	87920-9269	26	N	3	33.02	30.48	-----	9.66	10.66	6.10		
-----	87920-9284	87920-9287	28	N	1	35.56	33.02	-----	9.66	10.66	6.10		
-----	87920-9285	87920-9288	28	N	2	35.56	33.02	-----	9.66	10.66	6.10		
-----	87920-9286	87920-9289	28	N	3	35.56	33.02	-----	9.66	10.66	6.10		
-----	87920-9304	87920-9307	30	N	1	38.10	35.56	-----	9.66	10.66	6.10		
-----	87920-9305	87920-9308	30	N	2	38.10	35.56	-----	9.66	10.66	6.10		
-----	87920-9306	87920-9309	30	N	3	38.10	35.56	-----	9.66	10.66	6.10		

ADD P/N: 87920-9120 EC NO: S2011-0043 DRAWN: KANG CHK: DATSEE APPR: MLONG	QUALITY SYMBOLS $\nabla=0$ $\nabla=0$ $\nabla=0$	GENERAL TOLERANCES (UNLESS SPECIFIED)		DIMENSION STYLE		SCALE	DESIGN UNITS	THIRD ANGLE PROJECTION	
				MM ONLY		NTS	METRIC		
				DRAWN BY SKL I M01		DATE 2006/02/09	TITLE		
				CHECKED BY PATEY		DATE 2006/02/16	CUSTOM HEADER 2.54MM PITCH DUAL ROW HEADER SINGLE WAFER SMT		
		APPROVED BY MLONG		DATE 2010/02/08	MOLEX INCORPORATED				
REV D6		DRAFT WHERE APPLICABLE MUST REMAIN WITHIN DIMENSIONS		MATERIAL NO. SEE TABLE		DOCUMENT NO. SD-87920-020	SHEET NO. 10 OF 11		
				SIZE A3		THIS DRAWING CONTAINS INFORMATION THAT IS PROPRIETARY TO MOLEX INCORPORATED AND SHOULD NOT BE USED WITHOUT WRITTEN PERMISSION			

PART NUMBER IN PACKAGING OPTION			CKT SIZE	PEG	PLATE OPT.	DIMENSION					
TAPE & REEL WITH CAP	TUBE WITHOUT CAP	TUBE WITH CAP				A	B	C	F	G	M
-----	87920-9324	87920-9327	32	N	1	40.64	38.10	-----	9.66	10.66	6.10
-----	87920-9325	87920-9328	32	N	2	40.64	38.10	-----	9.66	10.66	6.10
-----	87920-9326	87920-9329	32	N	3	40.64	38.10	-----	9.66	10.66	6.10
-----	87920-9344	87920-9347	34	N	1	43.18	40.64	-----	9.66	10.66	6.10
-----	87920-9345	87920-9348	34	N	2	43.18	40.64	-----	9.66	10.66	6.10
-----	87920-9346	87920-9349	34	N	3	43.18	40.64	-----	9.66	10.66	6.10
-----	87920-9364	87920-9367	36	N	1	45.72	43.18	-----	9.66	10.66	6.10
-----	87920-9365	87920-9368	36	N	2	45.72	43.18	-----	9.66	10.66	6.10
-----	87920-9366	87920-9369	36	N	3	45.72	43.18	-----	9.66	10.66	6.10
-----	87920-9384	87920-9387	38	N	1	48.26	45.72	-----	9.66	10.66	6.10
-----	87920-9385	87920-9388	38	N	2	48.26	45.72	-----	9.66	10.66	6.10
-----	87920-9386	87920-9389	38	N	3	48.26	45.72	-----	9.66	10.66	6.10
87920-9118	87920-9404	87920-9407	40	N	1	50.80	48.26	-----	9.66	10.66	6.10
87920-9218	87920-9405	87920-9408	40	N	2	50.80	48.26	-----	9.66	10.66	6.10
87920-9318	87920-9406	87920-9409	40	N	3	50.80	48.26	-----	9.66	10.66	6.10

PART NUMBER IN PACKAGING OPTION			CKT SIZE	PEG	PLATE OPT.	DIMENSION					
TAPE & REEL WITH CAP	TUBE WITHOUT CAP	TUBE WITH CAP				A	B	C	F	G	M
-----	87920-8324	87920-8327	32	Y	1	40.64	38.10	35.56	9.66	10.66	6.10
-----	87920-8325	87920-8328	32	Y	2	40.64	38.10	35.56	9.66	10.66	6.10
-----	87920-8326	87920-8329	32	Y	3	40.64	38.10	35.56	9.66	10.66	6.10
-----	87920-8344	87920-8347	34	Y	1	43.18	40.64	38.10	9.66	10.66	6.10
-----	87920-8345	87920-8348	34	Y	2	43.18	40.64	38.10	9.66	10.66	6.10
-----	87920-8346	87920-8349	34	Y	3	43.18	40.64	38.10	9.66	10.66	6.10
-----	87920-8364	87920-8367	36	Y	1	45.72	43.18	40.64	9.66	10.66	6.10
-----	87920-8365	87920-8368	36	Y	2	45.72	43.18	40.64	9.66	10.66	6.10
-----	87920-8366	87920-8369	36	Y	3	45.72	43.18	40.64	9.66	10.66	6.10
-----	87920-8384	87920-8387	38	Y	1	48.26	45.72	43.18	9.66	10.66	6.10
-----	87920-8385	87920-8388	38	Y	2	48.26	45.72	43.18	9.66	10.66	6.10
-----	87920-8386	87920-8389	38	Y	3	48.26	45.72	43.18	9.66	10.66	6.10
87920-8118	87920-8404	87920-8407	40	Y	1	50.80	48.26	45.72	9.66	10.66	6.10
87920-8218	87920-8405	87920-8408	40	Y	2	50.80	48.26	45.72	9.66	10.66	6.10
87920-8318	87920-8406	87920-8409	40	Y	3	50.80	48.26	45.72	9.66	10.66	6.10

ADD P/N: 87920-9120 EC NO: S2011-0043 DRAWN: KANG CHK: DATSEE APPR: MLONG 2010/07/14 2010/08/02 2010/08/03	QUALITY SYMBOLS	GENERAL TOLERANCES (UNLESS SPECIFIED)	DIMENSION STYLE	SCALE	DESIGN UNITS	THIRD ANGLE PROJECTION															
	$\sqrt{\text{---}}=0$ $\sqrt{\text{---}}=0$ $\sqrt{\text{---}}=0$	<table border="1"> <tr><th colspan="2">mm</th><th>INCH</th></tr> <tr><td>4 PLACES</td><td>± ---</td><td>± ---</td></tr> <tr><td>3 PLACES</td><td>± ---</td><td>± ---</td></tr> <tr><td>2 PLACES</td><td>± 0.2</td><td>± ---</td></tr> <tr><td>1 PLACE</td><td>± ---</td><td>± ---</td></tr> </table>	mm		INCH	4 PLACES	± ---	± ---	3 PLACES	± ---	± ---	2 PLACES	± 0.2	± ---	1 PLACE	± ---	± ---	MM ONLY	NTS	METRIC	
	mm		INCH																		
	4 PLACES	± ---	± ---																		
3 PLACES	± ---	± ---																			
2 PLACES	± 0.2	± ---																			
1 PLACE	± ---	± ---																			
DRAWN BY: SKL I M 01 CHECKED BY: PATEY APPROVED BY: MLONG DATE: 2006/02/09 DATE: 2006/02/16 DATE: 2010/02/08	DRAFT WHERE APPLICABLE MUST REMAIN WITHIN DIMENSIONS	MATERIAL NO. SEE TABLE SIZE: $\frac{A}{3}$	TITLE: CUSTOM HEADER 2.54MM PITCH DUAL ROW HEADER SINGLE WAFER SMT MOLEX INCORPORATED	DOCUMENT NO. SD-87920-020	SHEET NO. 11 OF 11																
REV: D6																					