



Distributor of CNC Tech: Excellent Integrated System Limited

Datasheet of 1003-001-0100180 - Connector Receptacle USB TypeA 3.0, Super Speed 9
Position Through Hole, Vertical

Contact us: sales@integrated-circuit.com Website: www.integrated-circuit.com

Excellent Integrated System Limited

Stocking Distributor

Click to view price, real time Inventory, Delivery & Lifecycle Information:

[CNC Tech](#)

[1003-001-0100180](#)

For any questions, you can email us directly:

sales@integrated-circuit.com

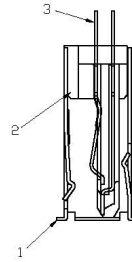
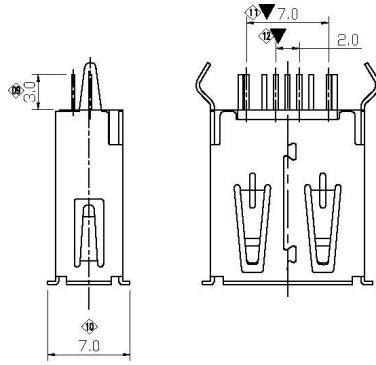
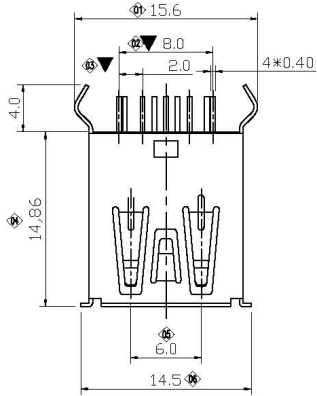

NOTE:

- 1 MATERIAL:
- 1.1 INSULATOR: PBT UL94V-0
- 1.2 CONTACT BRONZR(T=0.25mm)
- 1.3 SHELL: SPCC(T=0.30mm)
- 1.4 SHELL: BRASS(T=0.30mm)
- 2 ELECTRICAL CHARACTERISTICS:
- 2.1 CONTACT RESISTANCE: 30mΩ MAXIMUM
- 2.2 CONTACT CURRENT RATING: 1.5A
- 2.3 DIELECTRIC WITHSTANDING VOLTAGE: 500V R.M.S.
- 2.4 INSULATION RESISTANCE 1000 MEGOHMS MIN
- 2.5 OPERATING TEMPERATURE: -40°C ~ 85°C
- 3 MECHANICAL CHARACTERISTICS:
- 3.1 MATING FORCE: 3.57kg MAX
- 3.2 UNMATING FORCE: 1.02kg MIN
- 3.3 DURABILITY: MANDATORY: 5000 CYCLES
- 4. PLATING
- 4.1 TERMINAL: GOLD FLASH ALL OVER 50U" MIN NICKEL AND 1U" MIN TIN ALL OVER 50U" MIN NICKEL ON SOLDER AREA
- 4.2 SHELL: 150U" MIN NICKEL OVER 20U" MIN COPPER

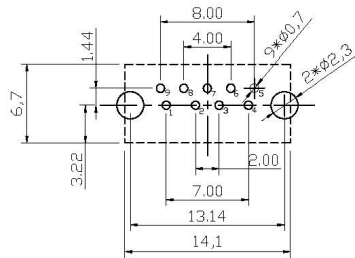
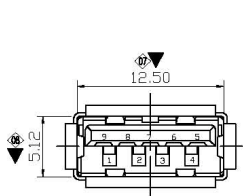

P C B LAYOUT

2011/09/13	XIE		NEW DWG		AO
DATE	DR. BY	ECN. NO.	DESCRIPTION	MARK	VER.
-TOLERANCES- UNLESS OTHERWISE SPECIFIED			<p style="text-align: center; font-size: 24px; font-weight: bold;">CnC Tech, LLC</p> <p style="text-align: center;">TITLE: USB 3.0 A/F DIP180 15U"</p>		
X.X ±0.30	X.X' ±3.00'	APPD:			
X.XX ±0.15	X.XX' ±1.00'	CHECK:	DATE	SCALE	PAGE
X.XXX ±0.100	X.XXX' ±0.500'	DRAW:	2011/09/13	1:1	1/1