

Excellent Integrated System Limited

Stocking Distributor

Click to view price, real time Inventory, Delivery & Lifecycle Information:

[Molex Connector Corporation](#)
[0483251102](#)

For any questions, you can email us directly:
sales@integrated-circuit.com

7 6 5 4 3 2 1

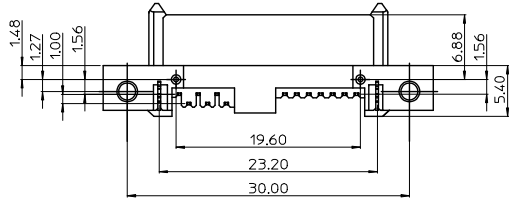
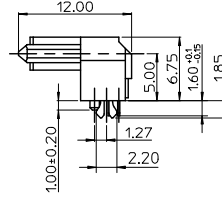
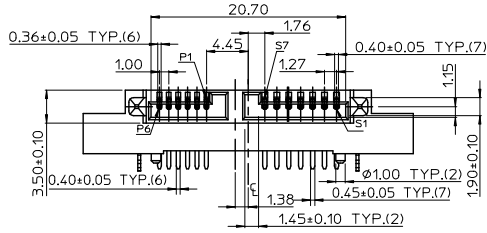
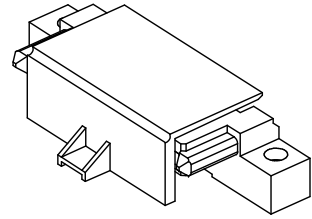
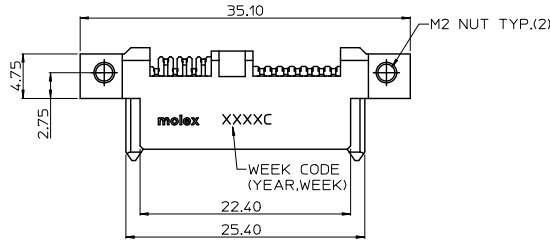

MODIFY THE CAP EC NO: SH2009-0659 DRWN:FYANGOS CHYD:RZHANG APPR:HMWANG	2009/04/29 2009/04/29 2009/06/09	QUALITY SYMBOLS ▽=0 ▽=0	GENERAL TOLERANCES (UNLESS SPECIFIED)		DIMENSION STYLE MM ONLY		SCALE	DESIGN UNITS METRIC	THIRD ANGLE PROJECTION
			4 PLACES ± --- ± --- 3 PLACES ± --- ± --- 2 PLACES ± 0.25 ± --- 1 PLACE ± 0.25 ± --- ANGULAR ± 3°	DRAWN BY LINDA CHECKED BY ALLEN LIN APPROVED BY ERICK LAN MATERIAL NO.	DATE 2008/01/04 DATE 2008/01/07 DATE 2008/01/07	TITLE SLIMLINE SATA RECEPTACLE REVERSE RIGHT ANGLE WITH SCREW AND CLIP	MOLEX INCORPORATED	SHEET NO. 1 OF 2	
DRAFT WHERE APPLICABLE MUST REMAIN WITHIN DIMENSIONS			SEE SHEET 2		DOCUMENT NO. SD-48325-002		THIS DRAWING CONTAINS INFORMATION THAT IS PROPRIETARY TO MOLEX INCORPORATED AND SHOULD NOT BE USED WITHOUT WRITTEN PERMISSION		

6 5 4 3 2 1

7 6 5 4 3 2 1

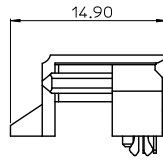
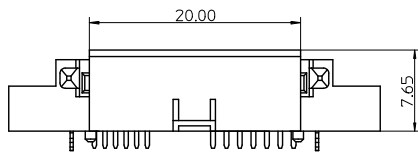

P/N	PLATING OPTIONS	WITHSTANDING MFG TEST
48325-1101	GOLD FLASH	NO
48325-1102	15 MICROINCH	NO
48325-1103	30 MICROINCH	YES

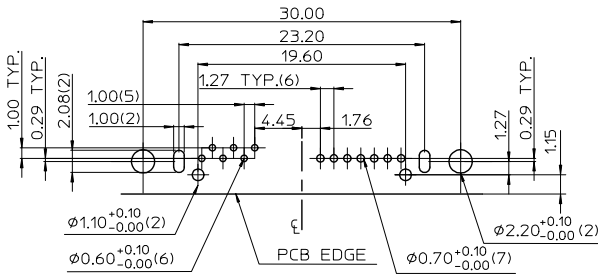
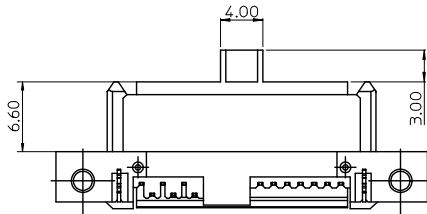

RECOMMENDED PC BOARD LAYOUT
TOLERANCE:±0.05mm(TOP VIEW)

NOTES:

- MATERIAL:**
HOUSING & CAP : LIQUID CRYSTAL POLYMER, GLASS FIBER FILLED, UL94V-0, COLOR : BLACK.
TERMINAL : COPPER ALLOY.
NUT : ZINC ALLOY.
CLIP : COPPER ALLOY.
- PLATING:**
TERMINAL:
CONTACT AREA : SEE TABLE
SOLDER TAIL : MATTE TIN PLATED, THICKNESS=100 MICROINCH MIN/2.54 MICROMETER MIN.
UNDER PLATE : NICKEL(Ni) PLATED OVERALL.
NUT : NICKEL(Ni) PLATED, THICKNESS=50 MICROINCH MIN/1.27 MICROMETER MIN.
UNDER PLATE : COPPER(Cu) PLATED OVERALL.
CLIP : TIN(Sn) PLATED, THICKNESS=100 MICROINCH MIN/2.54 MICROMETER MIN OVER NICKEL PLATED.
- MATES WITH : SERIES 47300.
- RECOMMENDED PCB THICKNESS:1.20±0.05mm.
- PRODUCT SPECIFICATION REFER TO PS-48321-001.
- TEST SUMMARY REFER TO TS-48325-001.
- PACKAGING SPECIFICATION REFER TO PK-48325-002.
- LEAD FREE & RoHS COMPLIANT PRODUCT.

MODIFY THE CAP EC NO: SH2009-0659 DRWNYFANG05 2009/04/29 CHYKDRZHANG 2009/04/29 APPR:HWANG 2009/06/09	DESCRIPTION B	QUALITY SYMBOLS ▽=0 ▽=0	GENERAL TOLERANCES (UNLESS SPECIFIED)		DIMENSION STYLE MM ONLY		SCALE 1:1	DESIGN UNITS METRIC	THIRD ANGLE PROJECTION	
			mm	INCH	DRAWN BY LINDA	DATE 2008/01/04	TITLE SLIMLINE SATA RECEPTACLE REVERSE RIGHT ANGLE WITH SCREW AND CLIP			
DRAFT WHERE APPLICABLE MUST REMAIN WITHIN DIMENSIONS			4 PLACES	± ---	± ---	CHECKED BY ALLEN LIN	DATE 2008/01/07	MOLEX INCORPORATED DOCUMENT NO. SD-48325-002		
			3 PLACES	± ---	± ---	APPROVED BY ERICK LAN	DATE 2008/01/07			
REV			2 PLACES	± 0.25	± ---	MATERIAL NO. SEE THE TABLE				
			1 PLACE	± 0.25	± ---					SHEET NO. 2 OF 2
SIZE A4			ANGULAR ± 3°		THIS DRAWING CONTAINS INFORMATION THAT IS PROPRIETARY TO MOLEX INCORPORATED AND SHOULD NOT BE USED WITHOUT WRITTEN PERMISSION					

6 5 4 3 2 1