

Excellent Integrated System Limited

Stocking Distributor

Click to view price, real time Inventory, Delivery & Lifecycle Information:

[Molex Connector Corporation](#)
[0732540210](#)

For any questions, you can email us directly:

sales@integrated-circuit.com

MATERIALS AND FINISHES

BODY BRASS
PLATED GOLD

CENTER CONTACT BERYLLIUM COPPER
PLATED GOLD

INSULATOR TEFLON

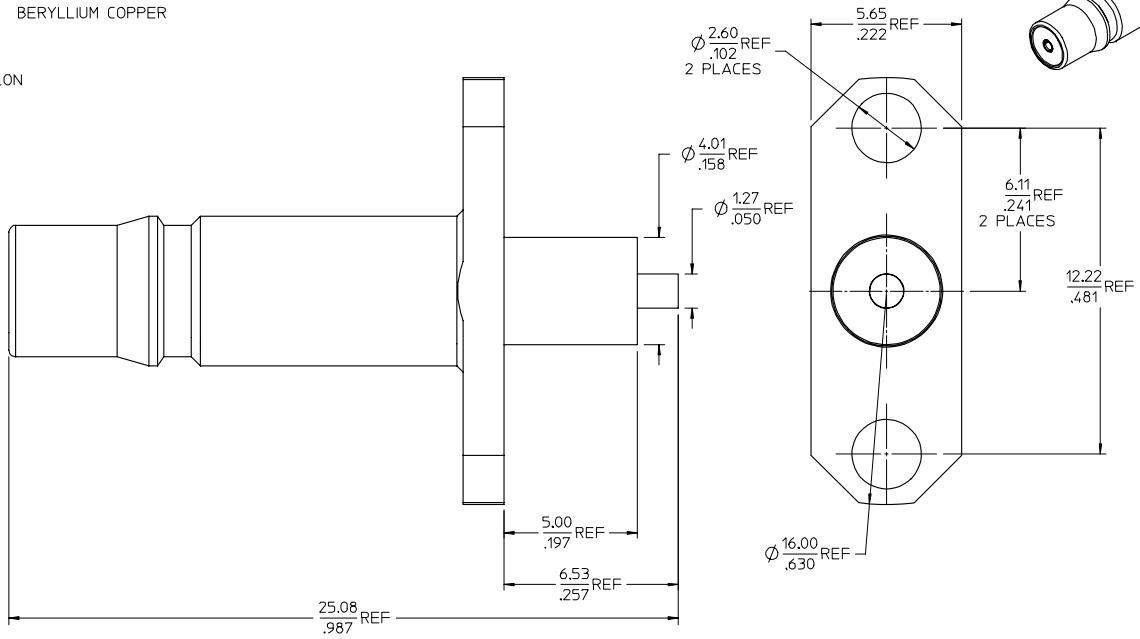

PART # 73254-0210

PS-89675-1330	QMA
SPECIFICATION	DESCRIPTION

CHG: UPDATED VIEW OF REVISED BODY. ELC NO: URF2008-0013 DRW: ARBERTSON 2007/07/17 CHKD: 2007/07/17 APPR: WIENER 2007/07/17 REV: A1	QUALITY SYMBOLS	GENERAL TOLERANCES (UNLESS SPECIFIED)	DIMENSION STYLE	SCALE	DESIGN UNITS	THIRD ANGLE PROJECTION	
	▽=0 ∇=0	mm INCH 4 PLACES ± .005 ± .005 3 PLACES ± .005 ± .005 2 PLACES ± .005 ± .005 1 PLACE ± .005 ± .005 ANGULAR ± 2 °	MM/IN	DATE	METRIC	QMA JACK, STRAIGHT 2 HOLE FLANGE RECEPTACLE EWR-2616, QMA-JR	
				DRAWN BY: JM DATE: 2004/10/13 CHECKED BY: JM DATE: 2004/10/13 APPROVED BY: JDW DATE: 2004/10/13			MOLEX INCORPORATED MOLEX INCORPORATED
				MATERIAL NO. 732540210 SIZE C			DOCUMENT NO. SD-73254-021 SHEET NO. 1 OF 1 THIS DRAWING CONTAINS INFORMATION THAT IS PROPRIETARY TO MOLEX INCORPORATED AND SHOULD NOT BE USED WITHOUT WRITTEN PERMISSION