

Excellent Integrated System Limited

Stocking Distributor

Click to view price, real time Inventory, Delivery & Lifecycle Information:

[Molex Connector Corporation](#)
[0467080001](#)

For any questions, you can email us directly:

sales@integrated-circuit.com

NOTES:

1. MATERIAL: PA6 NYLON UNFILLED 89992-1195 - COLOR BLACK
2. PART FOR USE WITH HOUSING 46707-0001
3. PART IS ROHS COMPLIANT
4. PACKAGED PER MOLEX PACKAGING SPEC PK-46708-001

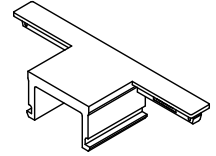
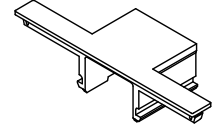
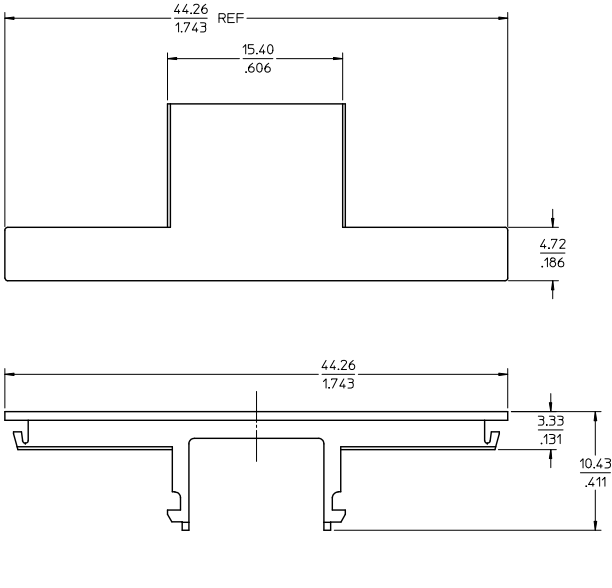

RVD TO MODEL EC NO: UCP2009-2016 2009/02/26 DRAWN: JSCHAFFER 2009/02/26 CHKD: APPROV: APATEL 2009/03/10	QUALITY SYMBOLS	GENERAL TOLERANCES (UNLESS SPECIFIED)	DIMENSION STYLE	SCALE	DESIGN UNITS	THIRD ANGLE PROJECTION
	∇=0	mm INCH	MM/IN	4:1	METRIC	
	∇=0	4 PLACES ± --- ± ---	DRAWN BY DATE	TITLE		
	∇=0	3 PLACES ± --- ± .008	CHECKED BY DATE	TPA FOR HSG RECEPTACLE TEN50 WIRE HALOGEN FREE		
	2 PLACES ± 0.20 ± .013	1 PLACE ± 0.33 ± ---	APPROVED BY DATE	MOLEX INCORPORATED		
	ANGULAR ± 1/2°		MATERIAL NO.	DOCUMENT NO.	SHEET NO.	
	DRAFT WHERE APPLICABLE MUST REMAIN WITHIN DIMENSIONS		46708-0001	SD-46708-001	1 OF 1	
			THIS DRAWING CONTAINS INFORMATION THAT IS PROPRIETARY TO MOLEX INCORPORATED AND SHOULD NOT BE USED WITHOUT WRITTEN PERMISSION			