

Excellent Integrated System Limited

Stocking Distributor

Click to view price, real time Inventory, Delivery & Lifecycle Information:

[Molex Connector Corporation](#)
[0442624636](#)

For any questions, you can email us directly:

sales@integrated-circuit.com

PART NUMBER	PLATING	RECOMMENDED WIRE SIZE	DIM 'A' HEIGHT	DIM 'B' WIDTH	RECOMMENDED CRIMP APPLICATOR	PACKAGE SIZE
44262-4634	30μ" GOLD STRIPE OVER 50μ" NICKEL OVERALL WITH 80-100μ" SELECT TIN	8 AWG (2) 12 AWG	7,42±0,5	5,84±0,5	63832-6300	1800 PARTS/ REEL
44262-4632		10-12 AWG (2) 14 AWG	5,97±0,5	5,33±0,5	63832-6000	2500 PARTS/ REEL
44262-4636		14-16 AWG (2) 16 AWG (2) 18 AWG	5,20±0,5	5,33±0,5	63832-6100	

- NOTES:
1. MATERIAL: COPPER ALLOY .032 IN THICK
 2. FINISH: PER MOLEX PLATING SPECIFICATION ES-88 - SEE CHART
 3. FOR CRIMP APPLICATOR SEE CHART
 4. FOR CRIMP TOOLING CONTACT MOLEX OR VISIT THE MOLEX WEBSITE AT: WWW.MOLEX.COM
 5. STANDARD PACKAGE SIZE: SEE CHART
 6. SEE PRODUCT SPECIFICATION: PS-44262-001 FOR MORE INFORMATION
 7. PARTS ARE RoHS COMPLIANT
 8. FOR MATING CONTACT: SEE CHART
 9. FOR CRIMP SET UP INFORMATION SEE MOLEX APPLICATION SPECIFICATION DOCUMENT:
- 8 AWG - ATS-638326300
 10/12 AWG - ATS-638326000
 14/16 AWG - ATS-638326100

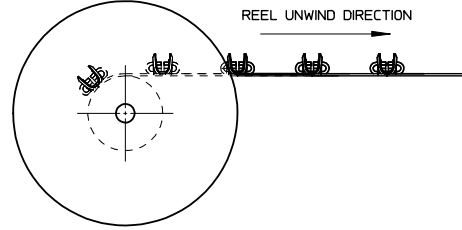
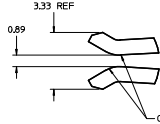
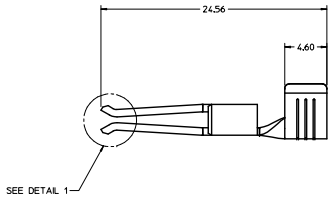
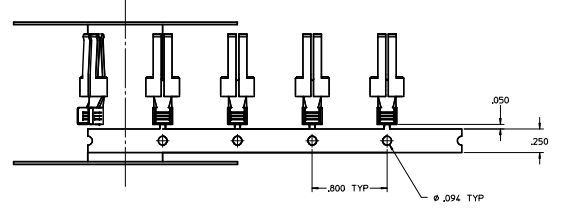
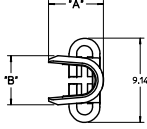
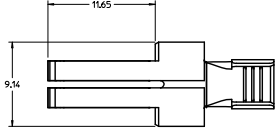
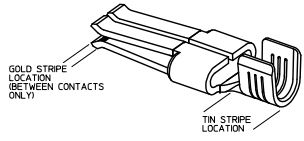

SEE DETAIL 1

GOLD STRIPE AREA - INSIDE GAP AREA ONLY - (SEE CHART)
 DETAIL 1
 SCALE 10:1

RELEASED EC NO. UEP2015-4855 DRAWN: JUILLES 2015/05/19 CHECKED: SZCZOR 2015/05/21 APPROVED: SZCZOR 2015/06/11 REF:	QUALITY SYMBOLS	GENERAL TOLERANCES (UNLESS SPECIFIED)	DIMENSION STYLE	SCALE	DESIGN UNITS	THIRD ANGLE PROJECTION
	∇=0 ∇=0 ∇=0	4 PLACES ±.005 3 PLACES ±.008 2 PLACES ±.013 1 PLACE ±.025 0 PLACE ±.050	MM ONLY	5:1	METRIC	DRAWN BY: JUILLES CHECKED BY: SZCZOR APPROVED BY: SZCZOR DATE: 2015/05/19 DATE: 2015/05/21 DATE: 2015/06/11
	ANGULAR ±1/2° DRAFT WHERE APPLICABLE MUST REMAIN WITHIN DIMENSIONS	SEE CHART	MATERIAL NO.	DOCUMENT NO.	TERMINAL - RECEPTACLE POWER CONTACT TEN60 POWER FAMILY	
	INCORPORATED AND SHOULD NOT BE USED WITHOUT WRITTEN PERMISSION	MOLEX SD-44262-2000	SHEET NO.	1 OF 1		