

Excellent Integrated System Limited

Stocking Distributor

Click to view price, real time Inventory, Delivery & Lifecycle Information:

[Molex Connector Corporation](#)
[0008701030](#)

For any questions, you can email us directly:

sales@integrated-circuit.com

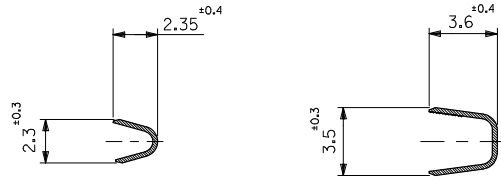
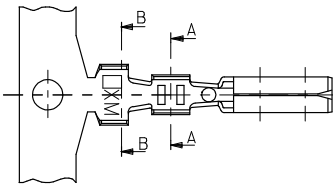

断面 A-A
SECT.A-A

断面 B-B
SECT.B-B

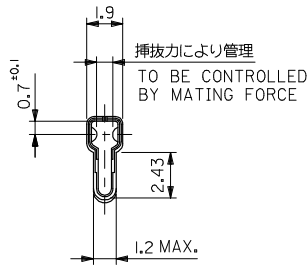
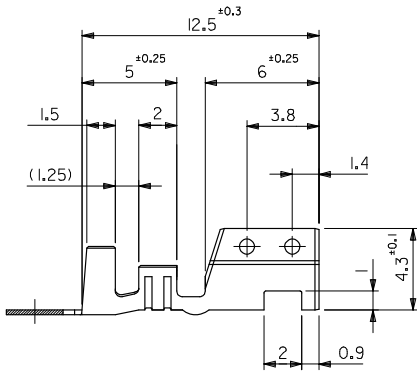

挿抜力により管理
TO BE CONTROLLED
BY MATING FORCE

注記
NOTES

1. 適合ハウジング : 5195-N* , 5196-N*
APPLICABLE HOUSING 5197-N* , 5198-N*
5199-N*

錫メッキ済 リン青銅 PRE-TINNED PHOSPHOR BRONZE	Sn : 0.9% MIN	39-00-0022	5194PBT	バラ状 LOOSE CRIMP
錫メッキ済 黄銅 PRE-TINNED BRASS	Sn : 0.9% MIN, Cu : 0.5% MIN	39-00-0021	5194PBT	連鎖状 CHAIN CRIMP
錫メッキ済 黄銅 PRE-TINNED BRASS	Sn : 0.9% MIN, Cu : 0.5% MIN	08-70-1030	5194TL	バラ状 LOOSE CRIMP
錫メッキ済 黄銅 PRE-TINNED BRASS	Sn : 0.9% MIN, Cu : 0.5% MIN	08-70-1031	5194T	連鎖状 CHAIN CRIMP
材料 MATERIAL	表面処理 FINISH	EDP NO.	ENG. NO.	端子形状 FORM

材料 MATERIAL	表参照 板厚 : 0.254 (t=0.254)
仕上り FINISH	表参照 SEE TABLE
適用電線範囲 WIRE RANGE	AWG #18-#24
被覆外径 INS. RANGE	φ1.3 - φ3.2

REVISED EC NO: J2008-3351 DRAWN BY: CHYUO-HARUYAMA 2008/03/24 APPROVED BY: APERANKITA 2008/03/24	GENERAL TOLERANCES (UNLESS SPECIFIED)	DIMENSION STYLE MM ONLY	SCALE 5:1	DESIGN UNITS METRIC	THIRD ANGLE PROJECTION
	10 UNDER ± 0.2	DRAWN BY K. HASHIMOTO	DATE '96/05/21	TITLE SPOX CRIMP RECEPTACLE	
	10 OVER 30 UNDER ± 0.25	CHECKED BY S. KUNISHI	DATE '98/07/07	MOLEX INCORPORATED	
	30 OVER ± 0.3	APPROVED BY M. FUKUSHIMA	DATE '98/07/07	MATERIAL NO. SEE TABLE	DOCUMENT NO. SD-5194-001
ANGULAR ± 3 °	DRAFT WHERE APPLICABLE MUST REMAIN WITHIN DIMENSIONS	SIZE A3	THIS DRAWING CONTAINS INFORMATION THAT IS PROPRIETARY TO MOLEX INCORPORATED AND SHOULD NOT BE USED WITHOUT WRITTEN PERMISSION		