

Excellent Integrated System Limited

Stocking Distributor

Click to view price, real time Inventory, Delivery & Lifecycle Information:

[E-Switch](#)
[TL1105JAF100Q](#)

For any questions, you can email us directly:

sales@integrated-circuit.com

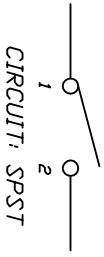
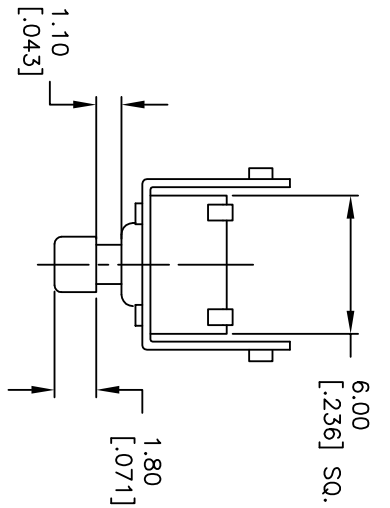
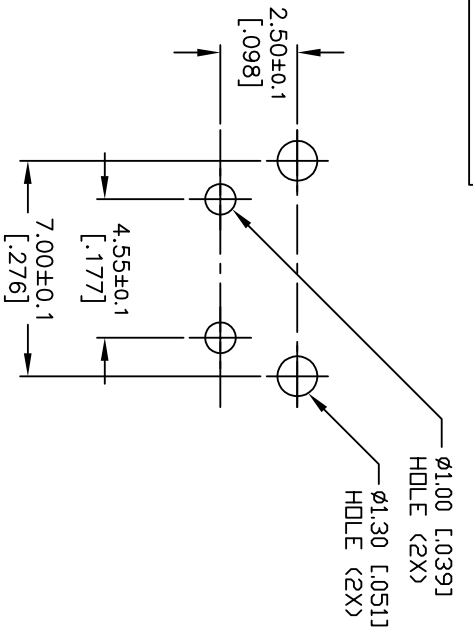

- NOTES:
1. ALL DIMENSIONS IN MM [INCH]
 2. GENERAL TOLERANCE: X.X=±0.25 X.XX=±0.25
 3. TERM. NOS. FOR REFERENCE ONLY.
 4. RATINGS: 12VDC, 50mA
 5. OPERATING FORCE: 100±50gf
 6. TRAVEL: 0.25±0.1mm
 7. CONTACT RESISTANCE: 100 Milli Ω Max.
 8. DIELECTRIC STRENGTH: 250V RMS min.
 9. INSULATION RESISTANCE: 100 Mega Ω min.
 10. ELECTRICAL LIFE: 100,000 CYCLES min.
 11. DESIGNATE MAJOR FEATURE:
 12. HOUSING COLOR: BLACK
 13. 2002/95/EC (ROHS) COMPLIANT

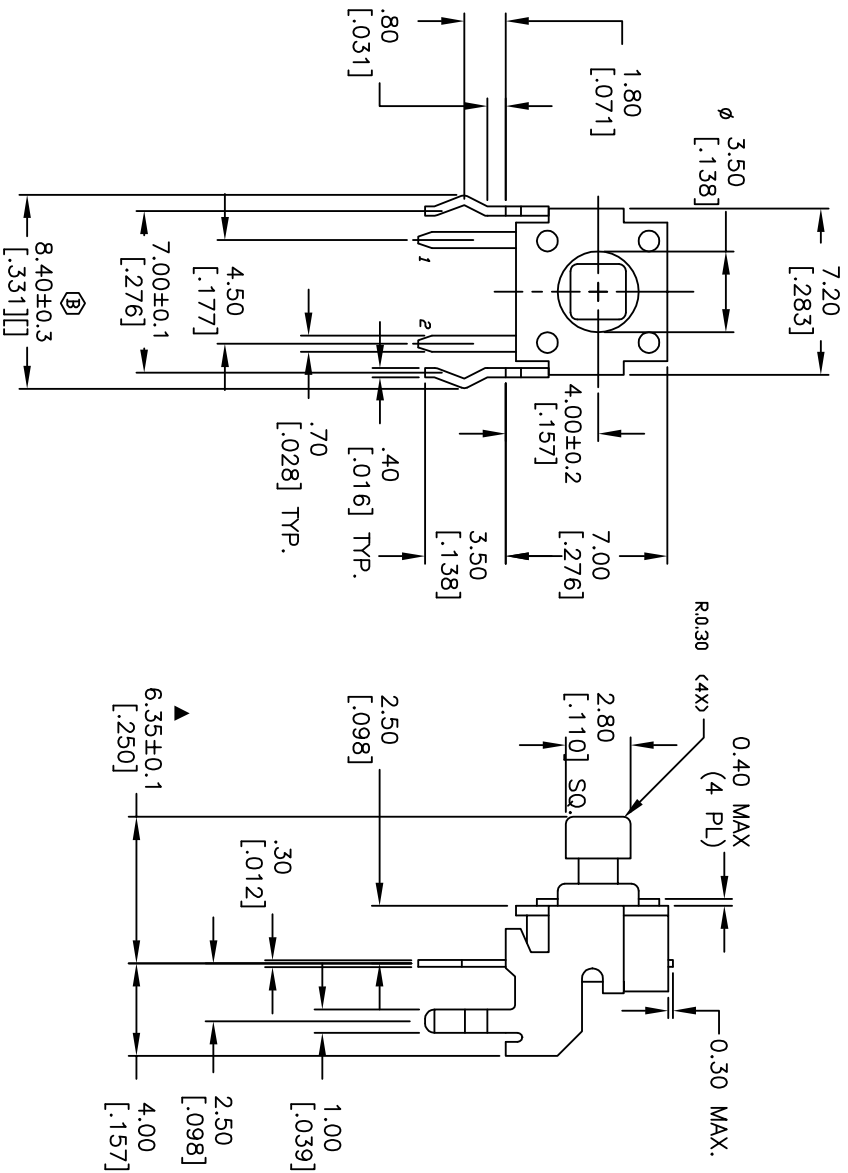

REV.	ECN No.	DESCRIPTION	DATE	CHKD	SCALE	DATE	DR	DWG	REV
B	18742	LEG TOLERANCE WAS +/- 0.1	1/11/10	BLR	3:1	1/11/10	BLR	P010209	B
A	12357	ADD NOTCH	9/23/02	CB					



TL1105JA F100 Q (STD BRACKET)

THE INFORMATION CONTAINED IN THIS DOCUMENT IS PROPRIETARY TO E-SWITCH AND IS NOT TO BE COPIED OR TRANSFERRED