

## Excellent Integrated System Limited

Stocking Distributor

Click to view price, real time Inventory, Delivery & Lifecycle Information:

[Bel Fuse Inc.](#)  
[25-7020](#)

For any questions, you can email us directly:  
[sales@integrated-circuit.com](mailto:sales@integrated-circuit.com)

5 4 3 2 1

D



Description: CPF59 1/2 F-59(M) Crimp, RG59  
 Part No: 25-7020  
 Application: For RG-59 cable  
 Crimp Tool: 24-9959P  
 Impedance: 75ohms  
 Frequency Range: 750 MHz  
 Material: Body Nickel plated  
 Sleeve Nickel plated  
 Nut Nickel plated  
 Yes  
 RoHS Compliance: N/A  
 Technical Detail: Refer to Emerson document P/N 25-0000

DRAWING NO.  
25-7020

REVISIONS

01	OFFICIAL RELEASE				<i>Betty</i>
	10-21-09				

D

C

C

受控 CONTROLLED DOCUMENT				
编号 P/N	25-7036-CUST	版本 Rev	01	日期 Rel'd Date
				DEC 17,09

B

B

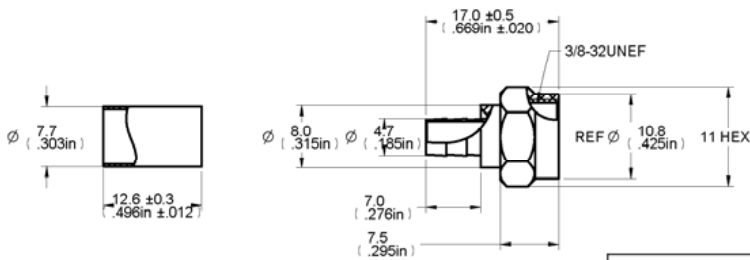

**DIM OUTLINE**

CUSTOMER COPY

A

A

TOLERANCE UNLESS OTHERWISE SPECIFIED	DRAWN BY	DATE
DECIMALS	LINDA.WU	10-21-09
X	CHECKED BY	DATE
± 0.5	LINDA.WU	10-21-09
X.X	APPROVED BY	DATE
± 0.3	THOMAS	10-21-09
X.XX		
± 0.1		
ANGLES	U/M	mm
± 0.5°		



TITLE  
CPF59 1/2 F-59(M) CRIMP, RG59

THIS DRAWING WAS PRODUCED BY COMPUTER.  
DO NOT SCALE DRAWING OR UPDATE MANUALLY.

SHEET	DRAWING NO.	SIZE
1 OF 1	25-7020	A

5 4 3 2 1