

## Excellent Integrated System Limited

Stocking Distributor

Click to view price, real time Inventory, Delivery & Lifecycle Information:

[Molex Connector Corporation](#)  
[0731160025](#)

For any questions, you can email us directly:

[sales@integrated-circuit.com](mailto:sales@integrated-circuit.com)

MATERIAL AND FINISHES:

U,FL (73118-0360) MATED HEIGHT: 2.5MM (.098)  
 HOUSING: PHOSPHOR BRONZE  
 FINISH: GOLD  
 CONTACT: PHOSPHOR BRONZE  
 FINISH: GOLD  
 INSULATOR: PBT  
 CABLE: 1.32 CABLE OR EQUIVALENT

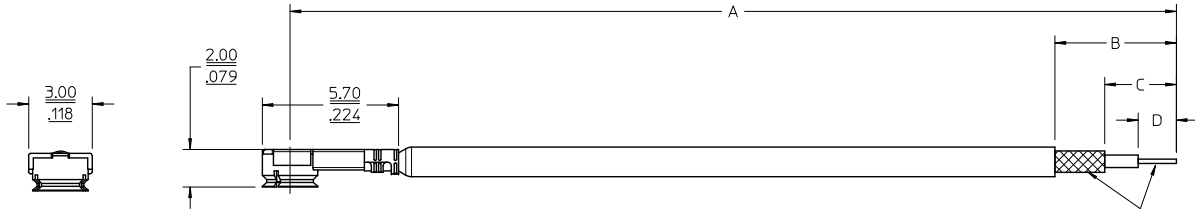

73116-0792	3.625±.125	92.07±3.17	BAG	YES	.335 / 8.50	.177 / 4.50	.079 / 2.00
73116-0791	7.966±.900	202.34±22.86	BAG	NO	.326 / 8.28	.193 / 4.90	.106 / 2.69
73116-0790	32.503±.900	825.58±22.86	BAG	NO	.256 / 6.49	.112 / 2.85	.059 / 1.50
73116-0029	12.503±.225	317.58±5.72	BAG	NO	.256 / 6.49	.112 / 2.85	.059 / 1.50
73116-0028	8.503±.180	215.98±4.57	BAG	NO	.256 / 6.49	.112 / 2.85	.059 / 1.50
73116-0027	12.000±.250	304.80±6.34	SINGLE	YES	.276 / 7.00	.157 / 4.00	.079 / 2.00
73116-0026	9.000±.250	228.60±6.34	SINGLE	YES	.276 / 7.00	.157 / 4.00	.079 / 2.00
73116-0025	6.000±.125	152.40±3.17	SINGLE	YES	.276 / 7.00	.157 / 4.00	.079 / 2.00
73116-0024	3.000±.125	76.20±3.17	SINGLE	YES	.276 / 7.00	.157 / 4.00	.079 / 2.00
73116-0023	12.000±.250	304.80±6.34	BAG	YES	.276 / 7.00	.157 / 4.00	.079 / 2.00
73116-0022	9.000±.250	228.60±6.34	BAG	YES	.276 / 7.00	.157 / 4.00	.079 / 2.00
73116-0021	6.000±.125	152.40±3.17	BAG	YES	.276 / 7.00	.157 / 4.00	.079 / 2.00
73116-0020	3.000±.125	76.20±3.17	BAG	YES	.276 / 7.00	.157 / 4.00	.079 / 2.00
PART NO.	IN	MM	PACKAGING	TINNED	IN / MM	IN / MM	IN / MM
	DIM A			YES / NO	DIM B	DIM C	DIM D

CHG: 1/PACKING UPDATE 2/TITLE UPDATE TO MCRF FROM UFL EWR RF15-E322 EC NO: URF2016-0202 DRAWN: YCHENG 2015/09/10 CHKD: APPR: YCHENG 2015/09/11 A5	QUALITY SYMBOLS ▽=0 ▽=0	GENERAL TOLERANCES (UNLESS SPECIFIED)		DIMENSION STYLE		SCALE	DESIGN UNITS	THIRD ANGLE PROJECTION	
		mm	INCH	MM/IN		METRIC			
		4 PLACES ±	±	DRAWN BY	DATE	TITLE			
		3 PLACES ±	±	JLEE02	2011/08/19	CA, MCRF TO PIGTAIL, 1.32MM CABLE, H25 CA-MCRF/PIGTAIL			
2 PLACES ±	±	CHECKED BY	DATE	APPROVED BY		DATE	MOLEX INCORPORATED		
1 PLACE ±	±	SSS	2011/08/19	JWIENER		2011/09/02	SD-73116-002		
ANGULAR ± 2°		MATERIAL NO.		DOCUMENT NO.		SHEET NO.			
DRAFT WHERE APPLICABLE MUST REMAIN WITHIN DIMENSIONS		SEE TABLE		SD-73116-002		1 OF 1			
THIS DRAWING CONTAINS INFORMATION THAT IS PROPRIETARY TO MOLEX INCORPORATED AND SHOULD NOT BE USED WITHOUT WRITTEN PERMISSION									