



Excellent Integrated System Limited

Stocking Distributor

Click to view price, real time Inventory, Delivery & Lifecycle Information:

[Essentra Components \(formerly Richco, Inc.\)](#)
[BF-1002](#)

For any questions, you can email us directly:
sales@integrated-circuit.com

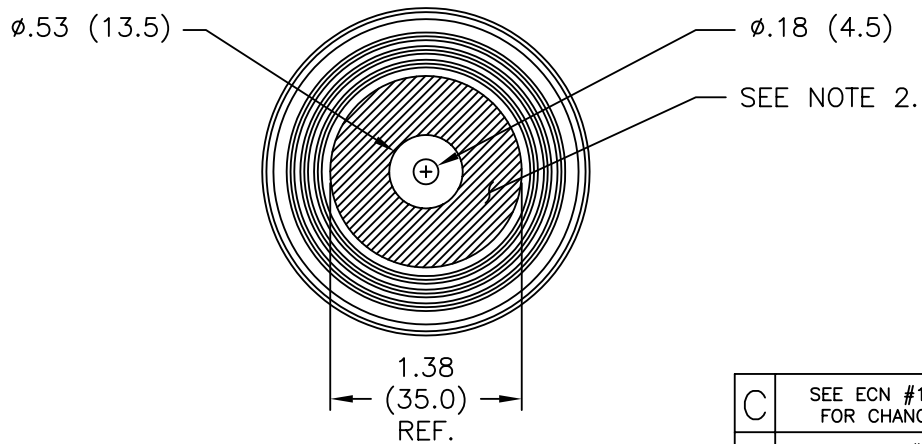
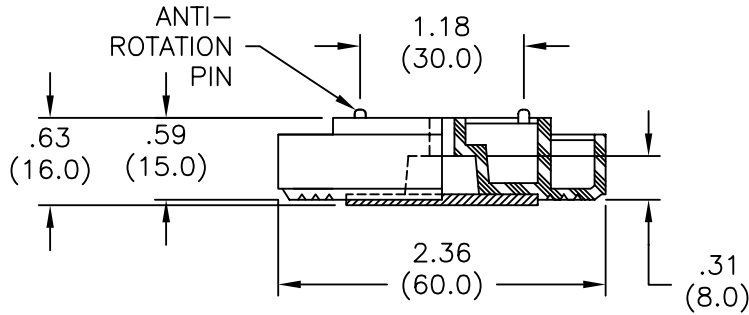
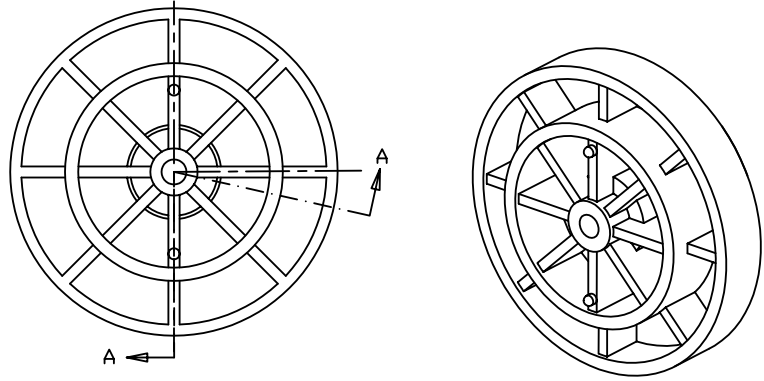

NOTES:

1. MATERIAL: ABS (RMS-114).
2. CUSHION MATERIAL: NYLON FIBER (RMS-240).
3. COLOR: BLACK.
4. RECOMMENDED MOUNTING SCREW
SIZE #8 (M4), PAN HEAD
(NOT FURNISHED).

C	SEE ECN #1125 FOR CHANGES	SK 01.25.06
B	SEE ECN #568 FOR CHANGES	SM 01.28.03
A	COMPLETELY REDRAWN; ADDED RMS-114 AND CHANGED FILE NO.	S.M. 05.31.01
REV	DESCRIPTION	ENGR DATE

TITLE: BIG FOOT-1002					
TOLERANCES UNLESS NOTED .XX=±.020 .XXX=±.015 FRAC=±1/64 ANG=±1°	FILE # BF-1002	DWN: S.M.	APP:	FINAL	
	MAT'L: SEE NOTES	DT: 05/31/01	DT:		
RE: RICHCO, INC.	RICHCO INC. PO BOX 804238, CHICAGO, 60680 (773) 539-4060		PART #	PRINT TYPE	CA
			BF-1002		