



Excellent Integrated System Limited

Stocking Distributor

Click to view price, real time Inventory, Delivery & Lifecycle Information:

[Essentra Components \(formerly Richco, Inc.\)](#)
[NE3](#)

For any questions, you can email us directly:

sales@integrated-circuit.com

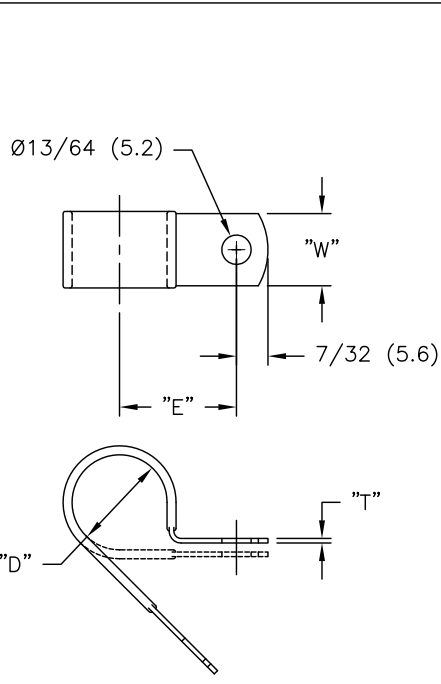

PART NO.	HOLDING DIA. "D"	"E" REF.	"T"	"W"
NE3	3/16 (4.8)	.50 (12.7)	1/32 (0.8)	3/8 (9.5)
NE4	1/4 (6.4)	.53 (13.5)		
NE5	5/16 (7.9)	.56 (14.2)		
NE6	3/8 (9.5)	.59 (15.0)		
NE7	7/16 (11.1)	.62 (15.7)		
NE8	1/2 (12.7)	.65 (16.5)		
NE9	9/16 (14.3)	.75 (19.1)	1/16 (1.6)	1/2 (12.7)
NE10	5/8 (15.9)	.78 (19.8)		
NE11	11/16 (17.5)	.81 (20.6)		
NE12	3/4 (19.1)	.84 (21.3)		
NE14	7/8 (22.2)	.90 (22.9)		
NE16	1 (25.4)	.96 (24.4)		
NE18	1-1/8 (28.6)	1.05 (26.7)		
NE20	1-1/4 (31.8)	1.11 (28.2)		

- NOTES:
- MAT'L: ALUMINUM ALLOY 5052 H-32 (RMS-199).
 - COATING: PVC (RMS-118), NOMINAL THICKNESS 1/32 (0.8).
 - COLOR: BLACK.

F UPDATED NOTE 2, PVC WAS TPV, CO 200534 DK 05.26.10		TITLE: CABLE CLAMPS, PVC COATED		DWG IN IN (MM) FINAL		PRINT TYPE CA	
E SEE CO 200385 FOR CHANGES SJ 07.14.09	TOLERANCES UNLESS NOTED	FILE # NE	DWN: P.B.	APP:	PART #		
D SEE CO 200143 FOR CHANGES SK 03.25.08	.XX=±.010	MAT'L: SEE NOTES	DT: 01-18-95	DT:	NE SERIES		
C SEE ECN #927 FOR CHANGES SK 01.31.05	.XXX=±.005	RE: RICHCO, INC.	RICHCO INC. PO BOX 804238, CHICAGO, 60680 (773) 539-4060				
B DRAWING UPDATED AND CHANGED FILE NO. SM 09.26.01	FRAC=±1/64						
A CONVERTED TO ACAD PB 01.18.95	ANG=±1°						
REV DESCRIPTION ENGR DATE							