



Excellent Integrated System Limited

Stocking Distributor

Click to view price, real time Inventory, Delivery & Lifecycle Information:

[Essentra Components \(formerly Richco, Inc.\)](#)
[NMS-412](#)

For any questions, you can email us directly:
sales@integrated-circuit.com

PART NO.	"A"	"B"	THREAD	"C"
NMS-306	.25 (6.4)	.10 (2.5)	M3	.22 (5.7)
NMS-308	.31 (8.0)			
NMS-310	.39 (10.0)			
NMS-312	.48 (12.1)			
NMS-406	.25 (6.3)	.11 (2.7)	M4	.29 (7.4)
NMS-408	.31 (8.0)			.30 (7.5)
NMS-410	.40 (10.2)			.29 (7.4)
NMS-412	.48 (12.2)			
NMS-416	.64 (16.2)			

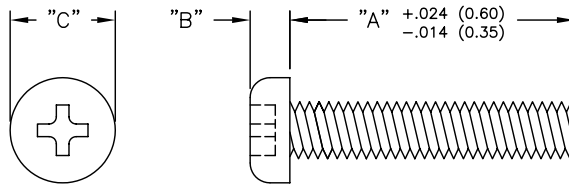

NOTES:

- MATERIAL: NYLON 6/6 (RMS-01).
- COLOR: NATURAL.

A		CHANGED FILE NO.	SM 08.16.02	TITLE: NYLON METRIC SCREWS		DWG IN IN (MM)		FINAL		PRINT TYPE	
REV		DESCRIPTION	ENGR DATE	TOLERANCES UNLESS NOTED .XX=±.010 .XXX=±.005 FRAC=±1/64 ANG=±1°	FILE # NMS	DWN: P.B.	APP:	PART #	SEE TABLE		CA
				MAT'L: SEE NOTES	RE: RICHCO, INC.	DT: 07-24-95	DT:	RICHCO INC. PO BOX 804238, CHICAGO, 60680 (773) 539-4060			