



Excellent Integrated System Limited

Stocking Distributor

Click to view price, real time Inventory, Delivery & Lifecycle Information:

[Visual Communications Company, LLC](#)
[7511A18](#)

For any questions, you can email us directly:

sales@integrated-circuit.com



REV	ECR NO./DESCRIPTION	DATE
A	11781 NEW RELEASE	06/16/95
B	12010 PAP SALES DRAWING	08/17/95

MOUNTING HOLE PATTERN
SCALE 4 : 1

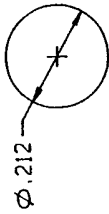

CHARMILLE # 24
SURFACE FINISH

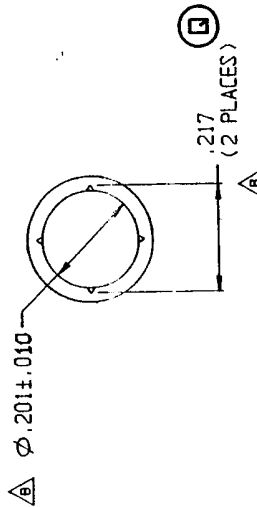
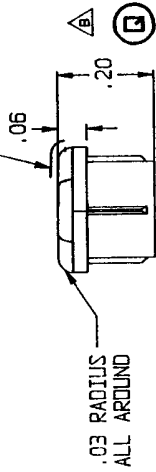
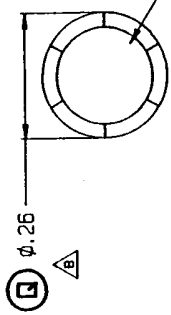

NOTES:

- LED TYPE TBD.
- MATERIAL: CLEAR POLYCARBONATE 94-V2.

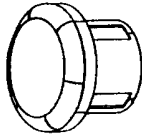

ISOMETRIC VIEW
FOR REFERENCE ONLY
SCALE 4 : 1

FOR INSPECTION USE ONLY
SPC DOCUMENTATION REQ. (X R CHARTS)

OCT 10 2000
DATE

LIGHTPIPE
FOR UNGERMAN-BASS

INDUSTRIAL DEVICES, INC.
MCKENZIE, NEW JERSEY

SCALE: 4 : 1

REV B
B12777

THIS DWG IS THE PROPERTY
OF INDUSTRIAL DEVICES, INC.
AND IS PROPRIETARY IN
GENERAL AND IN DETAIL.
IT SHALL NOT BE COPIED
OR ITS CONTENTS REVEALED
TO OUTSIDE PARTIES WITH-
OUT THE WRITTEN CONSENT
OF INDUSTRIAL DEVICES, INC.

DO NOT SCALE