

Excellent Integrated System Limited

Stocking Distributor

Click to view price, real time Inventory, Delivery & Lifecycle Information:

[Molex Connector Corporation](#)
[1300130273](#)

For any questions, you can email us directly:

sales@integrated-circuit.com

MATERIAL NUMBER	OLD PART NUMBER	FINISH LENGTH
130013-0273	1R3G04A20A120	1.0'±.75"-0 [.3M±19.1-0]

VOLTAGE RATING	600 VAC/VDC
AMPERAGE RATING	13A
PROJECTION	IP67
OPERATING TEMPERATURE	-20° C TO 105° C
UL CERTIFICATIONS	UL RECOGNIZED, FILE NO. E152210
CSA CERTIFICATIONS	CSA CERTIFIED, FILE NO. LR6837

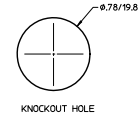
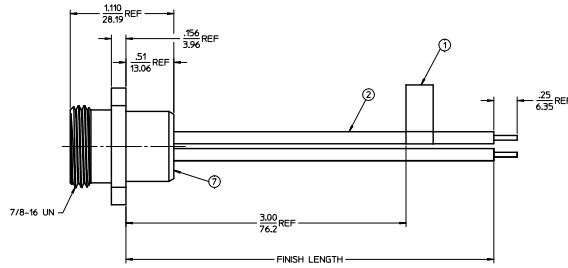
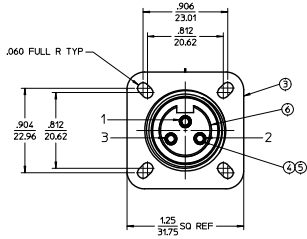
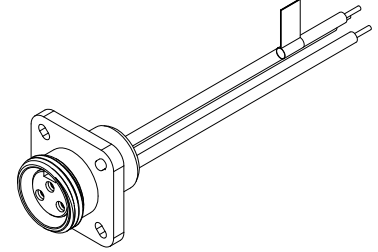

WIRING DIAGRAM

- 1 GREEN/YELLOW-GND
- 2 BLACK
- 3 WHITE

ITEM.	QTY.	COMPONENT	MATERIAL	FINISH
1	1	FLAG LABEL	PLASTIC FILM	BLACK/YELLOW
2	3	CONDUCTOR-16 AWG, 26X#30 COPPER STRANDING 600V	PVC	SEE WIRING DIAGRAM
3	1	RECEPTACLE SHELL	ALUMINUM	ANODIZED
4	3	SOCKET SLEEVE	STAINLESS STEEL	
5	3	CONTACT SOCKET	COPPER ALLOY	GOLD PLATED
6	1	3 POLE INSERT	PVC	YELLOW
7	1	POTTING	EPOXY	BLACK

QUALITY SYMBOLS	GENERAL TOLERANCES (UNLESS SPECIFIED)		DIMENSION STYLE		SCALE	DESIGN UNITS	THIRD ANGLE PROJECTION			
	mm	INCH	IN/MM	IN/MM						
4 PLACES	±.005	±.0005	DRAWN BY B. RUPERT 01/07/2010	DATE 01/07/2010	2:1	INCH	FEMALE FLANGED RECP. MINI-CHANGE 3P 16AWG PVC			
3 PLACES	±.005	CHECKED BY B. WOODMAN 01/07/2010						DATE 01/07/2010		
2 PLACES	±0.013								APPROVED BY J. MURPHY 2010/10/14	DATE 2010/10/14
1 PLACE	±.005									
	ANGULAR ±1/2°									
DRAFT WHERE APPLICABLE MUST REMAIN WITHIN DIMENSIONS										
SIZE D THIS DRAWING CONTAINS INFORMATION THAT IS PROPRIETARY TO MOLEX INCORPORATED AND SHOULD NOT BE USED WITHOUT WRITTEN PERMISSION										