

Excellent Integrated System Limited

Stocking Distributor

Click to view price, real time Inventory, Delivery & Lifecycle Information:

[Molex Connector Corporation](#)
[10-02-1057](#)

For any questions, you can email us directly:

sales@integrated-circuit.com

DWG. NO. SD-5279-NA
E
D
C
B
A
DIMENSIONS IN METRIC DO NOT SCALE DRAWING

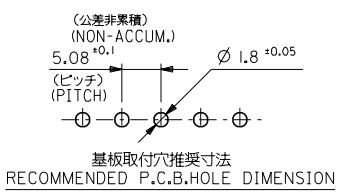
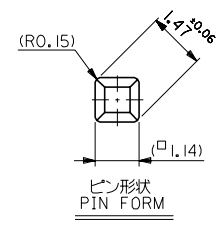
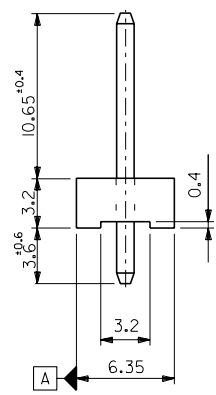
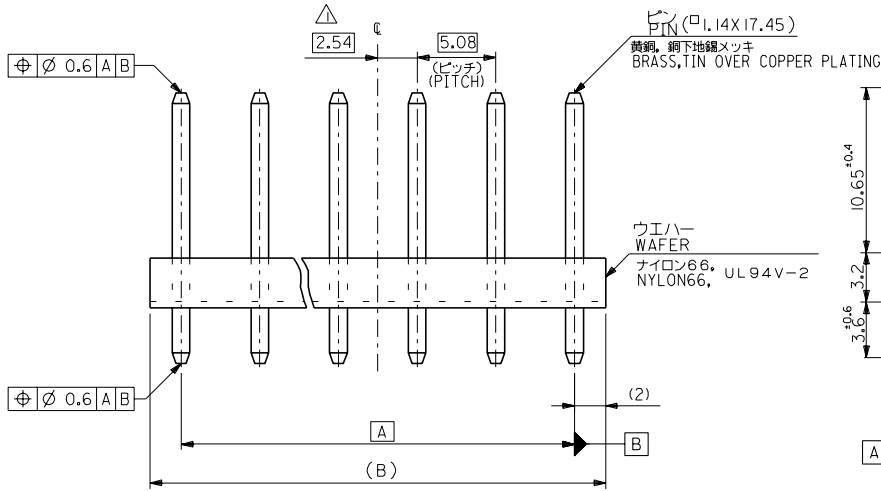

注記
NOTE

- △ 全極数が偶数の場合のみ適用。
TO BE APPLIED ONLY WHEN ALL CKTS. ARE EVEN.
- 2 ウエハーの反りは、長さ 25.4 に対して 0.2 最大。
CAMBER MUST BE 0.24 MAX. PER 25.4.

| | | | | |
|-------|-------|------------|----------|------------|
| 59.88 | 55.88 | 10-02-1127 | 5279-12A | 12 |
| 54.8 | 50.8 | -1117 | -11A | 11 |
| 49.72 | 45.72 | -1107 | -10A | 10 |
| 44.64 | 40.64 | -1097 | -09A | 9 |
| 39.56 | 35.56 | -1087 | -08A | 8 |
| 34.48 | 30.48 | -1077 | -07A | 7 |
| 29.4 | 25.4 | -1067 | -06A | 6 |
| 24.32 | 20.32 | -1057 | -05A | 5 |
| 19.24 | 15.24 | -1047 | -04A | 4 |
| 14.16 | 10.16 | -1037 | -03A | 3 |
| 9.08 | 5.08 | 10-02-1027 | 5279-02A | 2 |
| B | A | EDP NO. | ENG. NO. | 極数 CKT. |

| | | | | | |
|------------------------------|-------|-----------|--|------------------|------------|
| 角度 ANGLE | ±3° | | | | |
| 30 以上 OVER | ±0.3 | | | | |
| 10 以上 OVER 30 未満 UNDER | ±0.25 | | | | |
| 10 未満 UNDER | ±0.2 | A | 変更 & 再作図 (J40818) REVISED & REDRAWN | T.A. T.SAKAWA | 9/10/16 |
| 一般公差 GENERAL TOLERANCES | | 記号 LTR | 変更内容 REVISION RECORD | DR CHK | 日付 DATE |

| | | |
|----------------------------------|----------------------------------|--------------------------------------|
| 材料 MATERIAL | 図中参照 SEE DRAWING | MOLEX-JAPAN CO., LTD. 日本モレックス株式会社 |
| 仕上げ FINISH | — | |
| 適用電線範囲 WIRE RANGE | — | REVISE ONLY ON CAD SYSTEM |
| 被覆外径 INS. RANGE | — | KK 5.08 WAFER ASS'Y |
| DRAWN BY 9/10/16 T.SAKAWA | CHK'D BY 9/10/16 Y.M.HIRAMOTO | DWG. NO. |
| APPR'D BY 9/10/16 M.FUKUSHIMA | 尺度 SCALE | SD-5279-NA |
| | | REV A |

THIS DRAWING CONTAINS INFORMATION THAT IS PROPRIETARY TO MOLEX (JAPAN) AND SHOULD NOT BE USED WITHOUT WRITTEN PERMISSION
本図面は日本モレックス(株)の所有する情報を含むもので 当社の許可なく複製を禁止する。
EN-01C(032)MXJ-32