

Excellent Integrated System Limited

Stocking Distributor

Click to view price, real time Inventory, Delivery & Lifecycle Information:

[Molex Connector Corporation](#)
[0022011022](#)

For any questions, you can email us directly:

sales@integrated-circuit.com

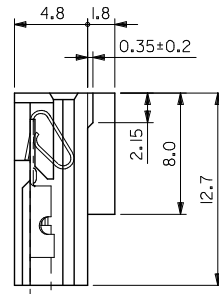
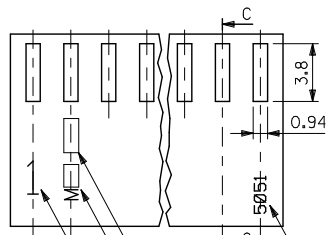
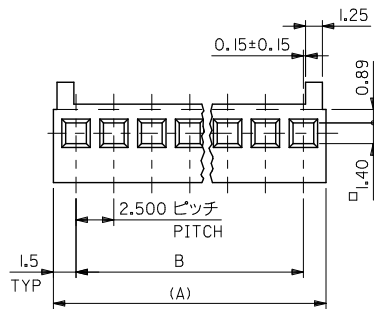

注) NOTE.

- そりは長さ25.4mmに対して0.2mmMAX. CAMBER MUST BE WITHIN 0.2 MAX. PER 25.4.
- () 寸法は参考値 DIMENSION SHOWN IN () ARE REFERENCE.
- サーキットNO. 1のみ表示 但し2極の場合はトレードマーク側が1となる WHEN 2 CIRCUITS HOUSING TRADE MARK SIDE IN NO.1 CIRCUIT.

CAV.NO. 型番
TRADE MARK ENG.NO.
サーキットNO. (注3参照)
CIRCUIT NO. (1 ONLY) SEE NOTE 3.

ターミナル#2759又は#5159
TERMINAL #2759 OR #5159

MT*L. NYLON 66(94V-0)

5051-16	22-01-1162	16	37.50±0.25	40.50
-15	-1152	15	35.00±0.20	38.00
-14	-1142	14	32.50±0.20	35.50
-13	-1132	13	30.00±0.20	33.00
-12	-1122	12	27.50±0.20	30.50
-11	-1112	11	25.00±0.15	28.00
-10	-1102	10	22.50±0.15	25.50
-09	-1092	9	20.00±0.15	23.00
-08	-1082	8	17.50±0.15	20.50
-07	-1072	7	15.00±0.15	18.00
-06	-1062	6	12.50±0.10	15.50
-05	-1052	5	10.00±0.10	13.00
-04	-1042	4	7.50±0.10	10.50
-03	-1032	3	5.00±0.10	8.00
5051-02	22-01-1022	2	2.50±0.08	5.50
MATERIAL NO.	PART NO.	極数 N	B	(A)
			MODEL NO. 5051-N	

REVISED EC NO. J2016-1107 DRAWN: SATO02 2016/04/20 CHK: KASAKAWA 2016/04/20 APPR: IKANEKO 2016/06/20	GENERAL TOLERANCES (UNLESS SPECIFIED)			DIMENSION STYLE		SCALE	DESIGN UNITS	THIRD ANGLE PROJECTION 2.50/(.098) CENTERS KK POLZG HSG molex DOCUMENT NO. SD-5051-001 SHEET NO. 1 OF 1
	0.25 UNDER	UNDER	±0.03	MM ONLY		4:1	METRIC	
	0.25 OVER	0.5 UNDER	±0.05	DRAWN BY DATE		TITLE		
	0.5 OVER	1.0 UNDER	±0.1	K. KOHAMA '00/3/28		2.50/(.098) CENTERS KK		
	1.0 OVER	10 UNDER	±0.25	CHECKED BY DATE		POLZG HSG		
10 OVER	30 UNDER	±0.3	T. YAMAGUCHI '00/3/30					
30 OVER		±0.35	APPROVED BY DATE					
ANGULAR	±3 °		M. FUKUSHIMA '00/3/30					
DRAFT WHERE APPLICABLE MUST REMAIN WITHIN DIMENSIONS			SIZE	SEE TABLE				
			A3	THIS DRAWING CONTAINS INFORMATION THAT IS PROPRIETARY TO MOLEX ELECTRONIC TECHNOLOGIES, LLC AND SHOULD NOT BE USED WITHOUT WRITTEN PERMISSION				