

Excellent Integrated System Limited

Stocking Distributor

Click to view price, real time Inventory, Delivery & Lifecycle Information:

[Molex Connector Corporation](#)

[22-04-1021](#)

For any questions, you can email us directly:

sales@integrated-circuit.com

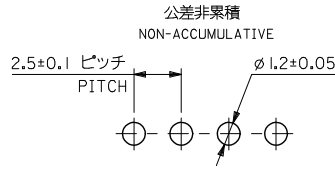
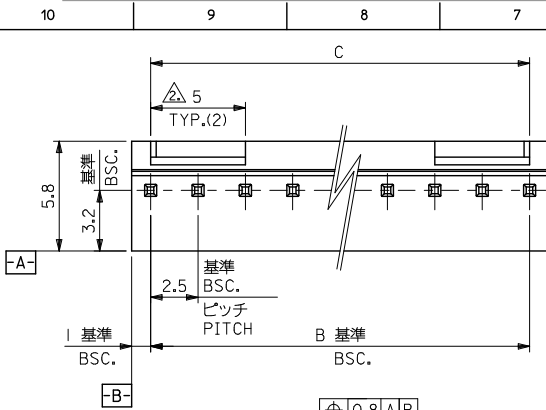

基板取付穴推奨寸法
RECOMMENDED P.C.BOARD HOLE DIM.

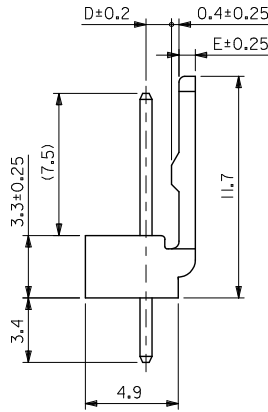
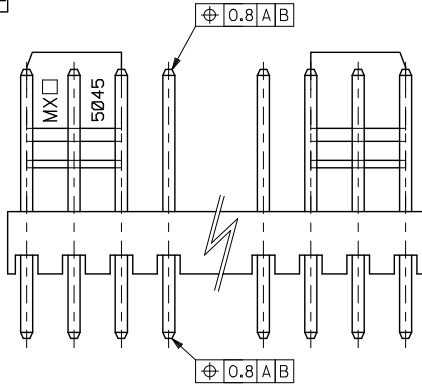

注) NOTE.

1. 材料

MATERIAL

ピン : 0.635x14.2 黄銅、銅下地銀メッキ
ウエハー: ポリアミド, UL94V-0
WAFFER: POLYAMIDE, UL94V-0

△ 6種以上に適用

TO BE APPLIED FOR 6 CKT. AND MORE THEN 6 CKT.

3. 5種以下はロック部スリットなし

NO SLIT IS PROVIDED FOR 5 CKT. AND LESS THAN 5 CKT.

4. ELV 及び RoHS 適合品

ELV AND RoHS COMPLIANT

| | | | | | |
|------|------|---------------------------------------|------|------------|---------|
| 1.35 | 0.85 | 47.5 ^{+0.1} _{-0.25} | 47.5 | 22 04 1201 | 20 |
| | | 45 ^{+0.1} _{-0.25} | 45 | 1191 | 19 |
| | | 42.5 ^{+0.1} _{-0.25} | 42.5 | 1181 | 18 |
| | | 40 ^{+0.1} _{-0.25} | 40 | 1171 | 17 |
| | | 37.5 ^{+0.1} _{-0.25} | 37.5 | 1161 | 16 |
| | | 35 ^{+0.1} _{-0.25} | 35 | 1151 | 15 |
| | | 32.5 ^{+0.1} _{-0.25} | 32.5 | 1141 | 14 |
| | | 30 ^{+0.1} _{-0.25} | 30 | 1131 | 13 |
| | | 27.5 ^{+0.1} _{-0.25} | 27.5 | 1121 | 12 |
| | | 25 ^{+0.1} _{-0.25} | 25 | 1111 | 11 |
| | | 22.5 ^{+0.1} _{-0.25} | 22.5 | 1101 | 10 |
| | | 20 ^{+0.1} _{-0.25} | 20 | 1091 | 9 |
| | | 17.5 ^{+0.1} _{-0.25} | 17.5 | 1081 | 8 |
| | | 15 ^{+0.1} _{-0.25} | 15 | 1071 | 7 |
| | | 12.5 ^{+0.1} _{-0.25} | 12.5 | 1061 | 6 |
| | | 10 ^{+0.1} _{-0.25} | 10 | 1051 | 5 |
| 1.35 | 0.85 | 7.5 ^{+0.1} _{-0.25} | 7.5 | 1041 | 4 |
| 1.2 | 1 | 5 ^{+0.1} _{-0.25} | 5 | 1031 | 3 |
| 1.2 | 1 | 2.5 ^{+0.1} _{-0.25} | 2.5 | 22 04 1021 | 2 |
| D | E | C | B | ORDER No. | 極数 CKT. |

| | | | | | | | |
|--|--|------------------|-------------------------|---|------------------------------|------------------------|--|
| REVISED EC NO. J2012-0973 DRAWN BY 2012/01/30 CHIKIDAKIKAWA APPROXIMATE 2013/06/13 | GENERAL TOLERANCES (UNLESS SPECIFIED) | | DIMENSION STYLE | SCALE | DESIGN UNITS | THIRD ANGLE PROJECTION | |
| | | | MM ONLY | 5:1 | METRIC | | |
| | DESCRIPTION | 10 UNDER | ±0.4 | DRAWN BY DATE | TITLE | | |
| | | 10 OVER 30 UNDER | ±0.45 | K. KOHAMA 2000/03/28 | KK 2.5 WAFER ASS'Y WITH LOCK | | |
| | 30 OVER | ±0.5 | CHECKED BY DATE | | | | |
| | | | T. YAMAGUCHI 2000/03/30 | | | | |
| | ANGULAR | ±3 ° | APPROVED BY DATE | | | | |
| | DRAFT WHERE APPLICABLE MUST REMAIN WITHIN DIMENSIONS | | MATERIAL NO. | DOCUMENT NO. | SHEET NO. | | |
| | | | SEE CHART | SD-5045-NA | 1 OF 1 | | |
| | | | SIZE A3 | THIS DRAWING CONTAINS INFORMATION THAT IS PROPRIETARY TO MOLEX INCORPORATED AND SHOULD NOT BE USED WITHOUT WRITTEN PERMISSION | | | |