

Excellent Integrated System Limited

Stocking Distributor

Click to view price, real time Inventory, Delivery & Lifecycle Information:

[Molex Connector Corporation](#)
[22-04-1071](#)

For any questions, you can email us directly:
sales@integrated-circuit.com

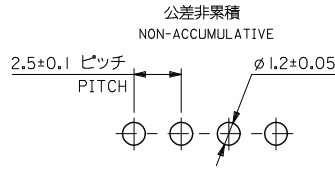
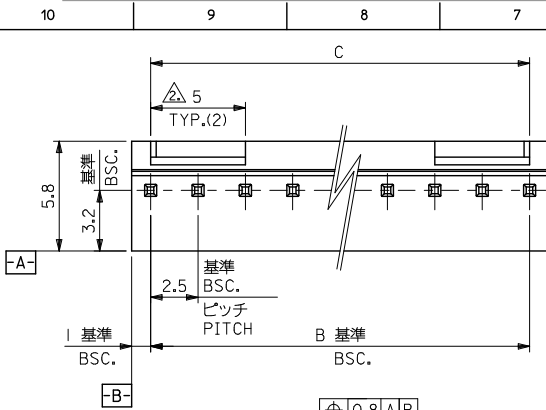

基板取付穴推奨寸法
RECOMMENDED P.C.BOARD HOLE DIM.

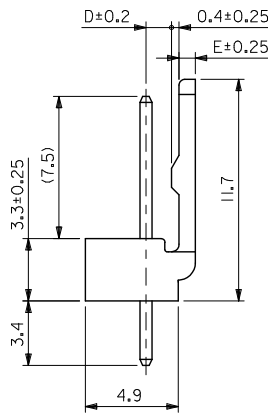
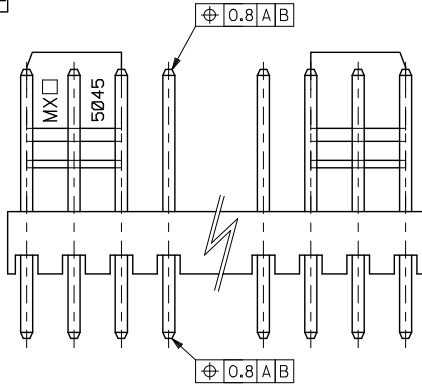

注) NOTE.

1. 材料

MATERIAL

ピン : 0.635x14.2 黄銅、銅下地銀メッキ
ウエハー: ポリアミド, UL94V-0
WAFFER: POLYAMIDE, UL94V-0

△ 6種以上に適用

TO BE APPLIED FOR 6 CKT. AND MORE THEN 6 CKT.

3. 5種以下はロック部スリットなし

NO SLIT IS PROVIDED FOR 5 CKT. AND LESS THAN 5 CKT.

4. ELV 及び RoHS 適合品

ELV AND RoHS COMPLIANT

1.35	0.85	47.5 ^{+0.1} _{-0.25}	47.5	22 04 1201	20
		45 ^{+0.1} _{-0.25}	45	1191	19
		42.5 ^{+0.1} _{-0.25}	42.5	1181	18
		40 ^{+0.1} _{-0.25}	40	1171	17
		37.5 ^{+0.1} _{-0.25}	37.5	1161	16
		35 ^{+0.1} _{-0.25}	35	1151	15
		32.5 ^{+0.1} _{-0.25}	32.5	1141	14
		30 ^{+0.1} _{-0.25}	30	1131	13
		27.5 ^{+0.1} _{-0.25}	27.5	1121	12
		25 ^{+0.1} _{-0.25}	25	1111	11
		22.5 ^{+0.1} _{-0.25}	22.5	1101	10
		20 ^{+0.1} _{-0.25}	20	1091	9
		17.5 ^{+0.1} _{-0.25}	17.5	1081	8
		15 ^{+0.1} _{-0.25}	15	1071	7
		12.5 ^{+0.1} _{-0.25}	12.5	1061	6
		10 ^{+0.1} _{-0.25}	10	1051	5
1.35	0.85	7.5 ^{+0.1} _{-0.25}	7.5	1041	4
1.2	1	5 ^{+0.1} _{-0.25}	5	1031	3
1.2	1	2.5 ^{+0.1} _{-0.25}	2.5	22 04 1021	2
D	E	C	B	ORDER No.	極数 CKT.

REVISED EC NO. J2012-0973 DRAWN BY 2012/01/30 CHKD BY CHIKIDAKAWA 2012/01/30 APPR. BY KITTA 2013/06/13	GENERAL TOLERANCES (UNLESS SPECIFIED)		DIMENSION STYLE	SCALE	DESIGN UNITS	THIRD ANGLE PROJECTION
			MM ONLY	5:1	METRIC	
	DESCRIPTION	10 UNDER ±0.4	DRAWN BY DATE	TITLE KK 2.5 WAFER ASS'Y WITH LOCK		
		10 OVER 30 UNDER ±0.45	K. KOHAMA 2000/03/28			
	30 OVER ±0.5	CHECKED BY DATE	DOCUMENT NO. SD-5045-NA			
	ANGULAR ±3 °	T. YAMAGUCHI 2000/03/30				
REV	DRAFT WHERE APPLICABLE MUST REMAIN WITHIN DIMENSIONS		MATERIAL NO.	SHEET NO. 1 OF 1		
			SEE CHART	THIS DRAWING CONTAINS INFORMATION THAT IS PROPRIETARY TO MOLEX INCORPORATED AND SHOULD NOT BE USED WITHOUT WRITTEN PERMISSION		