

Excellent Integrated System Limited

Stocking Distributor

Click to view price, real time Inventory, Delivery & Lifecycle Information:

[Molex Connector Corporation](#)

[39-27-0034](#)

For any questions, you can email us directly:

sales@integrated-circuit.com

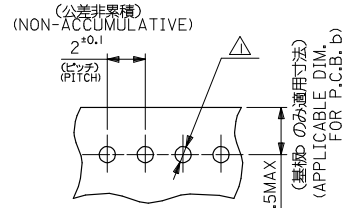
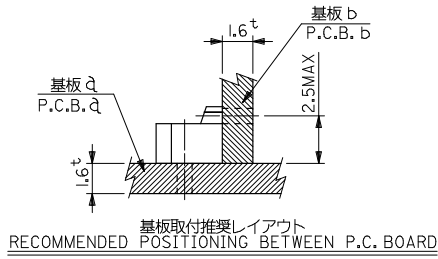
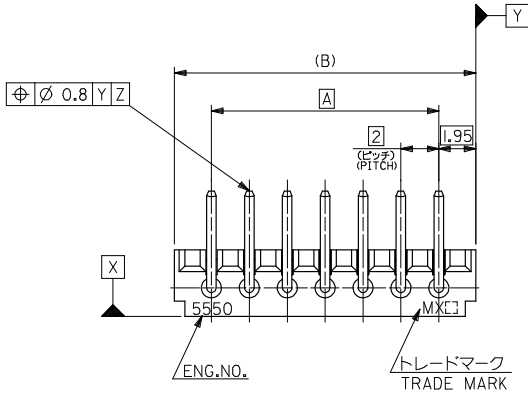

基板取付穴推奨寸法
RECOMMENDED P.C. BOARD HOLE DIM.

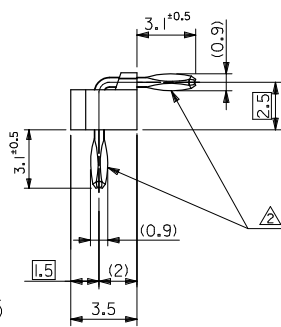
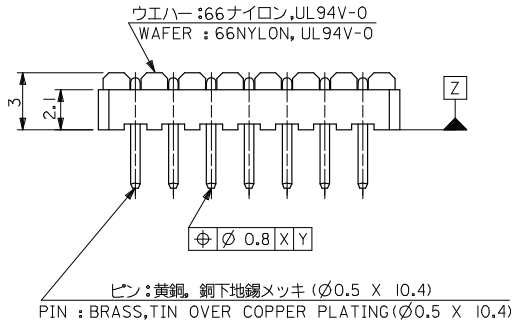

注記:
NOTES:

- △ 3種 ~ 12種: $\varnothing 0.8^{+0.05}$
- 3CKTS ~ 12CKTS: $\varnothing 0.8^{+0.05}$
- 13種 ~ 20種: $\varnothing 0.85^{+0.05}$
- 13CKTS ~ 20CKTS: $\varnothing 0.85^{+0.05}$
- △ キンクは 全ピン交互に設ける。
SET KINK ALTERNATELY TO ALL CIRCUITS.

35.9	32	39-27-0174	5550-17A	17
29.9	26	39-27-0144	5550-14A	14
19.9	10	39-27-0064	5550-06A	6
7.9	4	39-27-0034	5550-03A	3
(B)	A	EDP NO.	ENG.NO.	種別 CKT.

ピン: 黄銅, 銅下地鍍メッキ ($\varnothing 0.5 \times 10.4$)
PIN: BRASS, TIN OVER COPPER PLATING ($\varnothing 0.5 \times 10.4$)

REVISED EC NO.: J2008-3104 DRAWN BY: MURAKAWA CHECKED BY: HARUYAMA APPROVED BY: HARUYAMA	DESCRIPTION	GENERAL TOLERANCES (UNLESS SPECIFIED)		DIMENSION STYLE MM ONLY		SCALE 5:1	DESIGN UNITS METRIC	THIRD ANGLE PROJECTION	
		10 UNDER	± 0.2	DRAWN BY S. MATSUZAKI	DATE '95/9/16	TITLE 2.0 B/B DIP			
		10 OVER 30 UNDER	± 0.25	CHECKED BY Y. M	DATE '95/9/16	APPROVED BY M. FUKUSHIMA			
		30 OVER	± 0.3	APPROVED BY M. FUKUSHIMA		DATE '95/9/16	MOLEX INCORPORATED		SHEET NO. 1 OF 1
B	REV	ANGULAR	± 3 °	MATERIAL NO.		DOCUMENT NO.	THIS DRAWING CONTAINS INFORMATION THAT IS PROPRIETARY TO MOLEX INCORPORATED AND SHOULD NOT BE USED WITHOUT WRITTEN PERMISSION		
		DRAFT WHERE APPLICABLE MUST REMAIN WITHIN DIMENSIONS		SIZE A 3					