

Excellent Integrated System Limited

Stocking Distributor

Click to view price, real time Inventory, Delivery & Lifecycle Information:

[Molex Connector Corporation](#)
[43512-0001](#)

For any questions, you can email us directly:

sales@integrated-circuit.com

NOTES:

1. MATERIAL: POLYESTER (PBT), UN-FILLED, UL 94V-0. COLOR: BLACK
2. FINISH: NONE
3. PRODUCT SPEC.: PS-43510-002
4. ALL DIMENSIONS SHOWN FOR REFERENCE ONLY.
5. USES STANDARD 43030 MICRO-FIT FEMALE CRIMP TERMINALS.
7. PART MATES WITH 43515-0001 PLUG POD.
8. PART TO BE USED WITH 43618-0*** RECEPTACLE SHROUD. (SEE SHROUD DRAWING FOR ASSEMBLY INFORMATION)

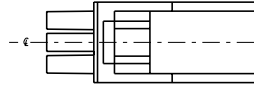
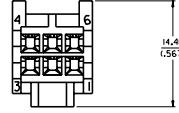
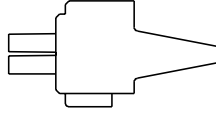
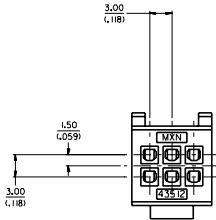
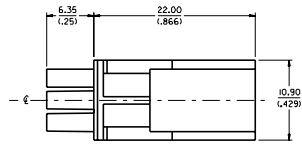

MOVED LETTERING IC AND/OR PCB 9903/5 COMMERCIAL 9903/5 COMMERCIAL 9903/5	QUALITY SYMBOLS VALUER CRITICAL 4/0	GENERAL TOLERANCES: UNLESS SPECIFIED: DIM INCH 4 PLACES +0,--- ±,--- 3 PLACES +0,--- ±,--- 2 PLACES +0,--- ±,--- 1 PLACE +0,--- ±,--- ANGULAR: # 0	SCALE: 4:1 DESIGN UNITS: DIM INCH DRAWN BY & DATE: COMERC1 97/10/06 CHECKED BY & DATE: COMERC1 97/10/06 APPROVED BY & DATE: FRY 97/10/10 CAD FILENAME: S4351201.DGN MATERIAL NO.: 43512-0001 DRAWING NO.: SD-43512-001	DIMENSIONS: THIRD ANGLE PROJECTION DIM INCH DIM METER ONLY TITLE: MICRO-FIT RECEPTACLE 6 CIRCUIT, DUAL ROW COMPODRE SYSTEM MOLEX INCORPORATED	SHT REV REVISE ON CAD ONLY
	DRAFT WHERE APPLICABLE MUST REMAIN WITHIN DIMENSIONS	THIS DRAWING CONTAINS INFORMATION THAT IS PROPRIETARY TO MOLEX INCORPORATED AND SHOULD NOT BE USED WITHOUT WRITTEN PERMISSION.	SHEET NO. 1 OF 1 SIZE D		