



Excellent Integrated System Limited

Stocking Distributor

Click to view price, real time Inventory, Delivery & Lifecycle Information:

[Essentra Components \(formerly Richco, Inc.\)](#)
[SRL1-5-WH6A](#)

For any questions, you can email us directly:
sales@integrated-circuit.com

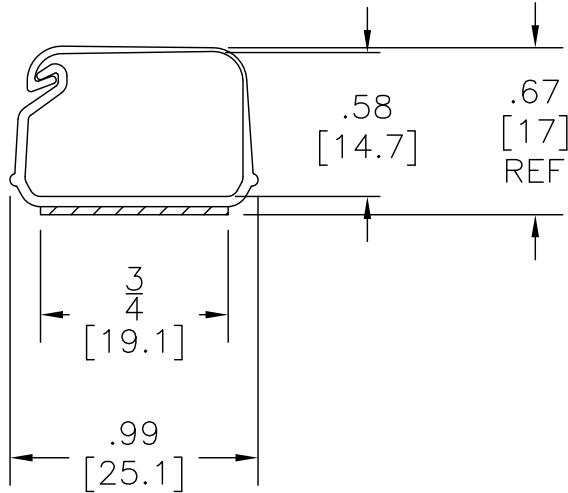

NOTES:

1. MATERIAL: RIGID PVC (RMS-04)
2. COLOR: WHITE
3. TAPE: 3/4 x 1/32 ACRYLIC ADHESIVE (RMS-15)
4. WALL THICKNESS: .040±007 [1mm] TYPICAL
5. LENGTH: 72±.25 [1829mm]

G	SEE CO 200280 FOR CHANGES	SK 11.12.08	TITLE: SURFACE RACEWAY L5				DWG IN IN.[MM]	
F	SEE CO 200204 FOR CHANGES	SK 06.25.08					FINAL	
E	METRIC EQUIVALENTS CORRECTED (ECN #461)	SM 09.20.02	TOLERANCES UNLESS NOTED	FILE # SRL-5	DWN: DLC	DT: 10/4/01		
D	PRINT CORRECTED - .58 WAS .29	SJ 9.10.02	.XX=±.02	MAT'L: SEE NOTES:	CHKD:	ENG:	PART #	PRINT TYPE
C	TAPE WIDTH WAS 3/8 IN "NOTES"	SJ 5.6.02	.XXX=±.015	RE: RICHCO,INC	RICHCO INC.		SRL1-5-WH6A	CA
B	ALL DIMENSIONS CORRECTED TO 1:1	SJ 4.30.02	FRAC=±1/32		ENG@RICHCO-INC.COM			
A	CHANGED .375 TO 3/8	DLC 3.07.02	ANG=1°		(773) 539-4060			
REV	DESCRIPTION	ENGR DATE						