

Excellent Integrated System Limited

Stocking Distributor

Click to view price, real time Inventory, Delivery & Lifecycle Information:

[Molex Connector Corporation](#)
[0934070508](#)

For any questions, you can email us directly:

sales@integrated-circuit.com

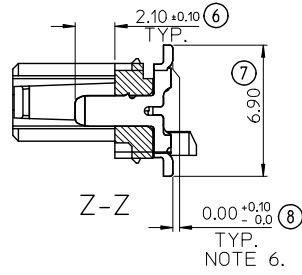
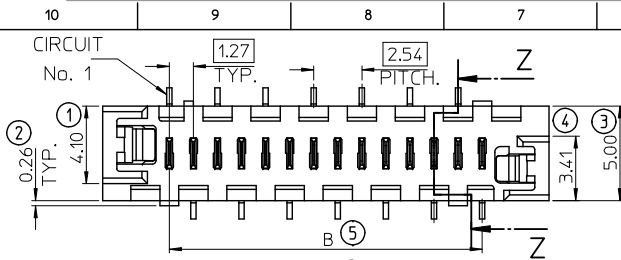

PART NO.	NUMBER OF CKTS	DIMN. A	DIMN. B	DIMN. C	DIMN. D	
93407-**04	4	10.86	3.81	6.11	7.66	NOTE 7
93407-**06	6	13.40	6.35	8.65	10.20	
93407-**08	8	15.94	8.89	11.19	12.74	
93407-**10	10	18.48	11.43	13.73	15.28	
93407-**12	12	21.02	13.97	16.27	17.82	
93407-**14	14	23.56	16.51	18.81	20.36	
93407-**16	16	26.10	19.05	21.35	22.90	
93407-**18	18	28.64	21.59	23.89	25.44	
93407-**20	20	31.18	24.13	26.43	27.98	
93407-**22	22	33.72	26.67	28.97	30.52	
93407-**24	24	36.26	29.21	31.51	33.06	
93407-**26	26	38.80	31.75	34.05	35.60	

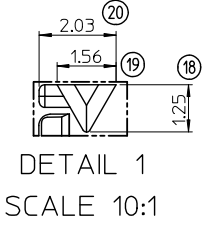
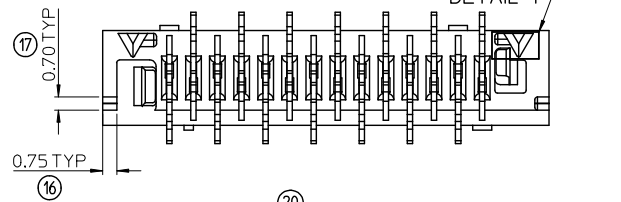
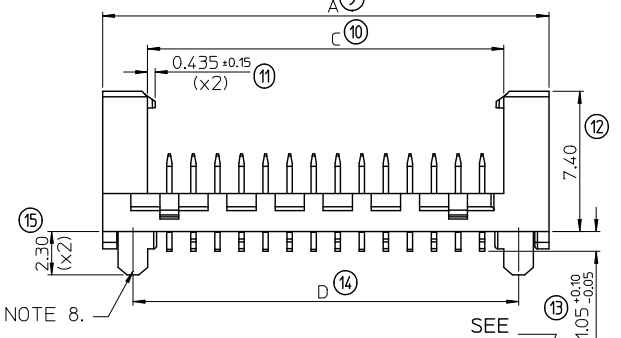

NOTES:

- MATERIAL HOUSING: PPA, GLASS-FILLED, COLOUR: BLACK, UL 94-HB TERMINAL: BRASS
 - FINISHES: TERMINAL PALLADIUM NICKEL (PdNi): CONTACT AREA: SELECTIVE PdNi: 0.6 MICROMETRE MINIMUM UNDER 0.05 MICROMETRE MINIMUM GOLD FLASH. SMT TAILS: TIN (Sn): 3 MICROMETRE MIN. ALL OVER NICKEL UNDERPLATE. TIN: 3 MICROMETRE MINIMUM OVER NICKEL UNDERPLATE.
 - PRODUCT SPECIFICATION: PS-99020-0011
 - PACKAGING SPECIFICATION: FOR TAPE AND REEL SEE: PK-90816-006 FOR TUBE SEE: PK-90816-007
 - MATES WITH MOLEX 90327 PART SERIES.
 - ALL SMT TAILS TO LIE WITHIN A COPLANARITY BAND OF 0 - 0.10 MICROMETRE REF. FROM EACH OTHER.
 - 4 CIRCUIT PART NOT AVAILABLE IN TAPE AND REEL.
 - PCB PEGS ARE OPTIONAL.
- LAST INSPECTION NUMBER USED: 20

93407 - * * * *
CIRCUIT SIZE.

	PCB PEGS	TUBE PACKED	TAPE & REEL PACKED
0	YES	YES	NO
2	YES	NO	YES
3	NO	YES	NO
5	NO	NO	YES

0 = TIN VERSION
3 = PALLADIUM NICKEL VERSION

MODIFIED PCB DIMS EC NO: IFG2013-0901 DRAWN BY: DBYRNES 2013/01/18 CHECKED BY: CHYKORMAHER 2013/01/22 APPR: STGRIFFIN 2013/01/23	QUALITY SYMBOLS ▽=0 ▽=0	GENERAL TOLERANCES (UNLESS SPECIFIED)		DIMENSION STYLE MM ONLY		SCALE 5:1	DESIGN UNITS METRIC	THIRD ANGLE PROJECTION	
		4 PLACES ± --- ± --- 3 PLACES ± --- ± --- 2 PLACES ± 0.25 ± --- 1 PLACE ± 0.35 ± --- 0 PLACE ± --- ± ---	mm INCH ± --- ± --- ± --- ± --- ± --- ± --- ± --- ± ---	DRAWN BY DBYRNES DATE 2012/05/29	CHECKED BY DSHEA DATE 2012/06/22	APPROVED BY EFOLAN DATE 2012/06/27	MATERIAL NO. SEE CHART	DOCUMENT NO. SD-93407-001	TITLE REVERSE FOOTPRINT LATCHED PICO FLEX SMT HEADER

THIS DRAWING CONTAINS INFORMATION THAT IS PROPRIETARY TO MOLEX INCORPORATED AND SHOULD NOT BE USED WITHOUT WRITTEN PERMISSION

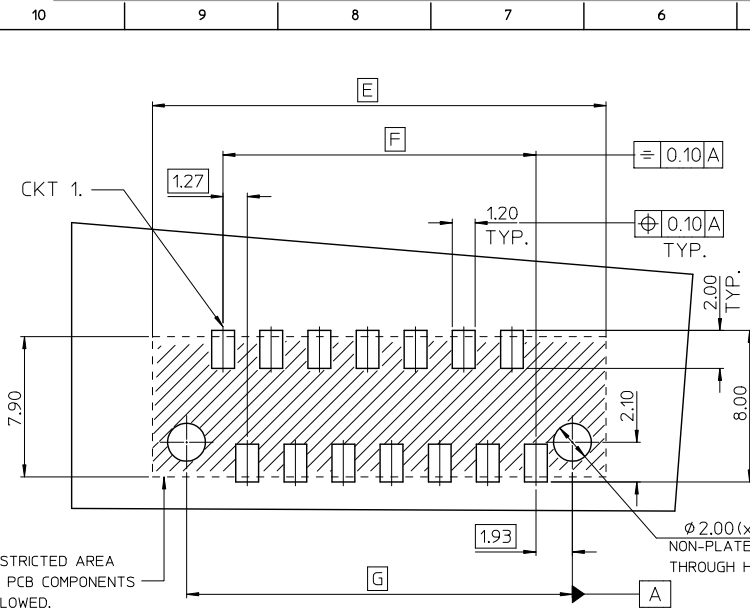

RECOMMENED PCB THICKNESS 1.60±0.14
PCB LAYOUT FOR CLEARANCE FIT WITH PCB PEGS
VIEW FROM COMPONENT SIDE

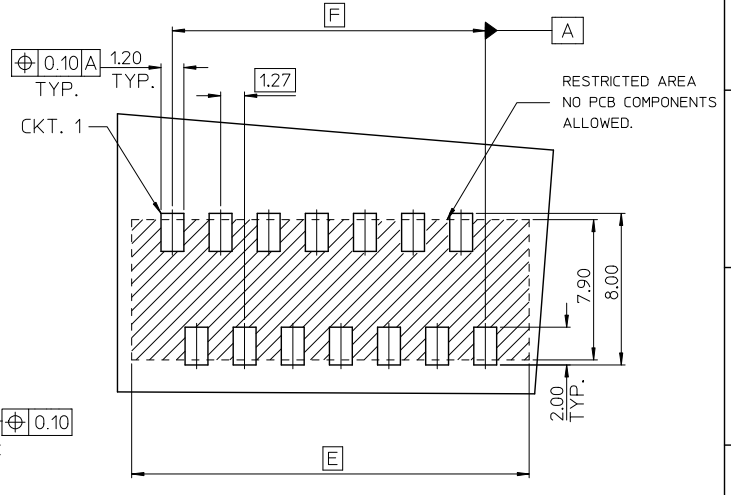

PCB LAYOUT WITHOUT PCB PEGS
VIEW FROM COMPONENT SIDE

93407-**-26	26	38.80	31.75	35.60
93407-**-24	24	36.26	29.21	33.06
93407-**-22	22	33.72	26.67	30.52
93407-**-20	20	31.18	24.13	27.98
93407-**-18	18	28.64	21.59	25.44
93407-**-16	16	16.10	19.05	22.90
93407-**-14	14	23.56	16.51	20.36
93407-**-12	12	21.02	13.97	17.82
93407-**-10	10	18.48	11.43	15.28
93407-**-08	08	15.94	08.89	12.74
93407-**-06	06	13.40	06.35	10.20
93407-**-04	04	10.86	03.81	07.66
PART No.	CKT SIZE	DIM. E	DIM. F	DIM. G

REFERENCE DIMENSIONS ONLY

REV	DESCRIPTION	QUALITY SYMBOLS	GENERAL TOLERANCES (UNLESS SPECIFIED)		DIMENSION STYLE		SCALE	DESIGN UNITS	THIRD ANGLE PROJECTION
			mm	INCH	MM ONLY	DATE			
0	4 PLACES	▽=0	±---	±---	DRAWN BY	DATE	5:1	METRIC	REVERSE FOOTPRINT LATCHED PICO FLEX SMT HEADER
1	3 PLACES	▽=0	±---	±---	CHECKED BY	DATE			
2	2 PLACES		±0.25	±---	APPROVED BY	DATE			molex DOCUMENT NO. SD-93407-001 SHEET NO. 2 OF 2
3	1 PLACE		±0.35	±---	MATERIAL NO.				
4	0 PLACE		±---	±---	SEE SHEET 1				
			ANGULAR ± 2°		DRAFT WHERE APPLICABLE MUST REMAIN WITHIN DIMENSIONS				
THIS DRAWING CONTAINS INFORMATION THAT IS PROPRIETARY TO MOLEX INCORPORATED AND SHOULD NOT BE USED WITHOUT WRITTEN PERMISSION									