

Excellent Integrated System Limited

Stocking Distributor

Click to view price, real time Inventory, Delivery & Lifecycle Information:

For any questions, you can email us directly:

sales@integrated-circuit.com

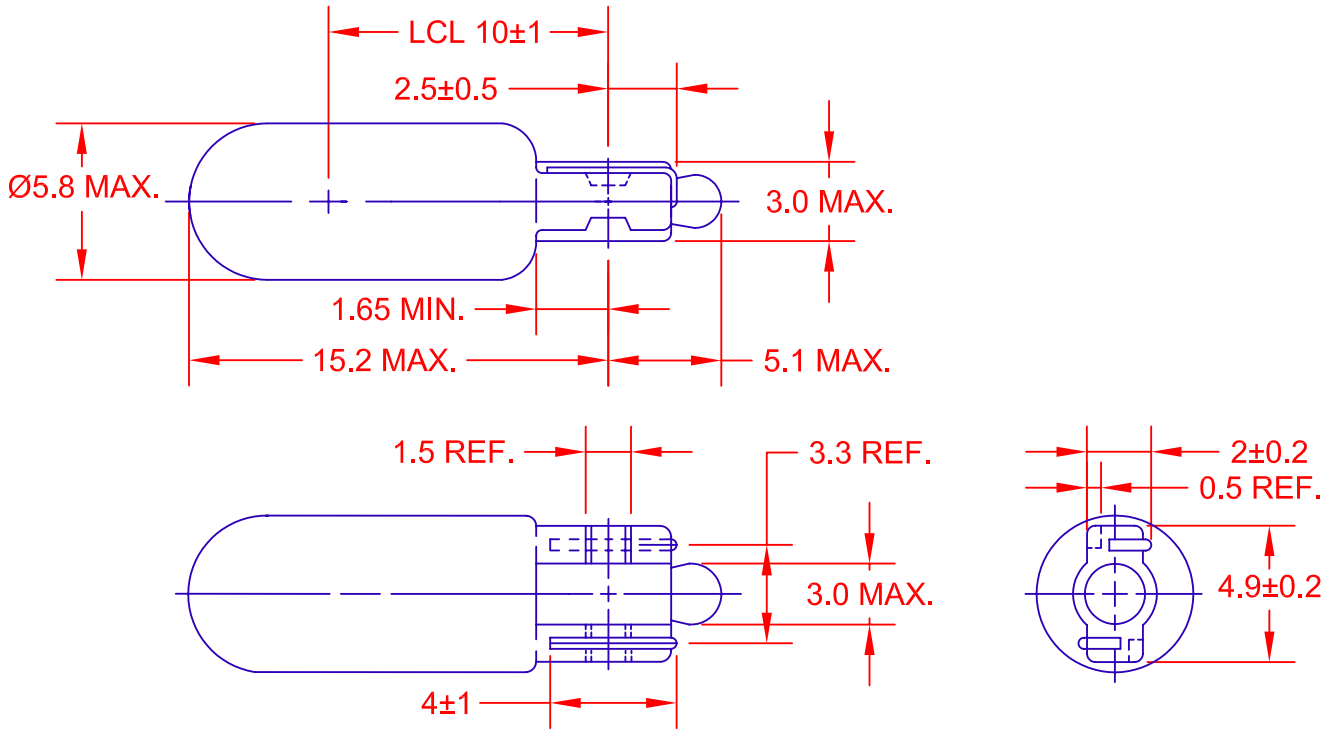

JKL LAMP NUMBER	VOLTS RATED	AMPS ±10%	MSCP ±25%	LUMENS ±25%	AVERAGE LIFE HRS.	FILAMENT TYPE
11	2.5	.200	.200	2.51	500	C-2R
56	5.0	.115	.150	1.89	40,000	C-2R
79	6.0	.200	.630	7.92	1,000	C-2R
86	6.3	.200	.400	5.03	50,000	C-2F
18*	14.0	.040	.130	1.63	5,000	C-2F
73*	14.0	.080	.300	3.77	15,000	C-2F
37	14.0	.090	.500	6.29	2,500	C-2F
74	14.0	.100	.700	8.80	500	C-2F
85	28.0	.040	.300	3.77	25,000	C-2F
17	28.0	.065	.650	8.17	5,000	C-2F

*LAMP LEAD (Pb) FREE

CONTACT JKL FOR LEAD (Pb) FREE LOT IDENTIFICATION.

<p>METRIC</p> <p>THIRD ANGLE PROJECTION</p>		<p>DIMENSIONS ARE IN MILLIMETERS</p> <p>TOLERANCE UNLESS OTHERWISE SPECIFIED</p> <p>1 PL +/- 0.2</p> <p>2 PL +/- 0.20</p> <p>ANGLE +/- 0</p>		<p>JKL COMPONENTS CORPORATION</p>							
				<p>TITLE</p> <p>T-1 3/4 STANDARD GLASS WEDGE BASE</p>							
<p>REV. NO.</p>	<p>DESCRIPTION/ECO NUMBER</p>	<p>DATE</p>	<p>DRAWN BY</p>	<p>APPV'D BY</p>	<p>DATE</p>	<p>SIZE</p>	<p>FSCM NO.</p>	<p>DRAWING NO.</p>	<p>TITLE</p>		
B	CHANGE #18 TO LEAD (Pb) FREE	7/12/05	L. WENGSTROM	J.K.	7/12/05	A	55335		GLASS WEDGE BASE T-1 3/4		
A	NOTE #73 TO LEAD (Pb) FREE	2/17/05									
	RELEASED & CANCEL GW-STD-T1 3/4, 75X & 84	5/11/00									
			<p>- CAD DRAWING -</p> <p>MANUAL REVISIONS NOT PERMITTED</p>				<p>SCALE</p>	<p>RELEASED DATE</p>	<p>REVISION DATE</p>	<p>REV. NO.</p>	<p>SHEET</p>
							NONE	5/11/00	7/12/05	B	1 OF 1